



U.S. Department
of Transportation
**Federal Aviation
Administration**

Alaskan Region Airports Division

222 W. 7th Avenue, #14
Anchorage, Alaska 99513-7587
Tel. (907) 271-5438 / Fax (907) 271-2851

October 24, 2017

Jourde Mitchell
ADOT&PF Central Region
P.O. Box 196900
Anchorage, AK 99513-7587

Dear Ms. Mitchell:

**Tununak Airport
Tununak, Alaska
As-Built Airport Layout Plan (24 August 2017)
(Original ALP Airspace #2010-AAL-194-NRA)**

We have completed our review of the Tununak Airport As-Built Airport Layout Plan (ALP) dated 24 August, 2017, and find it acceptable for documenting the existing conditions of the airport.

Please attach this letter to the enclosed ALP and retain it in your files for future use

Sincerely,

Pat Zettler, P.E., Lead Engineer
Airports Division

TUNUNAK AIRPORT

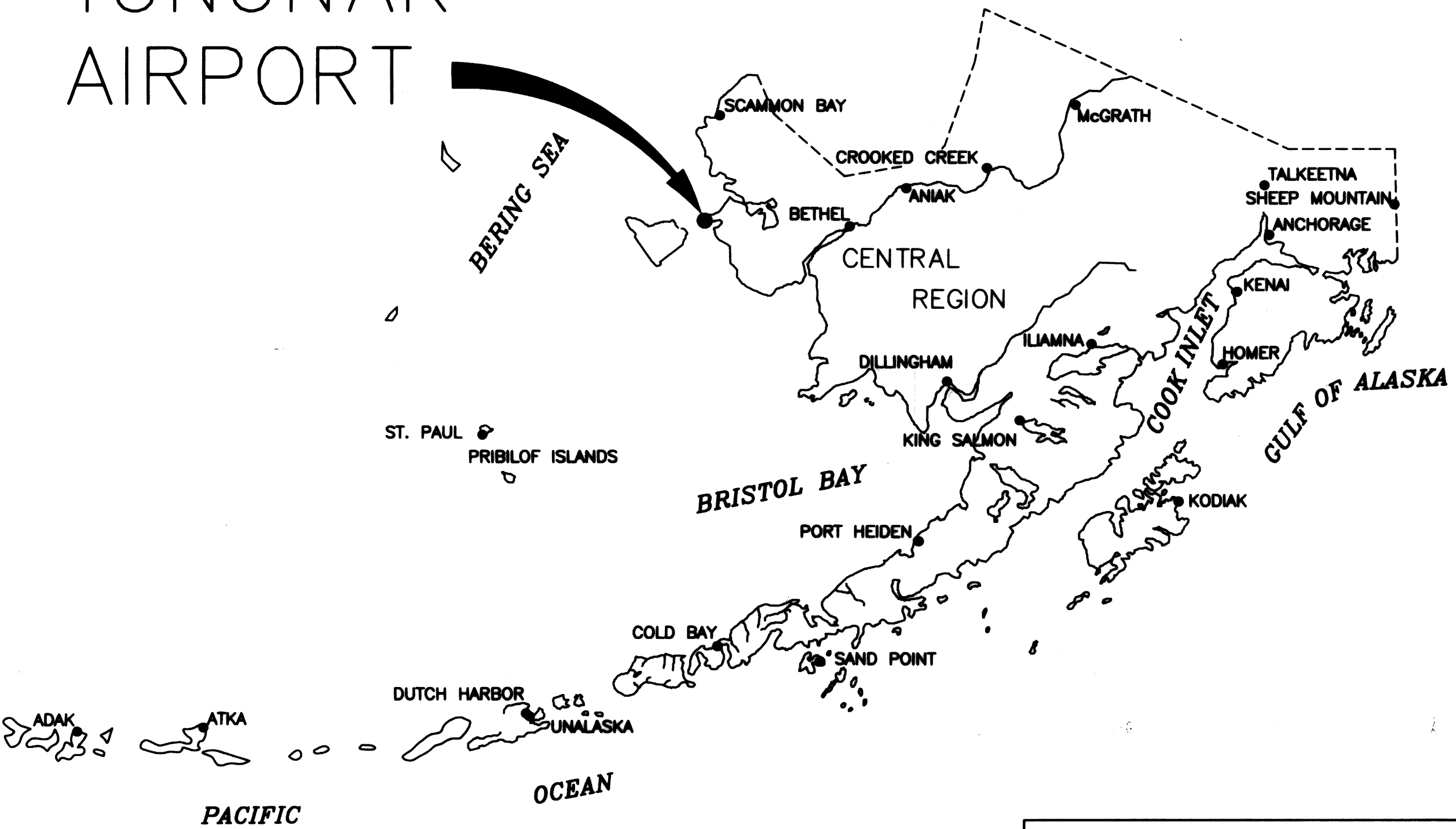

LOCATION MAP
NOT TO SCALE

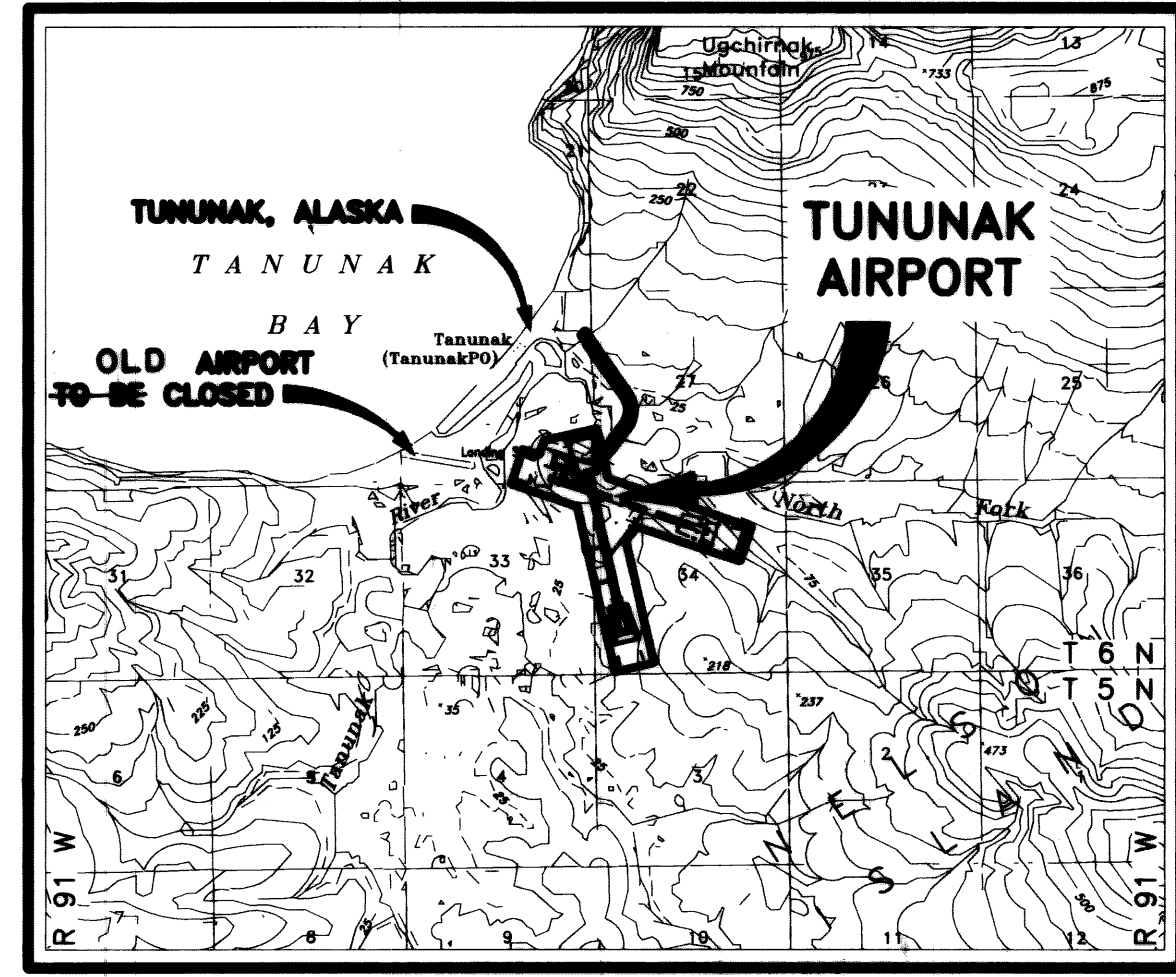

VICINITY MAP

1 0 1 2
MILES
T 6 N, R 91 W, SECTIONS 27, 28, 33, 34
SEWARD MERIDIAN
U.S.G.S. NUNNAK ISLAND (C-1), ALASKA

| AIRPORT DATA TABLE | | | |
|--|-------------|------------------------------------|---------------|
| ITEM | EXISTING * | EXISTING | ULTIMATE |
| ICAO IDENTIFIER | | NONE | NONE |
| NATIONAL AIRPORT IDENTIFIER | 4KA | 4KA | 4KA |
| FAA SITE NUMBER | 50773.A | 50773.A | 50773.A |
| AIRPORT ELEVATION | 14 MSL | 62.3 (NAVD88) | 62.3 (NAVD88) |
| AIRPORT REFERENCE CODE | | B-II | B-II |
| MEAN MAXIMUM TEMPERATURE, HOTTEST MONTH | | 56°, JULY | 56°, JULY |
| AIRPORT AND TERMINAL NAVAIDS | ROT. BEACON | ROT. BEACON | ROT. BEACON |
| TAXIWAY LIGHTING / MARKING | M.I./NA | M.I./NA | M.I./NA |
| OBSTRUCTION SURVEY SOURCE AND TYPE | NONE | V.G | NVG |
| MAGNETIC DECLINATION, YEAR, RATE OF CHANGE | | 10°46' JAN 2015 - 0°17' (W) / YEAR | |

| GEOGRAPHIC COORDINATES TABLE | | | | |
|------------------------------|-------------------|--------------------|-------------------|--------------------|
| ITEM | EXISTING LATITUDE | EXISTING LONGITUDE | ULTIMATE LATITUDE | ULTIMATE LONGITUDE |
| ARP | 60°34'10.30" N | 165°14'46.62" W | 60°34'13.42" N | 165°14'38.80" W |
| THRESHOLD RW 16 | 60°34'26.19" N | 165°14'53.57" W | 60°34'28.19" N | 165°14'53.57" W |
| THRESHOLD RW 34 | 60°33'54.42" N | 165°14'39.68" W | 60°33'47.67" N | 165°14'36.73" W |
| THRESHOLD RW 10 | | | 60°34'26.42" N | 165°15'10.22" W |
| THRESHOLD RW 28 | | | 60°34'13.38" N | 165°13'54.67" W |

| LEGEND | | |
|----------------------------------|----------|----------|
| ITEM | EXISTING | ULTIMATE |
| AIRPORT REFERENCE POINT (A.R.P.) | ● | ● |
| ANTENNA | ▲ | ▲ |
| BLUFF | ▬ | ▬ |
| BUILDINGS | ▭ | ▭ |
| BUILDING RESTRICTION LINE | —BRL— | —BRL— |
| FENCE | × × × × | × × × × |
| PAPI | ■ ■ ■ ■ | □ □ □ □ |
| PROPERTY LINE | — | — |
| REIL | —R— | —R— |
| ROADWAYS | — | — |
| ROTATING BEACON | ⊙ | ⊙ |
| SHORELINE | — | — |
| SURVEY MONUMENT | ⊙ | ⊙ |
| THRESHOLD MARKERS/LIGHTS | ● ● ● ● | ○ ○ ○ ○ |
| TOPOGRAPHIC CONTOURS | —100— | —100— |
| TREE (LARGE SINGLE) | ⊙ | ⊙ |
| TREELINE | — | — |
| VASI | ■ ■ | □ □ |
| WIND CONE (LIGHTED / UNLIGHTED) | ⊙ / ⊙ | ⊙ / ⊙ |
| WIND CONE AND SEGMENTED CIRCLE | ⊙ | ⊙ |

| WIND DATA TABLE | | | | |
|-----------------|---------|--------|-------|-------|
| RUNWAY | 10.5 kt | 13 kt | 16 kt | 20 kt |
| 16/34 | 80.82% | 87.63% | - | - |
| 10/28 | 66.09% | 74.04% | - | - |
| COMBINED | 92.64% | 96.21% | - | - |

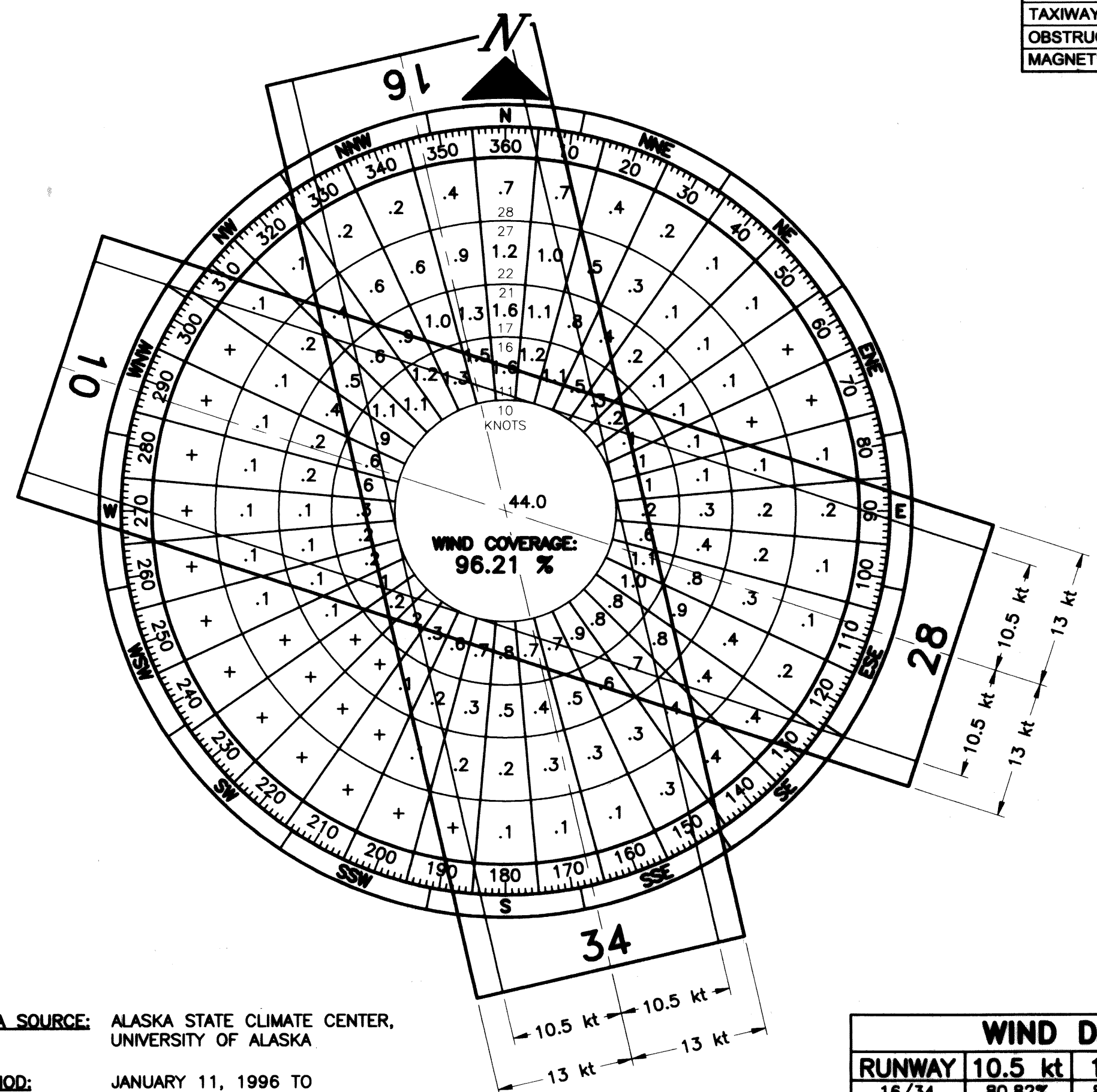

WIND DATA

DATA SOURCE: ALASKA STATE CLIMATE CENTER, UNIVERSITY OF ALASKA
PERIOD: JANUARY 11, 1996 TO JANUARY 22, 1998

| RUNWAY 16/34 DATA | | | |
|--|-------------------------------|----------------------|----------------------|
| ITEM | EXISTING * (RUNWAY 8/26) | EXISTING | ULTIMATE |
| RUNWAY TYPE | UTILITY OR OTHER THAN UTILITY | OTHER THAN UTILITY | OTHER THAN UTILITY |
| FAR PART 77 APPROACH CATEGORY (V, NPI, P) | | NPI / NPI | NPI / NPI |
| APPROACH SURFACES | VISUAL | 34:1 / 34:1 | 34:1 / 34:1 |
| VISIBILITY MINIMUM | | 1 SM | 1 SM |
| RUNWAY SURFACE | GRAVEL | GRAVEL | GRAVEL |
| PAVEMENT STRENGTH SW, DW, DTW, DOTW x1000lbs | | N/A | N/A |
| AIRCRAFT APPROACH CATEGORY | | B | B |
| AIRPLANE DESIGN GROUP | | II | II |
| TRUE BEARING | | S 12°08'37.97" E | S 12°08'36.71" E |
| EFFECTIVE GRADE | | 0.30% | 0.25% |
| TOUCHDOWN ELEVATION | 13.7 / 13.1 (MSL) | 60.9 / 62.3 (NAVD88) | 60.9 / 62.3 (NAVD88) |
| RUNWAY DIMENSIONS | 30' x 1778' | 75' x 3300' | 75' x 4000' |
| RUNWAY SAFETY AREA (RSA) DIMENSIONS | | 150' x 3900' | 150' x 4600' |
| LENGTH BEYOND RW END | | 300' / 300' | 300' / 300' |
| RUNWAY PROTECTION ZONE (RPZ) DIMENSIONS | | 500' x 700' x 1000' | 500' x 700' x 1000' |
| RUNWAY OBJECT FREE AREA (ROFA) DIMENSIONS | | 500' x 3900' | 500' x 4600' |
| LENGTH BEYOND RW END OR STOPWAY | | 300' / 300' | 300' / 300' |
| RUNWAY OBSTACLE FREE ZONE (ROFZ) DIMENSIONS | | 400' x 3700' | 400' x 4400' |
| RUNWAY LIGHTING | M.I. | M.I. | M.I. |
| RUNWAY MARKING TYPE | N/A | N/A | N/A |
| RUNWAY VISUAL APPROACH AIDS | | PAPI, REIL | PAPI, REIL |

| RUNWAY 10/28 DATA | | | |
|--|-------------------------------|-----------|----------------------|
| ITEM | EXISTING | NEAR-TERM | ULTIMATE |
| RUNWAY TYPE | UTILITY OR OTHER THAN UTILITY | | OTHER THAN UTILITY |
| FAR PART 77 APPROACH CATEGORY (V, NPI, P) | | | NPI / NPI |
| APPROACH SURFACES | | | 34:1 / 34:1 |
| VISIBILITY MINIMUM | | | 1 SM |
| RUNWAY SURFACE | | | GRAVEL |
| PAVEMENT STRENGTH SW, DW, DTW, DOTW x1000lbs | | | N/A |
| AIRCRAFT APPROACH CATEGORY | | | B |
| AIRPLANE DESIGN GROUP | | | II |
| TRUE BEARING | | | S 70°40'46.24" E |
| EFFECTIVE GRADE | | | 0.26% |
| TOUCHDOWN ELEVATION (NAVD88) | | | 56.7 / 60.2 (NAVD88) |
| RUNWAY DIMENSIONS | | | 75' x 4000' |
| RUNWAY SAFETY AREA (RSA) DIMENSIONS | | | 150' x 4600' |
| LENGTH BEYOND RW END | | | 300' / 300' |
| RUNWAY PROTECTION ZONE (RPZ) DIMENSIONS | | | 500' x 700' x 1000' |
| RUNWAY OBJECT FREE AREA (ROFA) DIMENSIONS | | | 500' x 4600' |
| LENGTH BEYOND RW END OR STOPWAY | | | 300' / 300' |
| RUNWAY OBSTACLE FREE ZONE (ROFZ) DIMENSIONS | | | 400' x 4400' |
| RUNWAY LIGHTING | | | M.I. |
| RUNWAY MARKING TYPE | | | N/A |
| RUNWAY VISUAL APPROACH AIDS | | | PAPI, REIL |

* THE EXISTING AIRPORT AND RUNWAY 8/26 WILL BE CLOSED. EXISTING DATA WAS OBTAINED FROM AIRPORT MASTER RECORDS.

| DRAWING INDEX | |
|---------------|--|
| SHT# | TITLE |
| 1 | DATA |
| 2 | EXISTING LAYOUT |
| 3 | ULTIMATE LAYOUT |
| 4 | NEAR-TERM INNER PORTION OF RUNWAY 16 APPROACH SURFACE (MAIN) |
| 5 | NEAR-TERM INNER PORTION OF RUNWAY 34 APPROACH SURFACE (MAIN) |
| 6 | ULTIMATE INNER PORTION OF RUNWAY 16 APPROACH SURFACE (MAIN) |
| 7 | ULTIMATE INNER PORTION OF RUNWAY 34 APPROACH SURFACE (MAIN) |
| 8 | ULTIMATE INNER PORTION OF RUNWAY 10 APPROACH SURFACE (CROSSWIND) |
| 9 | ULTIMATE INNER PORTION OF RUNWAY 28 APPROACH SURFACE (CROSSWIND) |
| 10 | AIRPORT AIRSPACE PLAN |
| 11 | AIRPORT AIRSPACE PROFILES (MAIN & CROSSWIND) |
| 12 | AIRPORT PROPERTY MAP |

| | |
|---------|---------------------|
| BY DATE | REVISION |
| 8/24/17 | AS-BUILT |
| 5/3/17 | ALP UPDATE AS-BUILT |

| | |
|--|----------------|
| APPROVED: | DATE: 4/1/11 |
| K. KIM RICE, P.E. PRECONSTRUCTION ENGINEER | DATE: 4/1/2011 |
| HARVEY M. DOUTHIT, P.E. DESIGN SECTION CHIEF | |

AIRPORT LAYOUT PLAN CONDITIONAL APPROVAL SUBJECT TO ALP APPROVAL LETTER DATED 8/24/17 (3/28/12) (M)

FAA AIRSPACE REVIEW NUMBER: 2010 AAL-194 NRA

DATE: 3/21/12

FAA, AIRPORTS DIVISION ALASKAN REGION, AAL-621

| | |
|--|-----------------------------------|
| STATE OF ALASKA DEPARTMENT OF TRANSPORTATION AND PUBLIC FACILITIES CENTRAL REGION | |
| TUNUNAK AIRPORT TUNUNAK, ALASKA AIRPORT LAYOUT PLAN | DATE: 5/03/2017 SHEET: 1 OF 10 |

Date Plotted: 8/24/2017, 10:27 AM
 Layout Name: Existing Layout
 File Name: 2380.03-EXISTING_LAYOUT.DWG
 Designed By: MM
 Drawn By: RLC
 Checked By: EIG

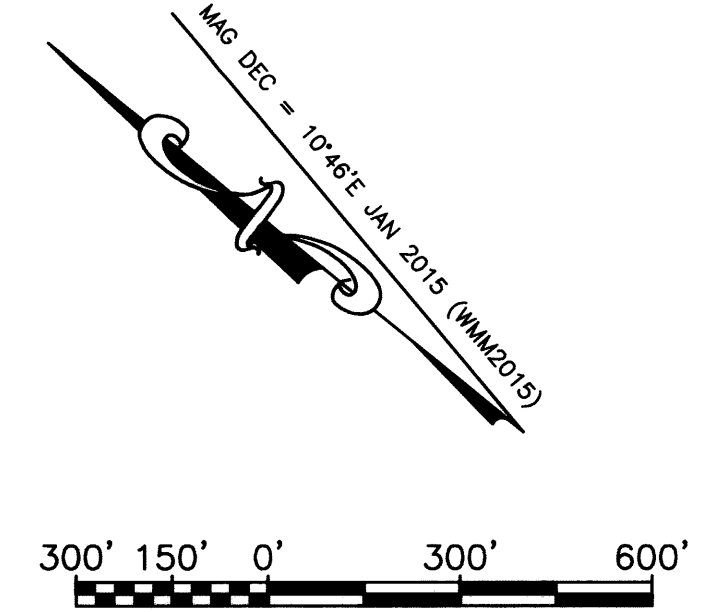
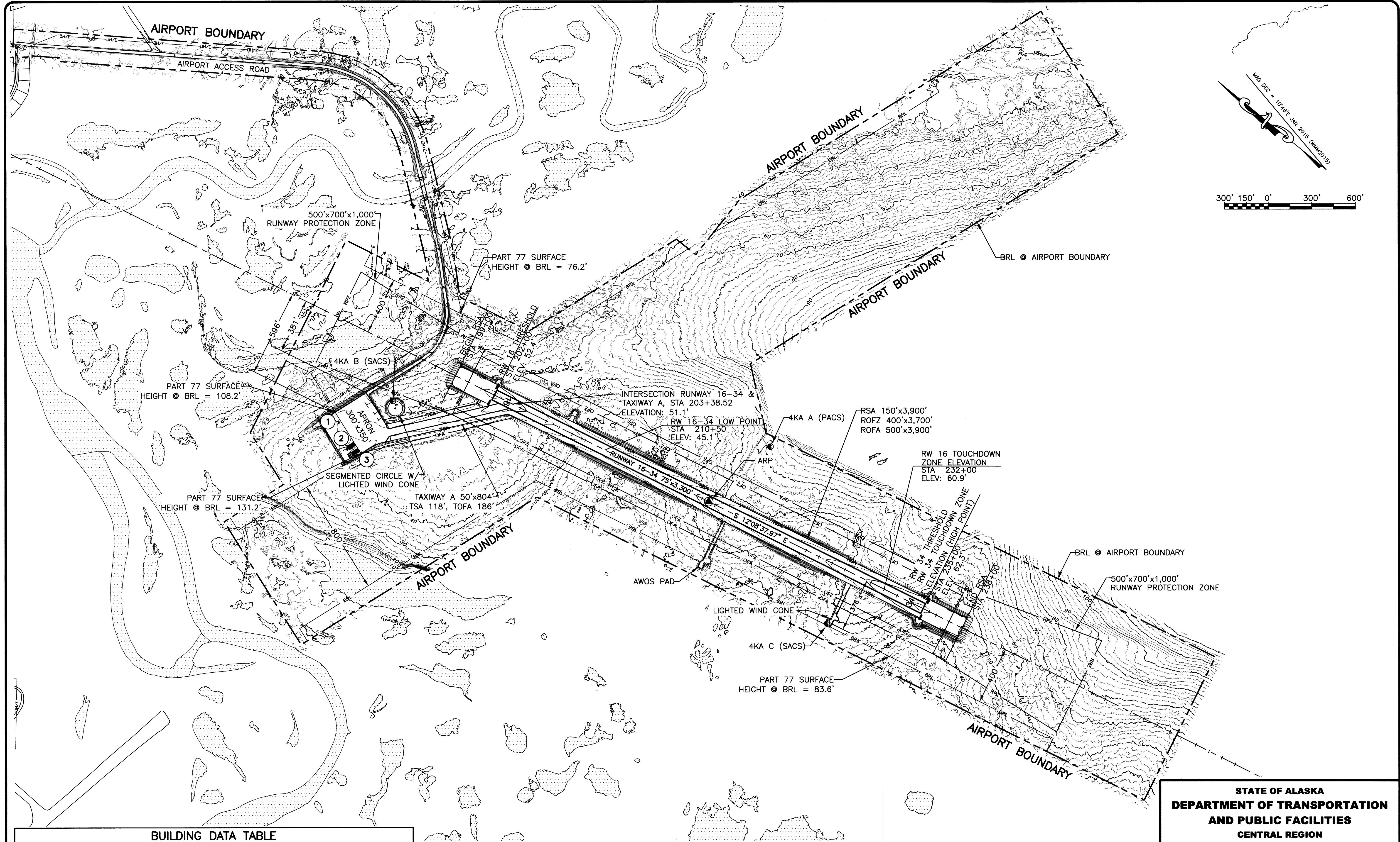

| ID # | DESCRIPTION | STATION/OFFSET "RW 16-34" | TOP ELEV | OBSTRUCTION MARKING |
|------|-----------------------------|------------------------------|----------|------------------------|
| 1 | PASSENGER SHELTER (PRIVATE) | 193+24/646' RT | 57.4' | NONE |
| 2 | SREB W/ ROTATING BEACON | 194+74/752' RT | 71.1' | NONE |
| 3 | SREB | 195+18/779' RT | 71.7' | NONE |

NOTES:
 1. NO OFZ OBJECT PENETRATIONS.

| BY | DATE | REVISION |
|----|------|----------|
| | | |
| | | |
| | | |

STATE OF ALASKA
DEPARTMENT OF TRANSPORTATION
AND PUBLIC FACILITIES
CENTRAL REGION

TUNUNAK AIRPORT
 TUNUNAK, ALASKA
 AIRPORT LAYOUT PLAN
 EXISTING LAYOUT

| | |
|--------|-----------|
| DATE: | 8/24/2017 |
| SHEET: | 2 of 10 |

Date Plotted: 8/24/2017 10:29 AM
 Designed By: MM
 Drawn By: RLC
 Checked By: EIG
 Layout Name: Ultimate Layout
 File Name: 238003-ULTIMATE_LAYOUT.DWG

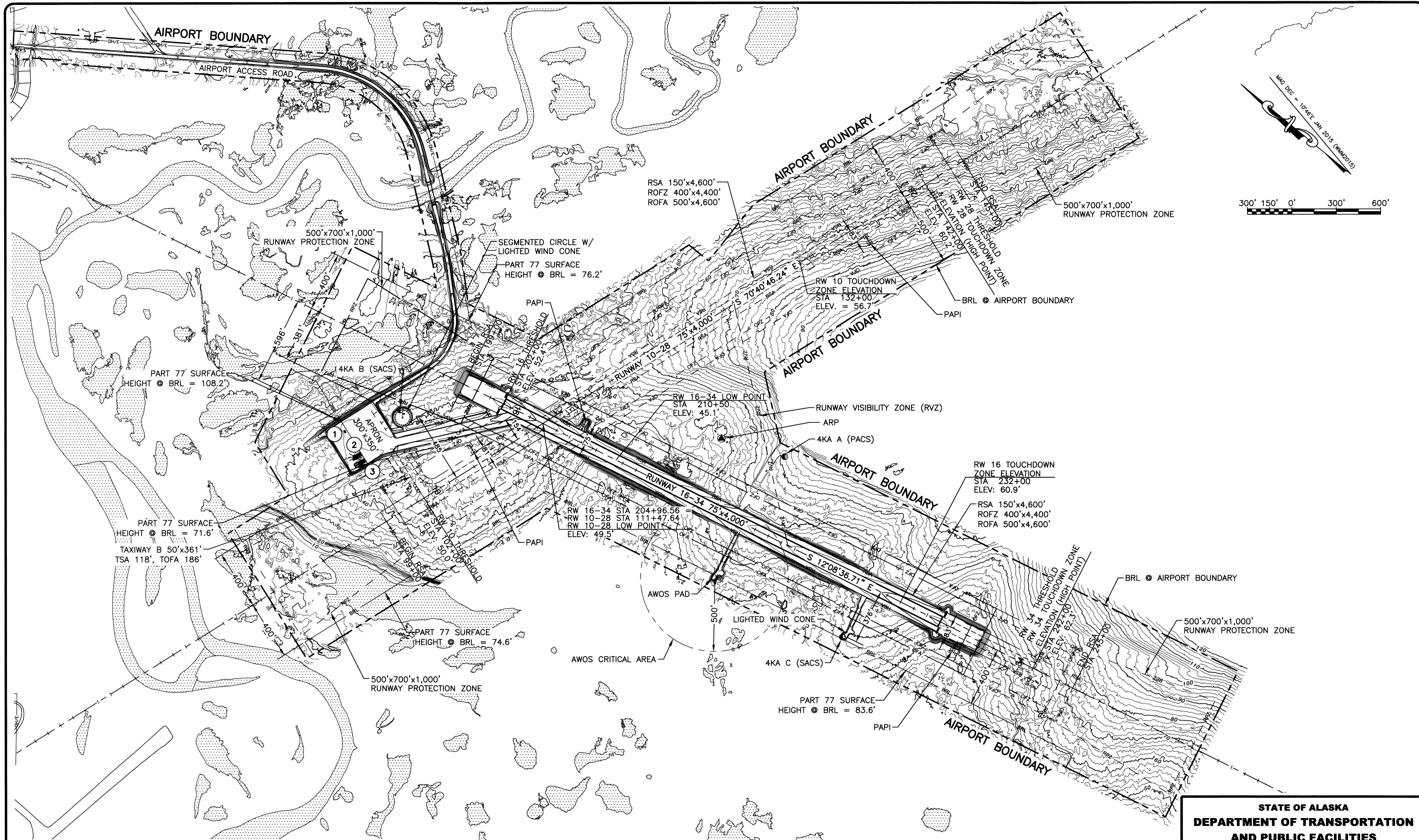

BUILDING DATA TABLE

| ID # | DESCRIPTION | STATION/OFFSET "RW 16-34" | TOP ELEV | OBSTRUCTION MARKING |
|------|-----------------------------|------------------------------|----------|------------------------|
| 1 | PASSENGER SHELTER (PRIVATE) | 193+24/646' RT | 57.4' | NONE |
| 2 | SREB W/ ROTATING BEACON | 194+74/752' RT | 71.1' | NONE |
| 3 | SREB | 195+18/779' RT | 71.7' | NONE |

TAXIWAY DATA TABLE

| TAXIWAY | TDG | LENGTH | WIDTH | TSA | TOFA | LIGHTING |
|---------|-----|--------|-------|------|------|----------|
| A | III | 804' | 50' | 118' | 186' | MITL |
| B | III | 361' | 50' | 118' | 186' | MITL |

NOTES:
 1. NO OFZ OBJECT PENETRATIONS.
 2. NO RVZ OBSTRUCTIONS.

| BY | DATE | REVISION |
|----|------|----------|
| | | |
| | | |
| | | |

**STATE OF ALASKA
 DEPARTMENT OF TRANSPORTATION
 AND PUBLIC FACILITIES
 CENTRAL REGION**

TUNUNAK AIRPORT
 TUNUNAK, ALASKA
 AIRPORT LAYOUT PLAN

ULTIMATE LAYOUT

DATE:
8/24/2017
SHEET:
3 OF
10

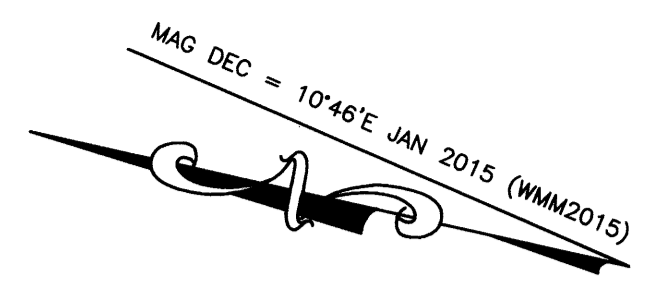

HORIZONTAL TO VERTICAL RATIO = 10:1

NOTES:

1. THERE ARE NO OBSTRUCTIONS IN THE APPROACH TO RUNWAY 16, THEREFORE THE OBSTRUCTION CLEARANCE SLOPE IS ESTABLISHED AS 34:1 PER FAA AC 150/5200-35A, CHAPTER 4, DATA ELEMENT 57.
2. THERE ARE NO OBJECT PENETRATIONS IN THE RUNWAY APPROACH END SITING SURFACES OF RUNWAY 16. THRESHOLD SITING CRITERIA FOR RUNWAY 16 IS BASED ON INSTRUMENT NIGHT OPERATIONS SERVING APPROACH CATEGORY A AND B AIRCRAFT ONLY, AS DEFINED BY AC 150/5300-13A, TABLE 3-2, LINE 4.
3. REFER TO THE AIRPORT AIRSPACE DRAWING FOR PENETRATIONS TO THE OUTER APPROACH SURFACES.

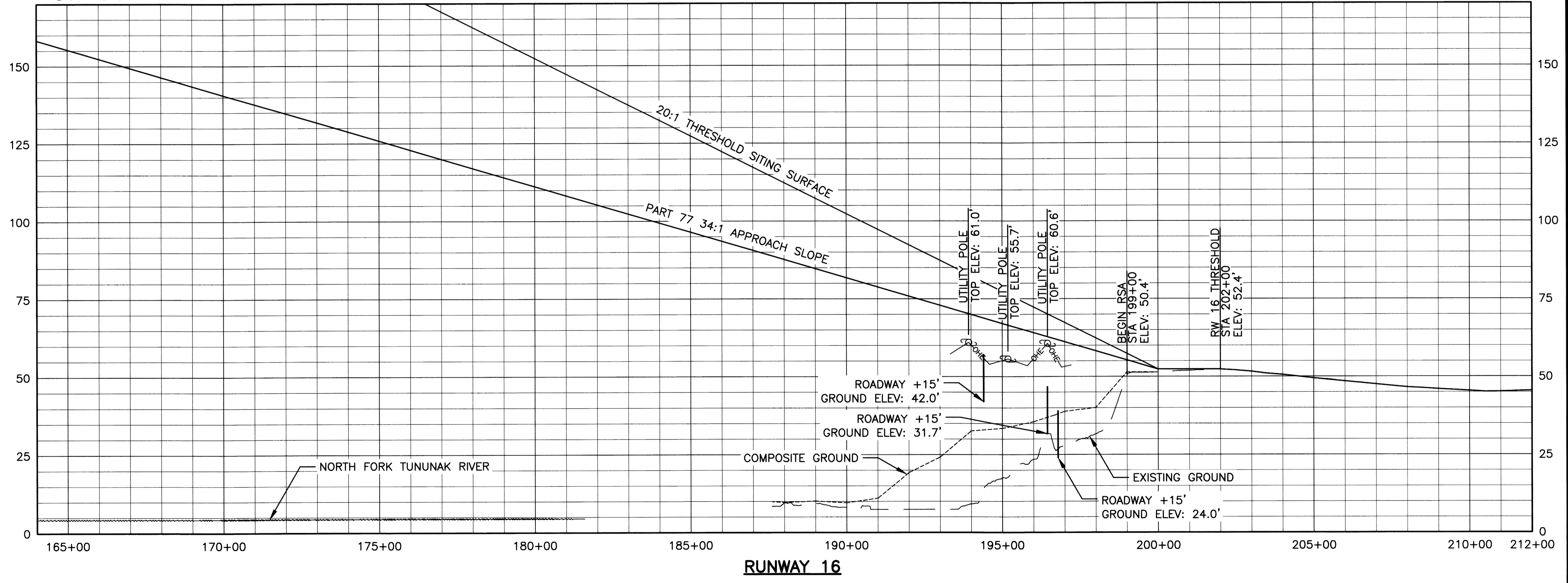
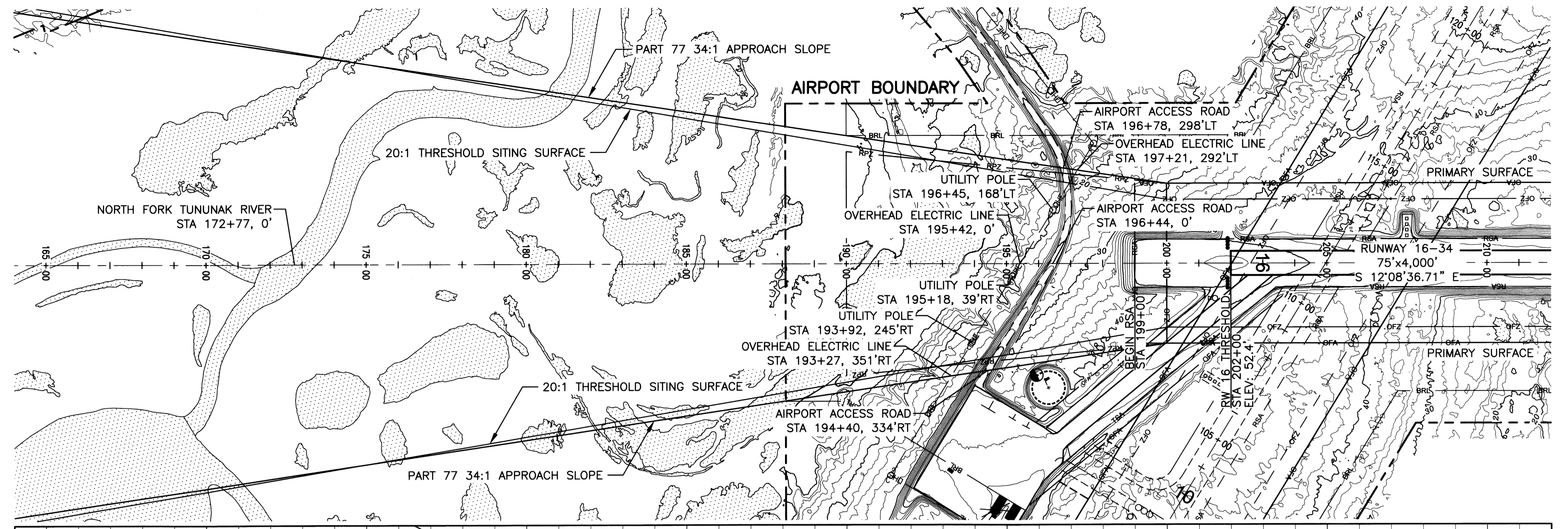

Date Plotted: 8/24/2017, 10:31 AM
 Layout Name: Inner Approach RW 16
 File Name: 2360.03-INNER APPROACH.DWG
 Designed By: MIM
 Drawn By: RLC
 Checked By: EIG

**STATE OF ALASKA
DEPARTMENT OF TRANSPORTATION
AND PUBLIC FACILITIES
CENTRAL REGION**

TUNUNAK AIRPORT
TUNUNAK, ALASKA
AIRPORT LAYOUT PLAN
INNER PORTION OF RUNWAY 16
APPROACH SURFACE (MAIN)

| | |
|--------------------|----------------------|
| DATE: 8/24/2017 | SHEET: 4 OF 10 |
|--------------------|----------------------|

| BY | DATE | REVISION |
|----|------|----------|
| | | |
| | | |
| | | |

MAG DEC = 10°46'E JAN 2015 (NMM2015)

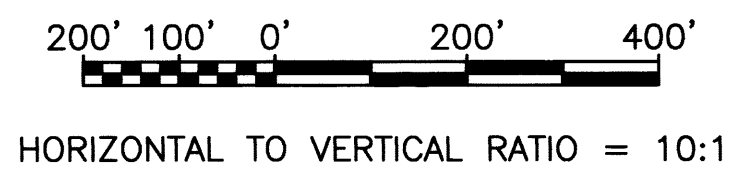

- LEGEND:**
- PART 77 SURFACE OBSTRUCTIONS
 - OBSTRUCTION IDENTIFIER

- NOTES:**
1. THE EXISTING CONTROLLING OBSTRUCTION FOR RUNWAY 34 IS TERRAIN AT STA 247+95, 370' LT, ELEVATION 95'. THE EXISTING OBSTRUCTION CLEARANCE SLOPE IS ESTABLISHED AS 33:1 PER FAA AC 150/5200-35A, CHAPTER 4, DATA ELEMENT 57. AFTER REMOVAL OF TERRAIN PENETRATIONS PROPOSED TO BE REMOVED UNDER ULTIMATE DEVELOPMENT, THERE ARE NO OBSTRUCTIONS IN THE ULTIMATE APPROACH TO RUNWAY 34. THE ULTIMATE OBSTRUCTION CLEARANCE SLOPE IS ESTABLISHED AS 34:1 PER FAA AC 150/5200-35A, CHAPTER 4, DATA ELEMENT 57.
 2. THERE ARE NO OBJECT PENETRATIONS IN THE RUNWAY APPROACH END SITING SURFACES OF EXISTING RUNWAY 34. AFTER REMOVAL OF TERRAIN PROPOSED UNDER ULTIMATE DISPOSITION, THERE WILL BE NO OBJECT PENETRATIONS IN THE RUNWAY APPROACH END SITING SURFACES OF ULTIMATE RUNWAY 34. THRESHOLD SITING CRITERIA FOR RUNWAY 34 IS BASED ON INSTRUMENT NIGHT OPERATIONS SERVING APPROACH CATEGORY A AND B AIRCRAFT ONLY, AS DEFINED BY AC 150/5300-13A, TABLE 3-2, LINE 4.
 3. REFER TO THE AIRPORT AIRSPACE DRAWING FOR PENETRATIONS TO THE OUTER APPROACH SURFACES.

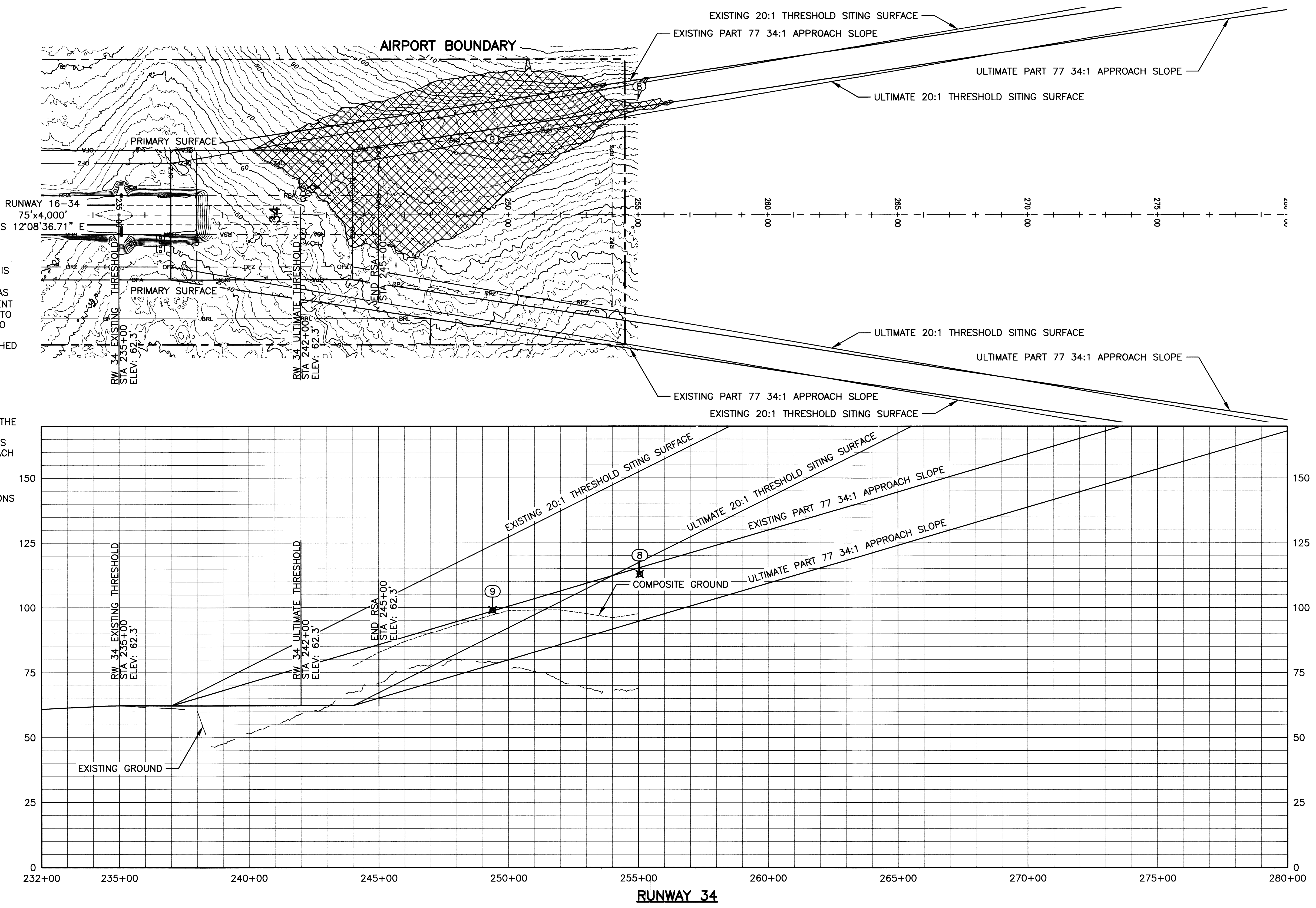

Date Plotted: 8/24/2017, 10:31 AM
 Layout Name: Inner Approach RW 34
 File Name: 2390.03-INNER APPROACH.DWG
 Designed By: MM
 Drawn By: RLC
 Checked By: EDG

PART 77 SURFACE OBSTRUCTIONS TABLE (INNER PORTION RW 34)

| ID No. | DESCRIPTION | RW 16-34 STATION/OFFSET | ELEVATION | SURFACE PENETRATED | SURFACE ELEVATION | AMOUNT PENETRATED | DISPOSITION | STAGE TO CORRECT |
|--------|--------------|-------------------------|-----------|-------------------------------|-------------------|-------------------|-------------|------------------|
| 8 | BUSH | 255+05/494'LT | 113.0' | TRANSITIONAL | 106.3' | 6.7' | REMOVE | ULTIMATE |
| 9 | BUSH/TERRAIN | 249+38/291'LT | 99.1' | PRIMARY/APPROACH/TRANSITIONAL | 78.2' | 20.9' | REMOVE | ULTIMATE |

STATE OF ALASKA
DEPARTMENT OF TRANSPORTATION
AND PUBLIC FACILITIES
CENTRAL REGION

TUNUNAK AIRPORT
 TUNUNAK, ALASKA
 AIRPORT LAYOUT PLAN
 INNER PORTION OF RUNWAY 34
 APPROACH SURFACE (MAIN)

DATE: 8/24/2017
 SHEET: 5 OF 10

| BY | DATE | REVISION |
|----|------|----------|
| | | |
| | | |
| | | |

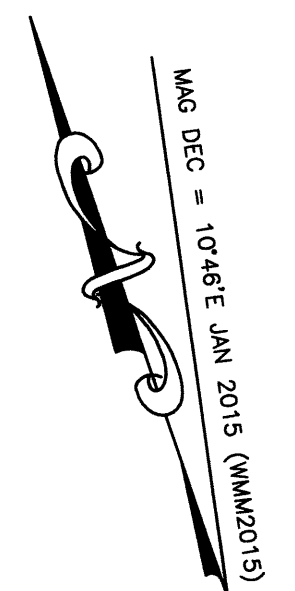

HORIZONTAL TO VERTICAL RATIO = 10:1

- NOTES:**
1. THERE ARE NO OBSTRUCTIONS IN THE APPROACH TO RUNWAY 10, THEREFORE THE OBSTRUCTION CLEARANCE SLOPE IS ESTABLISHED AS 34:1 PER FAA AC 150/5200-35A, CHAPTER 4, DATA ELEMENT 57.
 2. THERE ARE NO OBJECT PENETRATIONS IN THE RUNWAY APPROACH END SITING SURFACE OF RUNWAY 10. THRESHOLD SITING CRITERIA FOR RUNWAY 10 IS BASED ON INSTRUMENT NIGHT OPERATIONS SERVING APPROACH CATEGORY A AND B AIRCRAFT ONLY, AS DEFINED BY AC 150/5300-13A, TABLE 3-2, LINE 4.
 3. REFER TO THE AIRPORT AIRSPACE DRAWING FOR PENETRATIONS TO THE OUTER APPROACH SURFACES.

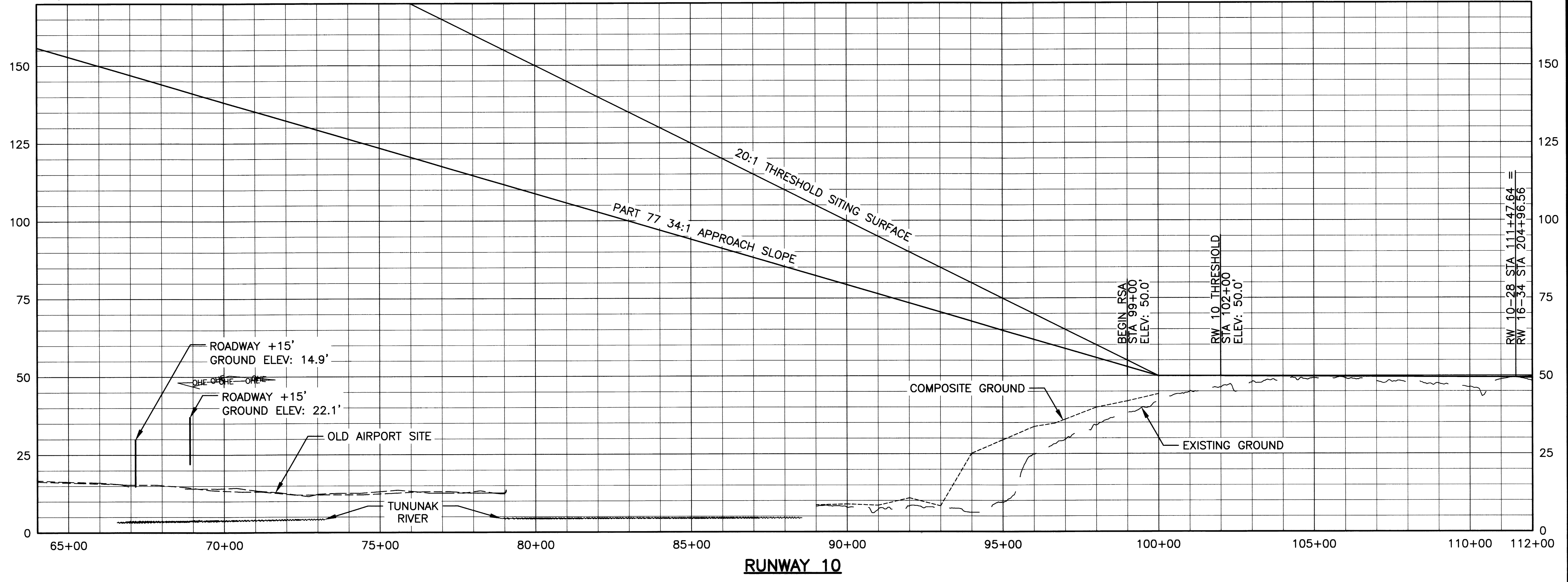
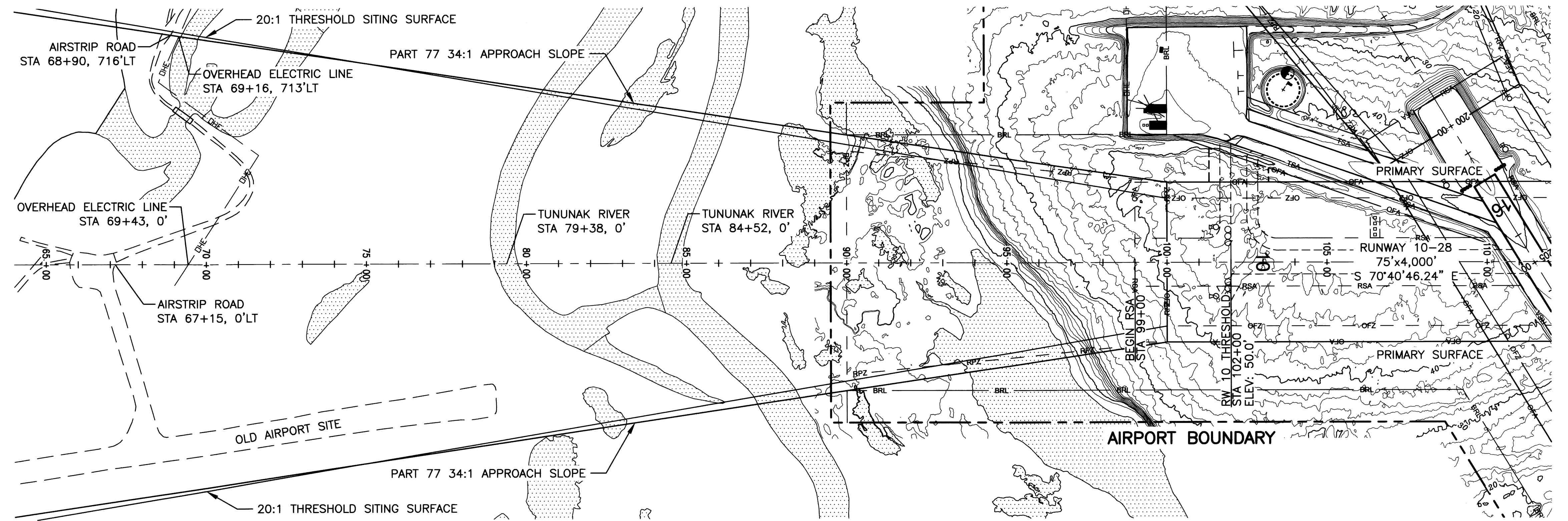

Date Plotted: 8/24/2017, 10:32 AM
 Layout Name: Ultimate Inner Approach RW 10
 File Name: 2360.03-INNER APPROACH.DWG
 Designed By: MM
 Drawn By: RLC
 Checked By: EIG

**STATE OF ALASKA
DEPARTMENT OF TRANSPORTATION
AND PUBLIC FACILITIES
CENTRAL REGION**

TUNUNAK AIRPORT
TUNUNAK, ALASKA
AIRPORT LAYOUT PLAN
ULTIMATE INNER PORTION OF RUNWAY 10
APPROACH SURFACE (CROSSWIND)

DATE: 8/24/2017
SHEET: 6 OF 10

| BY | DATE | REVISION |
|----|------|----------|
| | | |
| | | |
| | | |

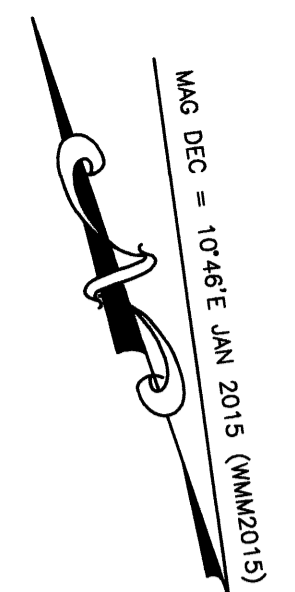

HORIZONTAL TO VERTICAL RATIO = 10:1

NOTES:

1. THE CONTROLLING OBSTRUCTION FOR RUNWAY 28 IS TERRAIN AT STA 242+33, 1,609' RT, ELEVATION 378'. THE OBSTRUCTION CLEARANCE SLOPE IS ESTABLISHED AS 30:1 PER FAA AC 150/5200-35A, CHAPTER 4, DATA ELEMENT 57.
2. AFTER GRADING FOR THE ULTIMATE RUNWAY THERE WILL BE NO OBJECT PENETRATIONS IN THE RUNWAY APPROACH END SITING SURFACES OF RUNWAY 28. THRESHOLD SITING CRITERIA FOR RUNWAY 10 IS BASED ON INSTRUMENT NIGHT OPERATIONS SERVING APPROACH CATEGORY A AND B AIRCRAFT ONLY, AS DEFINED BY AC 150/5300-13A, TABLE 3-2, LINE 4.
3. REFER TO THE AIRPORT AIRSPACE DRAWING FOR PENETRATIONS TO THE OUTER APPROACH SURFACES.

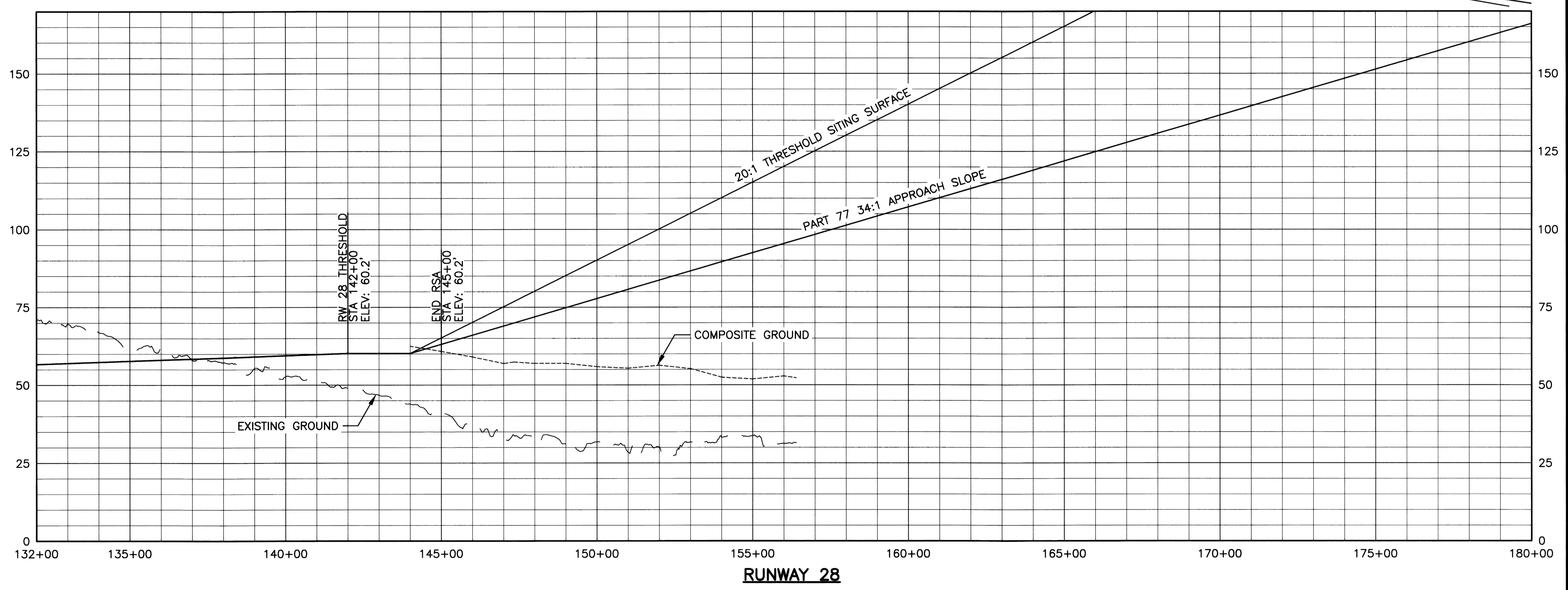
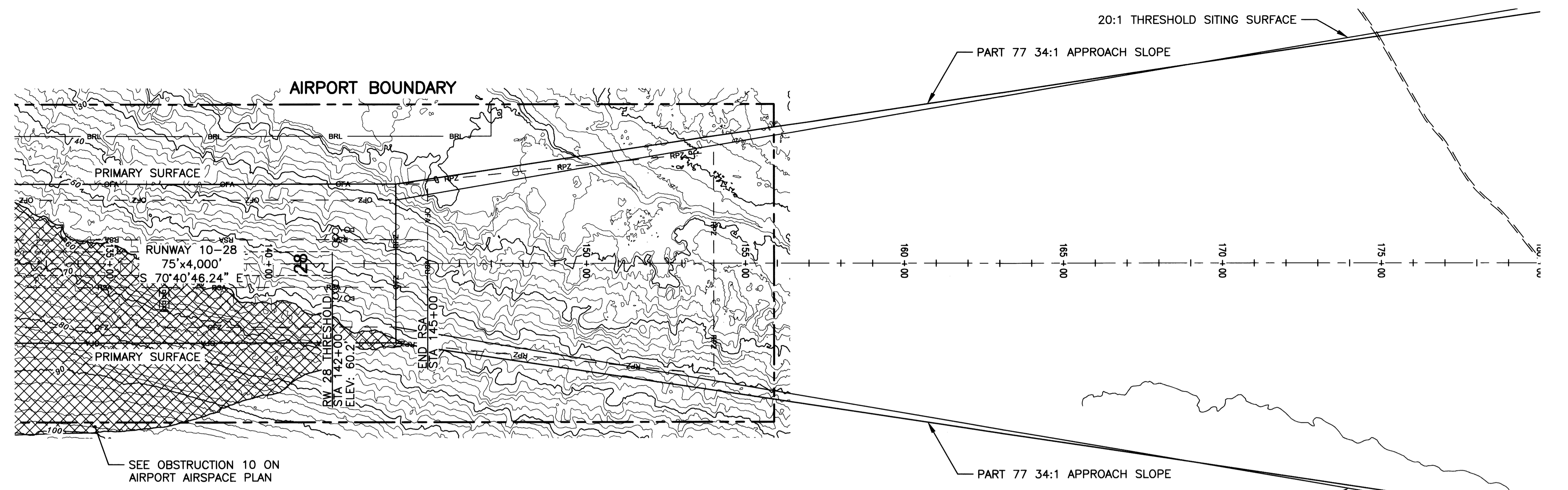

Date Plotted: 8/24/2017 10:32 AM
 Layout Name: Ultimate Inner Approach RW 28
 File Name: 12380.03--INNER APPROACH.DWG
 Designed By: MM
 Drawn By: RLC
 Checked By: EIG

**STATE OF ALASKA
DEPARTMENT OF TRANSPORTATION
AND PUBLIC FACILITIES
CENTRAL REGION**

TUNUNAK AIRPORT
TUNUNAK, ALASKA
AIRPORT LAYOUT PLAN
ULTIMATE INNER PORTION OF RUNWAY 28
APPROACH SURFACE (CROSSWIND)

| | | | |
|--|--|--|----------------------|
| | | | DATE: 8/24/2017 |
| | | | SHEET: 7 OF 10 |

| BY | DATE | REVISION |
|----|------|----------|
| | | |
| | | |
| | | |

Date Plotted: 8/24/2017, 10:34 AM
 Layout Name: Airport Airspace
 File Name: 2380.03-AIRPORT AIRSPACE.DWG
 Designed By: MM
 Drawn By: RLC
 Checked By: EIG

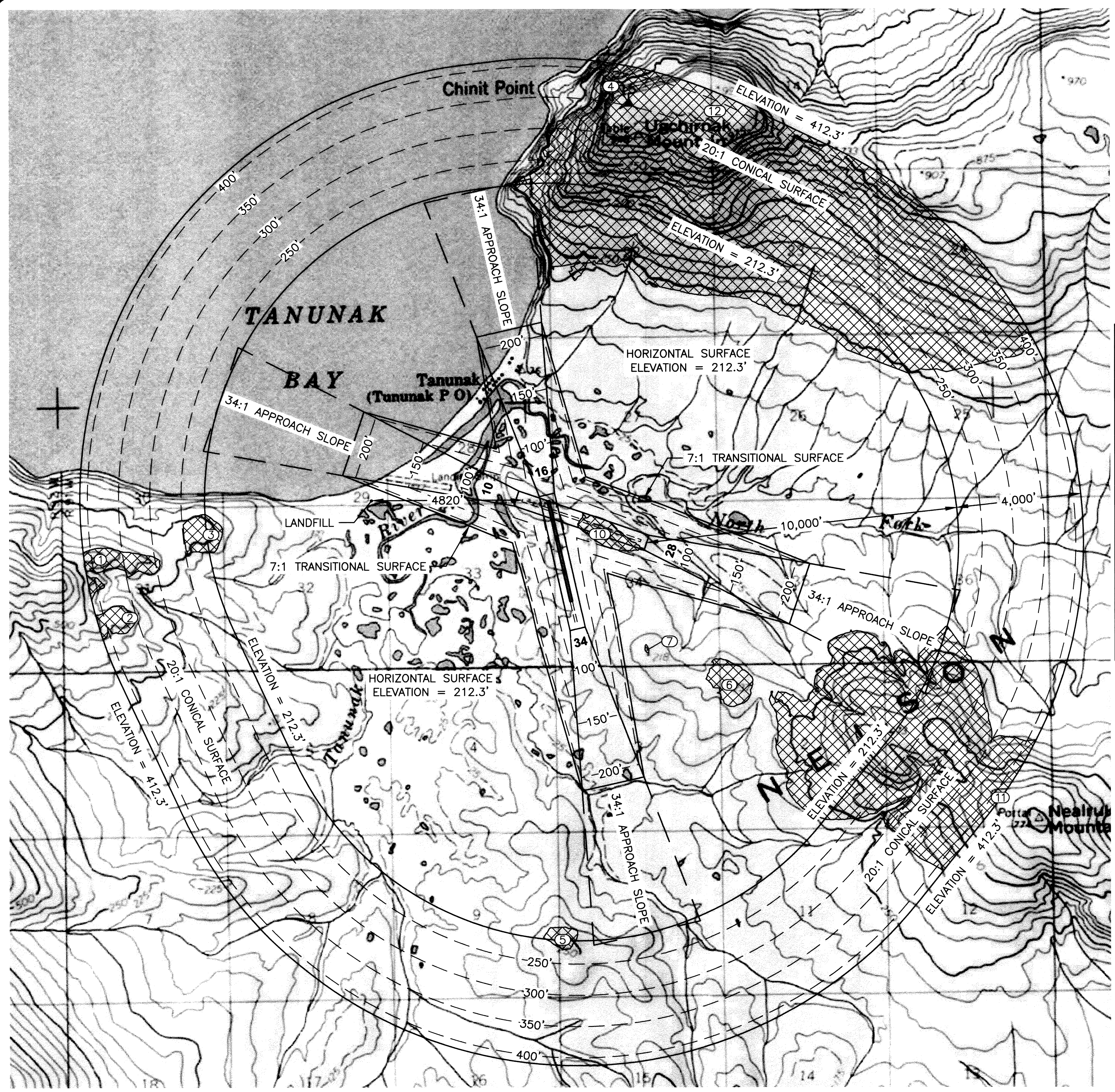

AIRPORT AIRSPACE PLAN

LEGEND:
 PART 77 SURFACE OBSTRUCTIONS
 OBSTRUCTION IDENTIFIER



| ID No. | DESCRIPTION | RW 16-34 STATION/OFFSET | ELEVATION | SURFACE PENETRATED | SURFACE ELEVATION | GROUND SURFACE ELEVATION | AMOUNT PENETRATED | DISPOSITION | STAGE TO CORRECT |
|--------|----------------------|-------------------------|-----------|-------------------------------|-------------------|--------------------------|-------------------|-------------|------------------|
| 1 | TERRAIN | 188+31/14,420'RT | 450.0' | CONICAL | 386.5' | 450.0' | 63.5' | TO REMAIN | N/A |
| 2 | TERRAIN | 208+63/13,910'RT | 400.0' | CONICAL | 360.7' | 400.0' | 39.3' | TO REMAIN | N/A |
| 3 | TERRAIN | 188+42/10,783'RT | 250.0' | HORIZONTAL/CONICAL | 212.3' | 250.0' | 37.7' | TO REMAIN | N/A |
| 4 | COMMUNICATIONS TOWER | 83+37/5,352'LT | 1080.3' | CONICAL | 354.0' | 982.8' | 726.3' | TO REMAIN | N/A |
| 5 | TERRAIN | 340+16/2,691'RT | 247.5' | HORIZONTAL/CONICAL | 212.3' | 247.5' | 35.2' | TO REMAIN | N/A |
| 6 | TERRAIN | 272+42/4,339'LT | 234.7' | HORIZONTAL | 212.3' | 234.7' | 22.4' | TO REMAIN | N/A |
| 7 | TERRAIN | 255+50/2,026'LT | 215.4' | HORIZONTAL | 212.3' | 215.4' | 3.1' | TO REMAIN | N/A |
| 10 | TERRAIN | 215+98/1,369'LT | 83.5' | PRIMARY/APPROACH/TRANSITIONAL | 55.6' | 83.5' | 27.9' | REMOVE | ULTIMATE |
| 11 | TERRAIN | 326+96/11,999'LT | 671.2' | APPROACH/HORIZONTAL/CONICAL | 411.2' | 671.2' | 260.0' | TO REMAIN | N/A |
| 12 | TERRAIN | 92+04/7,993'LT | 986.3' | HORIZONTAL/CONICAL | 384.0' | 986.3' | 602.3' | TO REMAIN | N/A |

- NOTES:**
- REFER TO INNER PORTION OF THE APPROACH SURFACE DRAWINGS FOR CLOSE IN OBSTRUCTIONS.
 - PRIMARY SURFACE WIDTH IS 500' FOR BOTH RUNWAYS.
 - THERE ARE NO KNOWN HEIGHT RESTRICTIONS.
 - AIRPORT ELEVATION IS 62.3'
 - PART 77 SURFACES BASED ON ULTIMATE AIRPORT LAYOUT.
 - APPROACH SLOPES ARE 34:1 BEGINNING 200' FROM THE THRESHOLDS.
 - OBSTRUCTION IDENTIFIER FOR HATCHED AREAS IS HIGHEST FEATURE WITHIN AREA OF PENETRATIONS.
 - OBSTRUCTION DATA FROM VERTICALLY GUIDED AIRPORT AIRSPACE ANALYSIS SURVEY (AAAS) PERFORMED BY R&M CONSULTANTS IN 2016.
 - THERE IS NO SEWAGE LAGOON IN TUNUNAK.

STATE OF ALASKA
DEPARTMENT OF TRANSPORTATION
AND PUBLIC FACILITIES
CENTRAL REGION

| BY | DATE | REVISION |
|----|------|----------|
| | | |
| | | |
| | | |

TUNUNAK AIRPORT
 TUNUNAK, ALASKA
 AIRPORT LAYOUT PLAN
 AIRPORT AIRSPACE PLAN

DATE: 8/24/2017
 SHEET: 8 OF 10

Date Plotted: 8/24/2017, 10:34 AM
 Layout Name: Airport Airspace Profiles
 File Name: 12380.03-AIRPORT AIRSPACE.DWG
 Designed By: MMW
 Drawn By: RLC
 Checked By: EJO

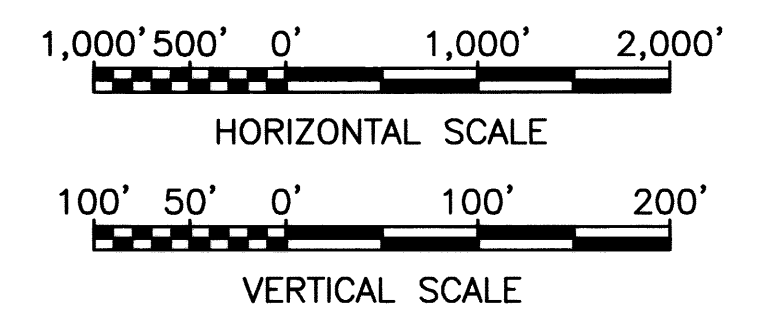
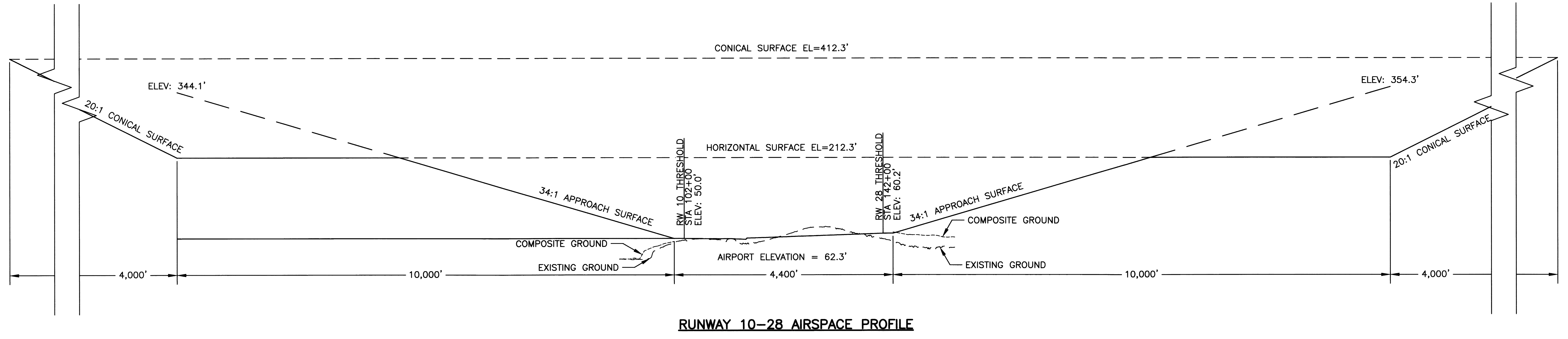
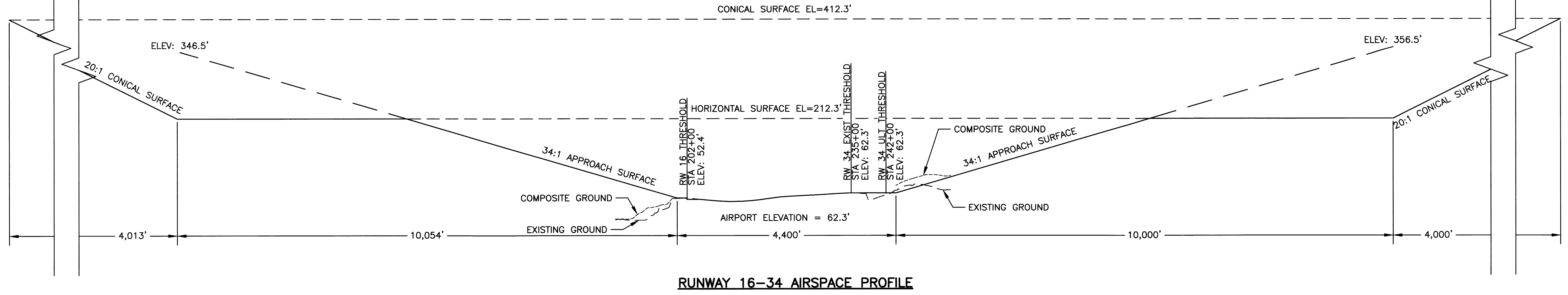

STATE OF ALASKA
DEPARTMENT OF TRANSPORTATION
AND PUBLIC FACILITIES
CENTRAL REGION

| BY | DATE | REVISION |
|----|------|----------|
| | | |
| | | |
| | | |

TUNUNAK AIRPORT
 TUNUNAK, ALASKA
 AIRPORT LAYOUT PLAN
 AIRPORT AIRSPACE PROFILES
 (MAIN & CROSSWIND)

DATE: 8/24/2017
 SHEET: 9 OF 10

Date Plotted: 8/24/2017, 10:37 AM
 Layout Name: Airport Property Map
 File Name: 2380.03-AIRPORT PROPERTY MAP.DWG
 Designed By: MMW
 Drawn By: RLC
 Checked By: EJC

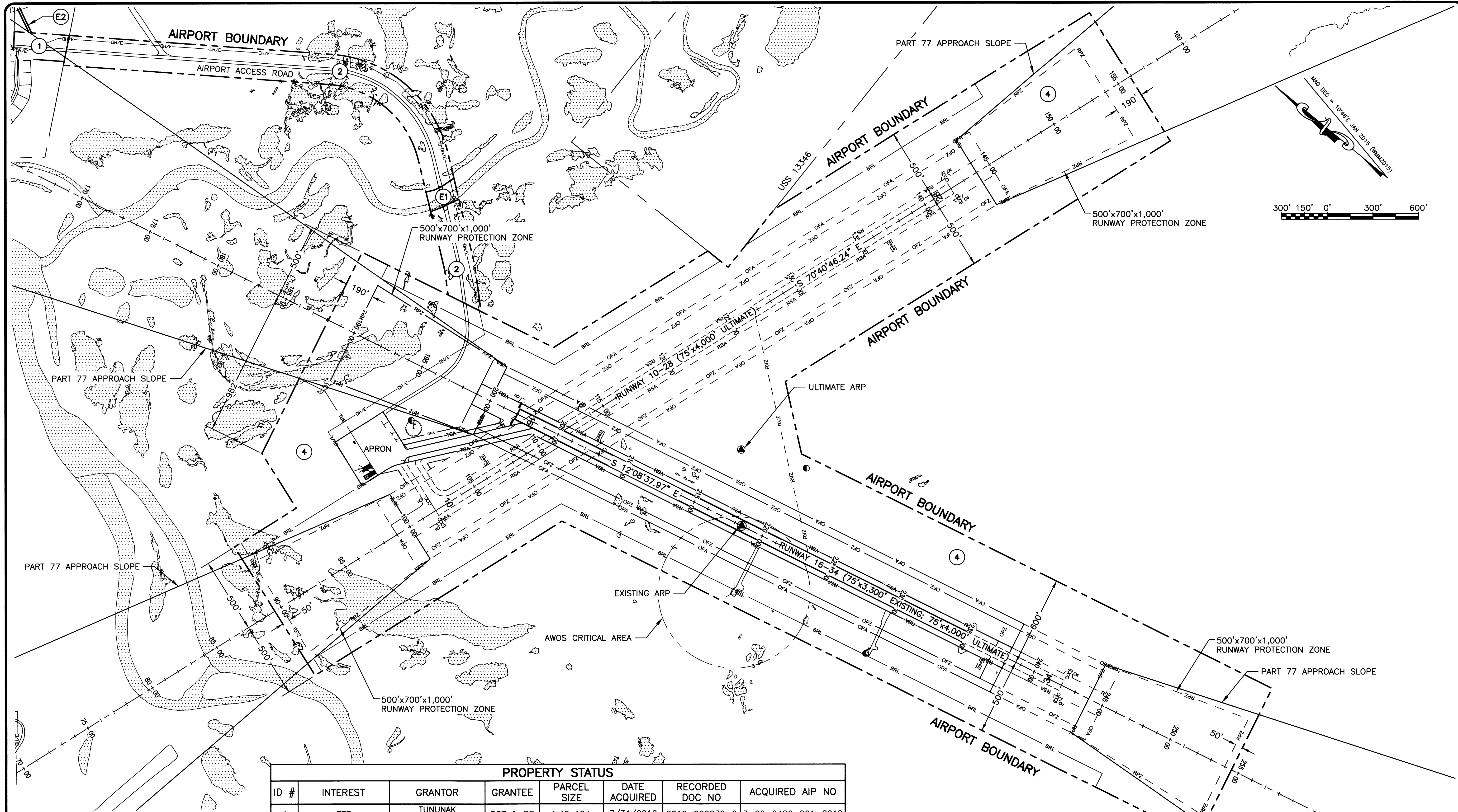

| PROPERTY STATUS | | | | | | | |
|-----------------|----------------------------|-----------------------------|----------|-------------|---------------|-----------------|--------------------|
| ID # | INTEREST | GRANTOR | GRANTEE | PARCEL SIZE | DATE ACQUIRED | RECORDED DOC NO | ACQUIRED AIP NO |
| 1 | FEE | TUNUNAK TRADITIONAL COUNCIL | DOT & PF | 1.42 AC± | 7/31/2012 | 2012-000832-0 | 3-02-0486-001-2012 |
| 2 | FEE/SURFACE | TUNUNRMIUT RINIT CORP. | DOT & PF | 16.30 AC | 5/29/2012 | 2012-000587-0 | 3-02-0486-001-2012 |
| | FEE/SUBSURFACE | CALISTA CORP. | DOT & PF | 16.30 AC | 5/29/2012 | 2012-000586-0 | 3-02-0486-001-2012 |
| E1 | EASEMENT | STATE OF ALASKA, DNR | DOT & PF | 0.60 AC | 1/24/2017 | 2017-000049-0 | 3-02-0486-001-2012 |
| 4 | FEE/SURFACE | TUNUNRMIUT RINIT CORP. | DOT & PF | 297.05 AC± | 5/29/2012 | 2012-000587-0 | 3-02-0486-001-2012 |
| | FEE/SUBSURFACE | CALISTA CORP. | DOT & PF | 297.05 AC± | 5/29/2012 | 2012-000586-0 | 3-02-0486-001-2012 |
| E2 | FEE/UTILITY EASEMENT & ROW | TUNUNAK TRADITIONAL COUNCIL | DOT & PF | 2,665 SF ± | 7/31/2012 | 2012-000831-0 | 3-02-0486-001-2012 |

| BY | DATE | REVISION |
|----|------|----------|
| | | |
| | | |
| | | |

**STATE OF ALASKA
 DEPARTMENT OF TRANSPORTATION
 AND PUBLIC FACILITIES
 CENTRAL REGION**

TUNUNAK AIRPORT
 TUNUNAK, ALASKA
 AIRPORT LAYOUT PLAN
 AIRPORT PROPERTY MAP

| |
|--------------------------|
| DATE: 8/24/2017 |
| SHEET: 10 OF 10 |