

AIRPORT DATA		
	EXISTING	ULTIMATE
AIRPORT ELEVATION (MSL)**	1666.06	1666.06
AIRPORT REFERENCE CODE	B-II	B-II
NATIONAL AIRPORT IDENTIFIER	3T4	
MEAN MAX. DAILY TEMP. HOTTEST MONTH (JULY)	72.4° F	72.4° F
TAXIWAY LIGHTING	MITL	MITL
RAMP LIGHTING	FLOODLIGHT	FLOODLIGHT
AIRPORT AND TERMINAL NAVAIDS	ROTATING BEACON	ROTATING BEACON REILS, PAPI
WEATHER FACILITIES	AWOS	
AIRPORT REFERENCE POINT (ARP) (NAD 83)	STA 118+00	
	LAT.	63°07'28.592"N
	LONG.	142°31'03.559"W
THRESHOLD 08	STA 100+00	STA 100+00
	LAT.	63°07'32.135"N
	LONG.	142°31'41.910"W
THRESHOLD 26	STA 133+00	STA 136+00
	LAT.	63°07'25.636"N
	LONG.	142°30'25.211"W

RUNWAY DATA		
	EXISTING	ULTIMATE
EFFECTIVE GRADIENT	0.14%	0.14%
% WIND COVERAGE	98.9%	98.9%
INSTRUMENT RUNWAY	NON-PRECISION	NON-PRECISION
RUNWAY SURFACE TYPE	GRAVEL	GRAVEL
PAVEMENT STRENGTH	N/A	N/A
APPROACH SURFACES	34:1	34:1
RUNWAY LIGHTING	MIRL	MIRL
RUNWAY MARKING	N/A	
NAVIGATION AIDS	ROT. BEACON, OPS	ROT. BEACON, OPS
R/W DIMENSIONS	3300'x75'	3600'x75'
R/W SAFETY AREA	3900'x150'	4200'x150'
R/W OBJECT FREE AREA (ROFA)	3900'x500'	4200'x500'
T/W DIMENSIONS	497.5'x50'	497.5'x50'
T/W SAFETY AREA	497.5'x118'	497.5'x118'
T/W OBJECT FREE AREA (TOFA)	482.5'x131'	482.5'x131'
OFZ WIDTH	400'	400'
OFZ BEYOND RUNWAY END	200'	200'

LEGEND		
	EXISTING	ULTIMATE
PROPERTY LINE	---	---
BUILDING RESTRICTION LINE (B.R.L.)	---	---
DEVELOPMENT	▭	▭
WIND CONE & SEGMENTED CIRCLE	⊙	⊙
BUILDINGS	▭	▭
ROADWAYS	---	---
AIRPORT REFERENCE POINT	⊙	⊙
ROTATING BEACON	⊙	⊙
ANTENNAE/TOWERS	⊙	⊙
VASI	⊙	⊙
RUNWAY EDGE LIGHT	⊙	⊙
TAXIWAY EDGE LIGHT	⊙	⊙
EXISTING CONTOUR (4' INTERVAL)	---	---

- NOTES:
- NO THRESHOLD SITING SURFACE PENETRATIONS.
 - NO OFZ OBJECT PENETRATIONS.
 - AIRSPACE PENETRATIONS SHOWN ON SHEET 4/4.
 - MAGNETIC DECLINATION FOR EPOCH YEAR 2010, 22'11"E, WAS USED TO DETERMINE THE RUNWAY DESIGNATIONS.

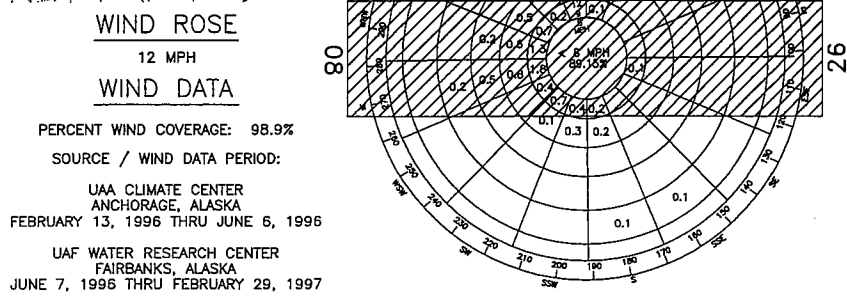

DESIGN	
DRAWN	
CHECKED	
BY	DATE
RLC	7/31/06 AS-BUILT 1/16/2006
RLC	2/9/2000 FAA APPROVED
BY	DATE
	REVISIONS

STATE OF ALASKA
DEPARTMENT OF TRANSPORTATION AND PUBLIC FACILITIES
NORTHERN REGION - DESIGN AND ENGINEERING SERVICES

APPROVED
Patricia D. Miller
PATRICIA D. MILLER, P.E. DATE 8/22/06
DESIGN GROUP CHIEF

REVISED AIRPORT LAYOUT PLAN APPROVED
BY LETTER DATED: 8/25/06
John T. Lovett
AIRPORTS DIVISION,
ALASKAN REGION, AAL-601
AIRSPACE REVIEW #99AAL-062NRA

THIS ALP HAS BEEN PREPARED FROM THE ALP SIGNED ON 01/06/2000 AND FAA APPROVED ON 02/09/2000, THE PROPERTY PLAN DATED 01/10/2000 AND THE AS-BUILTS FOR AIP# 3-02-0296-02 DATED 1/16/2006.

TETLIN AIRPORT
AIRPORT LAYOUT PLAN
AIRPORT LAYOUT DRAWING

SHEET
1 OF 4

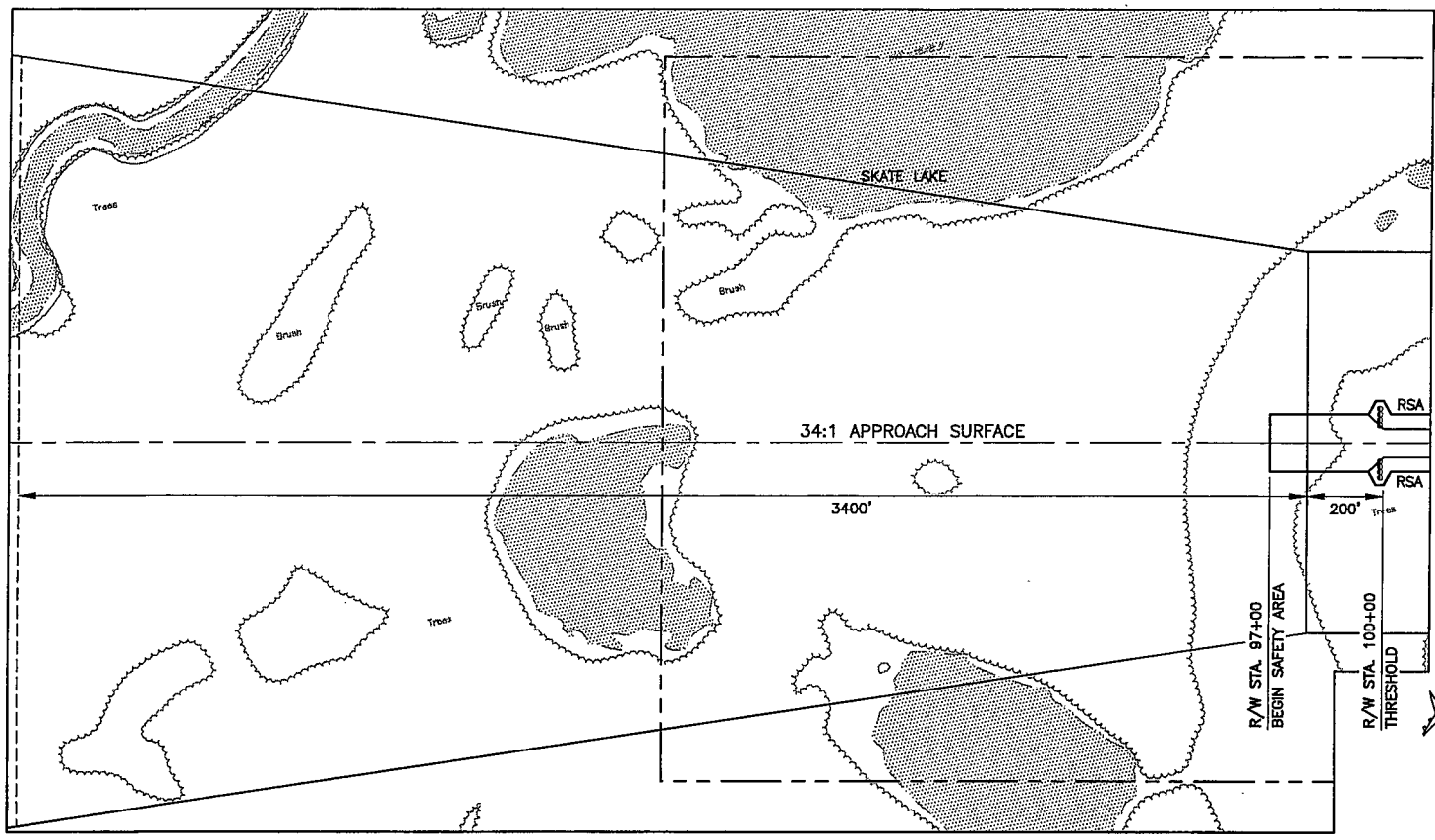

R/W 08 INNER APPROACH PLAN

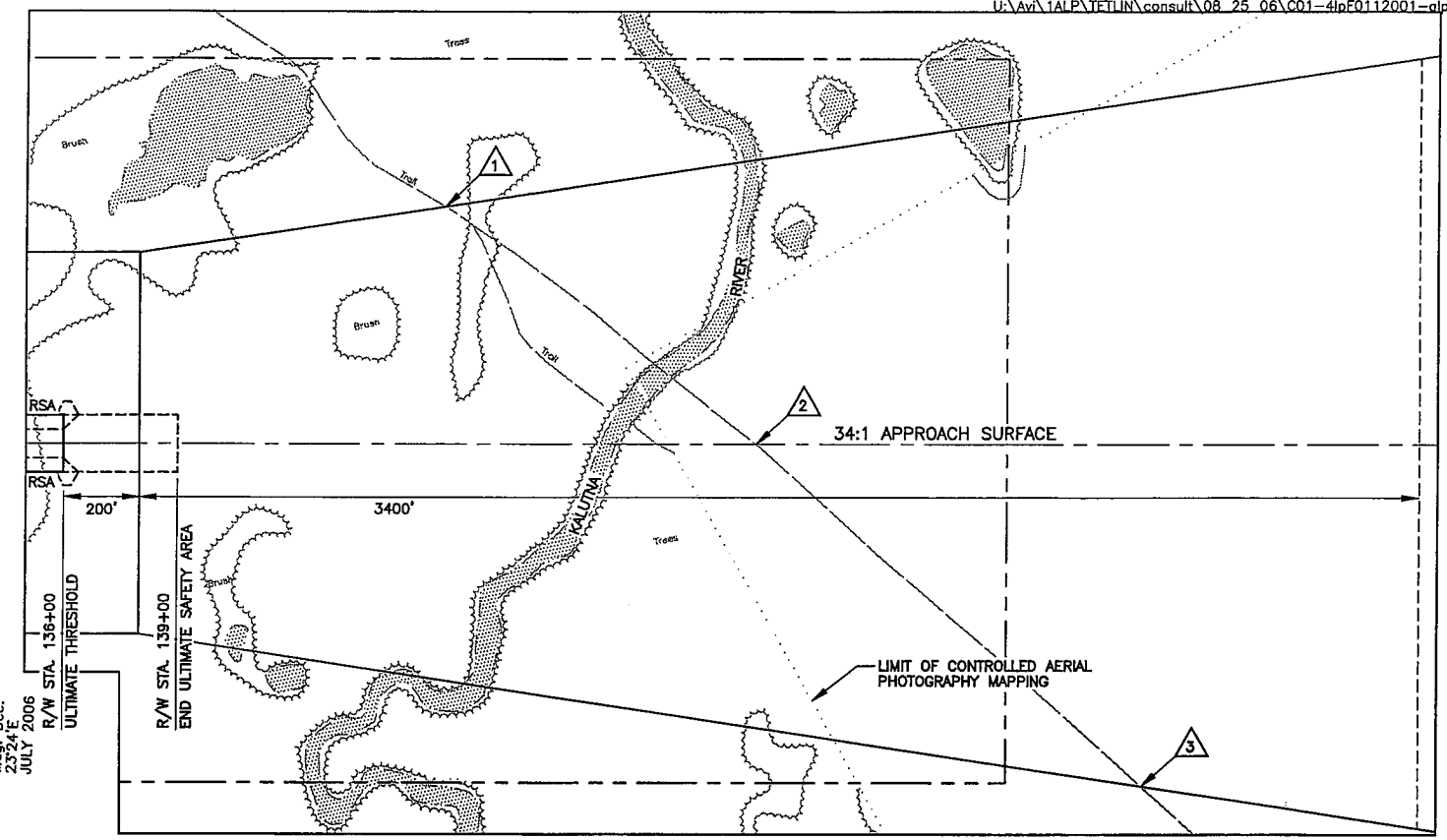

R/W 26 INNER APPROACH PLAN

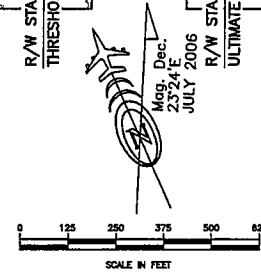

NOTES: MAPPING SHOWN, IS A COMBINATION OF CONTROLLED AERIAL PHOTOGRAPHY MAPPING AND THE USGS QUAD MAPS. TRAIL LOCATION ADJUSTED TO TRANSITION BETWEEN MAPPING SOURCES.

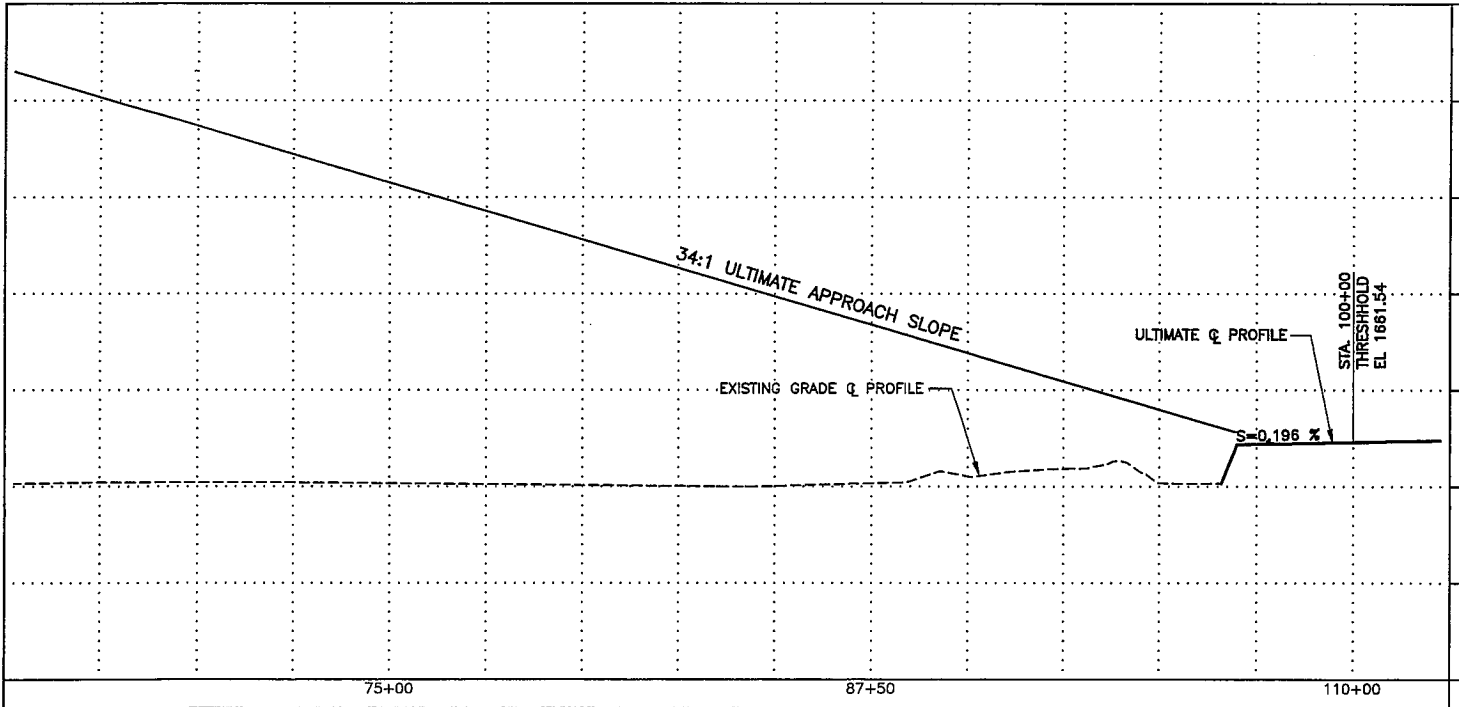

R/W 08 INNER APPROACH PROFILE

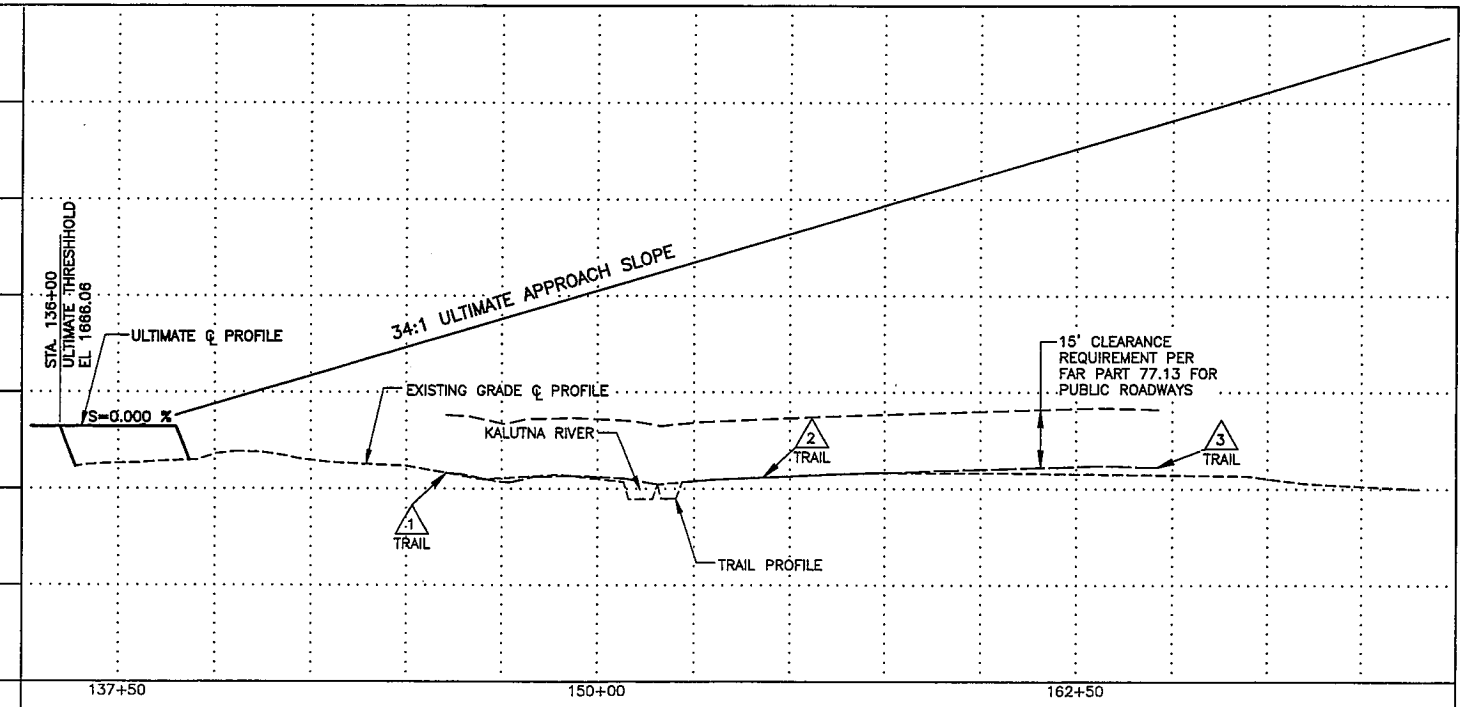

R/W 26 INNER APPROACH PROFILE

DESIGN		
DRAWN		
CHECKED		
BY	DATE	REVISIONS
RLC	7/31/06	AS-BUILT 1/16/2006
RLC	2/9/2000	FAA APPROVED

STATE OF ALASKA
 DEPARTMENT OF TRANSPORTATION AND PUBLIC FACILITIES
 NORTHERN REGION - DESIGN AND ENGINEERING SERVICES

APPROVED
Patricia D. Miller
 PATRICIA D. MILLER, P.E.

DATE 8/22/06
 DESIGN GROUP CHIEF

REVISED AIRPORT LAYOUT PLAN APPROVED
 BY LETTER DATED: 8/25/06

John T. Lovett
 AIRPORTS DIVISION,
 ALASKAN REGION, AAL-601
 AIRSPACE REVIEW #99AAL-062NRA

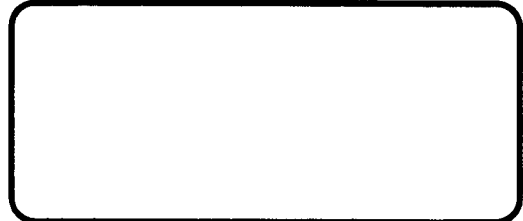

TETLIN AIRPORT
AIRPORT LAYOUT PLAN

INNER PORTION OF THE
 APPROACH SURFACE DRAWING

SHEET
2 OF
4

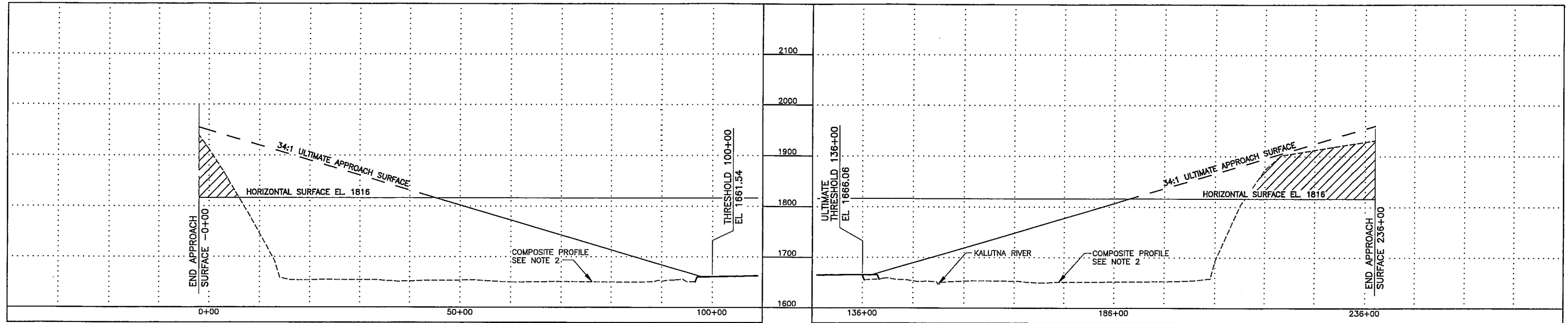

RUNWAY 08 APPROACH PROFILE

RUNWAY 26 APPROACH PROFILE

NOTES:

1. SEE SHEET 4 OF 4 FOR AIRSPACE PLAN.
2. THE EXISTING GROUND PROFILE ALONG THE EXTENDED RUNWAY CENTERLINE REPRESENTS THE COMPOSITE PROFILE BASED ON THE HIGHEST TERRAIN ACROSS THE WIDTH AND ALONG THE LENGTH OF THE APPROACH SURFACE.

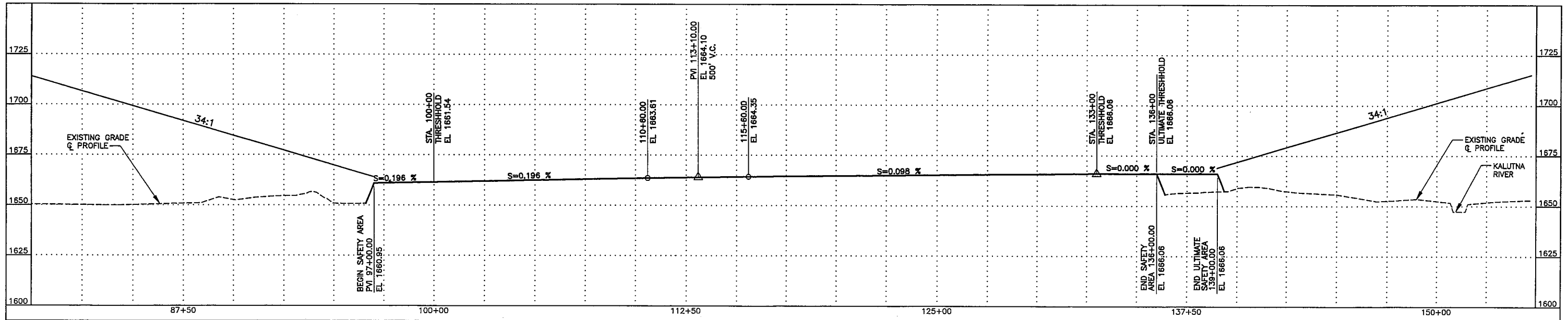

RUNWAY 08/26 PROFILE

DESIGN		
DRAWN		
CHECKED		
BY	DATE	REVISIONS
RLC	7/31/06	AS-BUILT 1/16/2006
RLC	2/9/2000	FAA APPROVED

STATE OF ALASKA
 DEPARTMENT OF TRANSPORTATION AND PUBLIC FACILITIES
 NORTHERN REGION - DESIGN AND ENGINEERING SERVICES

APPROVED
Patricia D. Miller DATE 8/22/06
 PATRICIA D. MILLER, P.E. DESIGN GROUP CHIEF

REVISED AIRPORT LAYOUT PLAN APPROVED
 BY LETTER DATED: 8/25/06

John J. Lovett
 AIRPORTS DIVISION,
 ALASKAN REGION, AAL-601
 AIRSPACE REVIEW #99AAL-062NRA

**TETLIN AIRPORT
 AIRPORT LAYOUT PLAN**

**RUNWAY AND APPROACH
 PROFILES DRAWING**

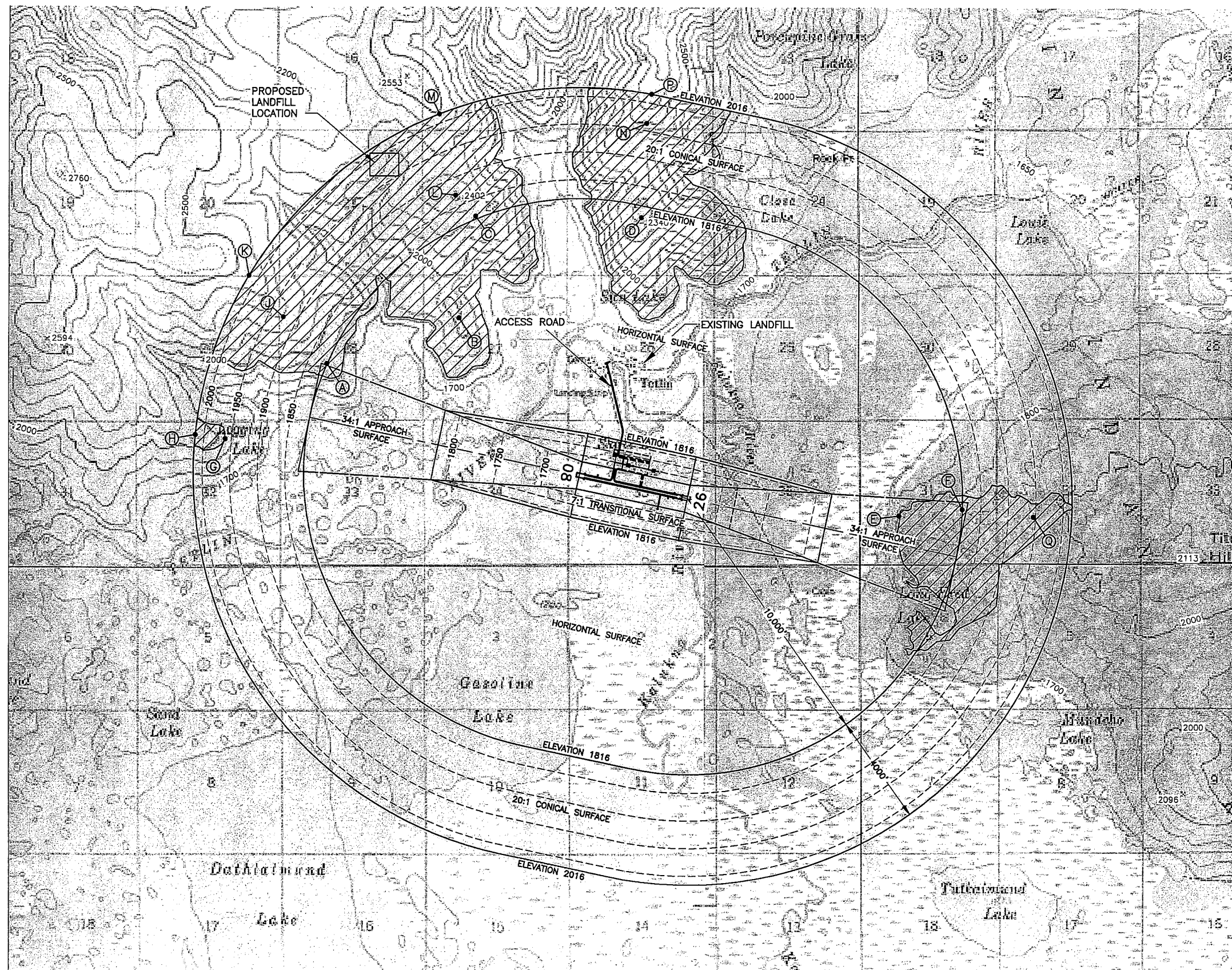

OBSTRUCTION TABLE			
TAG	OBSTRUCTION	ELEVATION	AMOUNT OF PENETRATION
(A)	HORIZONTAL SURFACE PENETRATION	1900	87'
(B)	HORIZONTAL SURFACE PENETRATION	2000	187'
(C)	HORIZONTAL SURFACE PENETRATION	2250	437'
(D)	HORIZONTAL SURFACE PENETRATION	2340	527'
(E)	HORIZONTAL SURFACE PENETRATION	1813	0'
(F)	HORIZONTAL SURFACE PENETRATION	1900	87'
(G)	CONICAL SURFACE PENETRATION	1958	0'
(H)	CONICAL SURFACE PENETRATION	2050	37'
(J)	CONICAL SURFACE PENETRATION	2300	377'
(K)	CONICAL SURFACE PENETRATION	2450	437'
(L)	CONICAL SURFACE PENETRATION	2402	543'
(M)	CONICAL SURFACE PENETRATION	2500	487'
(N)	CONICAL SURFACE PENETRATION	2500	547'
(P)	CONICAL SURFACE PENETRATION	2650	637'
(Q)	CONICAL SURFACE PENETRATION	1950	2'

RUNWAY 08 THRESHOLD ELEVATION = 1661.54
 RUNWAY 26 THRESHOLD ELEVATION = 1666.06

- PENETRATION OF HORIZONTAL OR CONICAL SURFACE
- PENETRATION OF 34:1 APPROACH SURFACE (NONE)

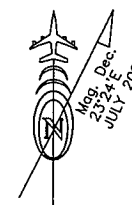

10 1000 2000 3000 4000 5000
 SCALE IN FEET

DESIGN _____
 DRAWN _____
 CHECKED _____

BY	DATE	REVISIONS
RLC	7/31/06	AS-BUILT 1/16/2006
RLC	2/9/2000	FAA APPROVED

STATE OF ALASKA
 DEPARTMENT OF TRANSPORTATION AND PUBLIC FACILITIES
 NORTHERN REGION - DESIGN AND ENGINEERING SERVICES
 APPROVED
Patricia D. Miller
 PATRICIA D. MILLER, P.E. DATE 8/22/06
 DESIGN GROUP CHIEF

REVISED AIRPORT LAYOUT PLAN APPROVED
 BY LETTER DATED: 8/25/06
John J. Lovett
 AIRPORTS DIVISION,
 ALASKAN REGION, AAL-601
 AIRSPACE REVIEW #99AAL-062NRA

TETLIN AIRPORT
AIRPORT LAYOUT PLAN
 AIRSPACE AND
 OBSTRUCTIONS DRAWING

SHEET
4 OF
4