



U.S. Department
of Transportation
**Federal Aviation
Administration**

Alaskan Region Airports Division

222 W. 7th Avenue, #14
Anchorage, Alaska 99513-7587
Tel. (907) 271-5438 / Fax (907) 271-2851

June 24, 2019

Jourde Mitchell
ADOT&PF Aviation Design
4111 Aviation Ave
Anchorage, AK 99519-6900

Dear Ms. Mitchell:

**Koliganek Airport
Koliganek, Alaska
As-Built Airport Layout Plan (5 June 2019)
(Original ALP Airspace #2011-AAL-50-NRA)**

We have completed our review of the Koliganek Airport As-Built Airport Layout Plan (ALP) dated 5 June, 2019, and find it acceptable for documenting the existing conditions of the airport.

Please retain this letter in your files for future reference.

Sincerely,

Pat Zettler, P.E., Lead Engineer
Airports Division

Date Plotted: 16/05/2019, 1:00 PM
 Designed By: [Redacted]
 Drawn By: [Redacted]
 Checked By: [Redacted]
 File Name: W:\Projects\KOLIGANEK ALP ALP 2016\Data\Sheet.dwg

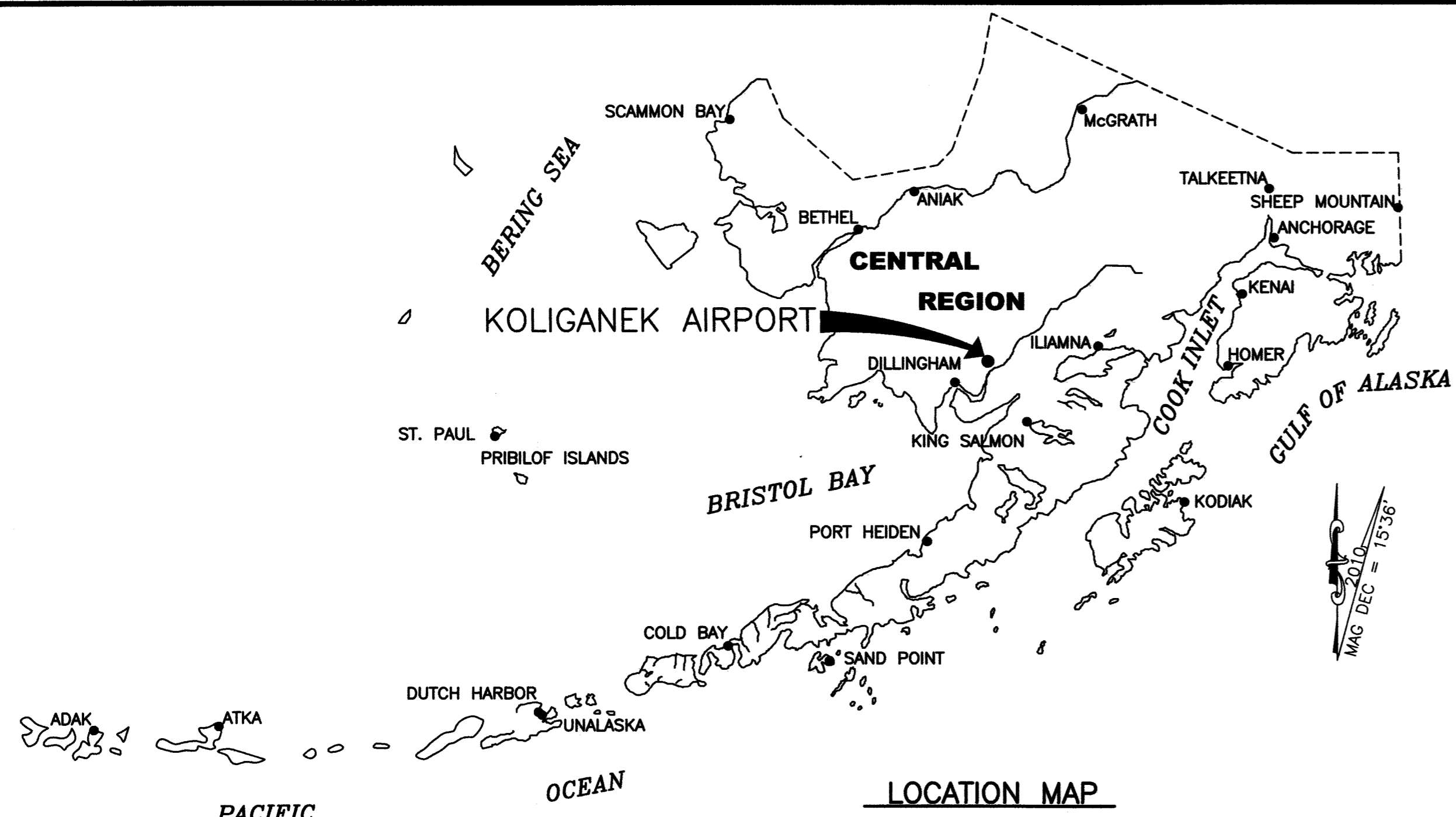

LEGEND		
ITEM	EXISTING	ULTIMATE
AIRPORT REFERENCE POINT (A.R.P.)		
ANTENNA		
BLUFF		
BUILDINGS		
BUILDING RESTRICTION LINE		
FENCE		
PAPI		
PROPERTY LINE		
REIL		
ROADWAYS		
ROTATING BEACON		
SHORELINE		
SURVEY MONUMENT		
THRESHOLD MARKERS/LIGHTS		
TOPOGRAPHIC CONTOURS		
TREE (LARGE SINGLE)		
TREELINE		
WIND CONE		
WIND CONE AND SEGMENTED CIRCLE		

AIRPORT DATA TABLE		
ITEM	EXISTING	ULTIMATE
ICAO IDENTIFIER	PAJ2	PAJ2
NATIONAL AIRPORT IDENTIFIER	JZZ	JZZ
FAA SITE NUMBER	50426.4*A	50426.4*A
AIRPORT ELEVATION NAVD88	271.8	291.1
AIRPORT REFERENCE CODE	B II(S)	B II(S)
MEAN MAX. TEMPERATURE, HOTTEST MONTH	64°F JULY	64°F JULY
AIRPORT AND TERMINAL NAVIGATION AIDS	ROTATING BEACON AWOS	ROTATING BEACON AWOS
TAXIWAY LIGHTING/MARKING	M.I. / NONE	M.I. / NONE
OBSTRUCTION SURVEY SOURCE & TYPE	NVG	NVG
MAGNETIC DECLINATION, YEAR, RATE OF CHANGE	15°36'E, 2010, 0°15'(W)/YEAR	

RUNWAY 9/27 DATA TABLE		
ITEM	EXISTING	ULTIMATE
RUNWAY TYPE UTILITY OR OTHER THAN UTILITY	UTILITY	UTILITY
FAR PART 77 APPROACH CATEGORY (V, NPI, P)	NPI / NPI	NPI / NPI
APPROACH SURFACES	20:1 / 20:1	20:1 / 20:1
VISIBILITY MINIMUM	1 SM	1 SM
RUNWAY SURFACE	GRAVEL	GRAVEL
PAVEMENT STRENGTH SW,DW,DTW,DDTW x1000lbs	N/A	N/A
AIRCRAFT APPROACH CATEGORY	B	B
AIRPLANE DESIGN GROUP	II(S)	II(S)
TRUE BEARING	N74° 07' 10.21"W	N74° 45' 49.35"W
EFFECTIVE GRADE	1.07%	1.07%
TOUCHDOWN ELEVATION NAVD88	268.8/271.8	272.1/273.6
RUNWAY DIMENSIONS	75 x 3300	75 x 3300
RUNWAY SAFETY AREA (RSA) DIMENSIONS	150 x 3900	150 x 3900
LENGTH BEYOND R/W END	300 / 300	300 / 300
RUNWAY PROTECTION ZONE (RPZ) DIMENSIONS	250 x 450 x 1000	250 x 450 x 1000
RUNWAY OBJECT FREE AREA (OFA) DIMENSIONS	500 x 3900	500 x 3900
LENGTH BEYOND R/W END OR STOPWAY	300 / 300	300 / 300
RUNWAY OBSTACLE FREE ZONE (OFZ) DIMENSIONS	250 x 3700	250 x 3700
RUNWAY LIGHTING	M.I.	M.I.
RUNWAY MARKING TYPE	NONE	NONE
RUNWAY VISUAL APPROACH AIDS	PAPI	PAPI, REIL

RUNWAY 17/35 DATA TABLE		
ITEM	EXISTING	ULTIMATE
RUNWAY TYPE UTILITY OR OTHER THAN UTILITY	UTILITY	UTILITY
FAR PART 77 APPROACH CATEGORY (V, NPI, P)	NPI / NPI	NPI / NPI
APPROACH SURFACES	20:1 / 20:1	20:1 / 20:1
VISIBILITY MINIMUM	1 SM	1 SM
RUNWAY SURFACE	GRAVEL	GRAVEL
PAVEMENT STRENGTH SW,DW,DTW,DDTW x1000lbs	N/A	N/A
AIRCRAFT APPROACH CATEGORY	B	B
AIRPLANE DESIGN GROUP	II(S)	II(S)
TRUE BEARING	N10° 00' 00"E	N10° 00' 00"E
EFFECTIVE GRADE	1.2%	1.2%
TOUCHDOWN ELEVATION NAVD88	291.1/291.1	291.1/291.1
RUNWAY DIMENSIONS	75 x 3300	75 x 3300
RUNWAY SAFETY AREA (RSA) DIMENSIONS	150 x 3900	150 x 3900
LENGTH BEYOND R/W END	300 / 300	300 / 300
RUNWAY PROTECTION ZONE (RPZ) DIMENSIONS	250 x 450 x 1000	250 x 450 x 1000
RUNWAY OBJECT FREE AREA (OFA) DIMENSIONS	500 x 3900	500 x 3900
LENGTH BEYOND R/W END OR STOPWAY	300 / 300	300 / 300
RUNWAY OBSTACLE FREE ZONE (OFZ) DIMENSIONS	250 x 3700	250 x 3700
RUNWAY LIGHTING	M.I.	M.I.
RUNWAY MARKING TYPE	NONE	NONE
RUNWAY VISUAL APPROACH AIDS	PAPI, REIL	PAPI, REIL

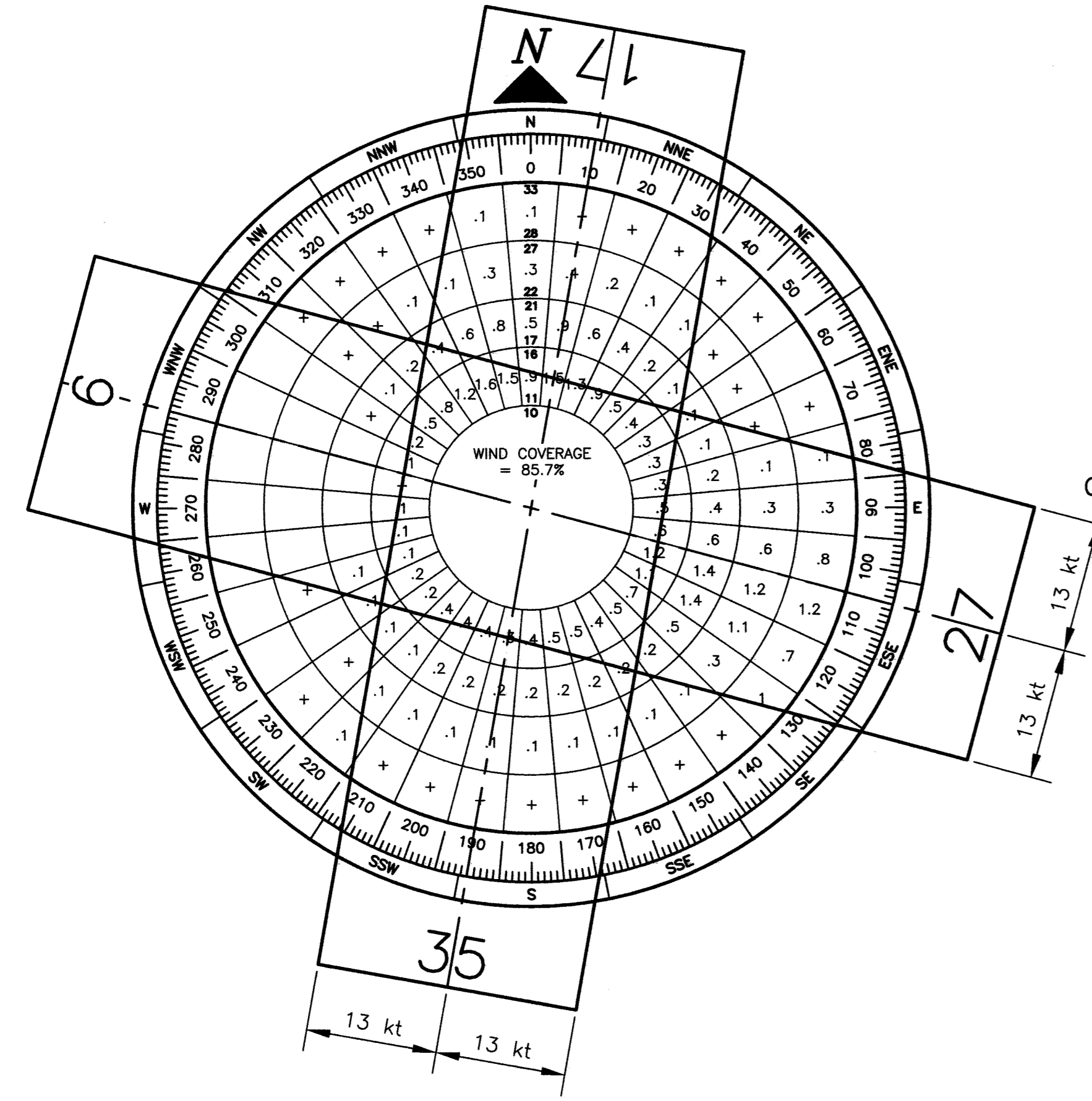

GEOGRAPHIC COORDINATES TABLE				
ITEM	EXISTING LATITUDE	EXISTING LONGITUDE	ULTIMATE LATITUDE	ULTIMATE LONGITUDE
ARP	N59°43'36.32"	W157°15'36.92"	N59°43'38.71"	W157°15'32.64"
THRESHOLD RW 9	N59°43'40.76"	W157°16'07.87"	N59°43'40.72"	W157°16'07.96"
THRESHOLD RW 27	N59°43'31.87"	W157°15'05.97"	N59°43'31.82"	W157°15'06.06"
THRESHOLD RW 17	N59°43'57.11"	N59°43'57.11"	N59°43'57.11"	W157°15'22.33"
THRESHOLD RW 35			N59°43'25.17"	W157°15'34.22"

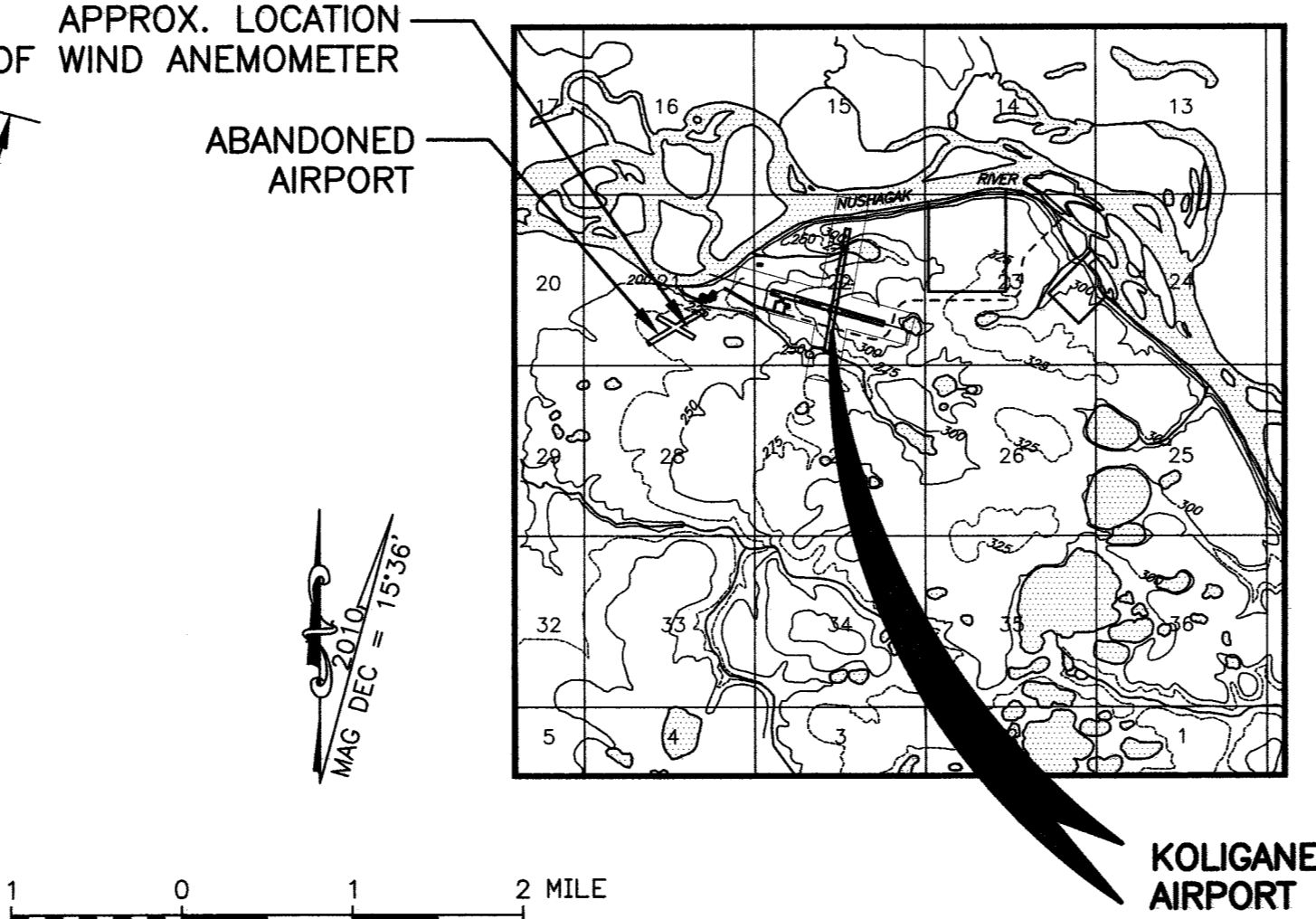

VICINITY MAP
 T 5 S, R 47 W, SEC 22
 SEWARD MERIDIAN
 U.S.G.S. DILLINGHAM (C-4), ALASKA

NOTE:
 COORDINATES, DIMENSIONS, & ELEVATIONS ARE IN US SURVEY FEET UNLESS OTHERWISE SPECIFIED

BY	DATE	REVISION
	06/2018	AS-BUILT PER AKSAS 59276

APPROVED: _____ **DATE:** _____
K. KIM RICE, P.E. **PRECONSTRUCTION ENGINEER**
RECOMMENDED: _____ **DATE:** _____
HARVEY M. DOUTHIT, P.E. **DESIGN SECTION CHIEF**

AIRPORT LAYOUT PLAN CONDITIONAL APPROVAL SUBJECT TO ALP APPROVAL LETTER DATED 9/1/11
 FAA AIRSPACE REVIEW NUMBER: 70W-ADL-50-NRA
AS-BUILT ACCEPTED
 DATE: 6/27/19
 FAA, AIRPORTS DIVISION ALASKAN REGION, AAL

DRAWING INDEX	
SHT #	TITLE
1	DATA
2	EXISTING LAYOUT
3	ULTIMATE LAYOUT
4	EXISTING INNER PORTION OF THE APPROACH SURFACES
5	ULTIMATE INNER PORTION OF THE APPROACH SURFACES
6	EXISTING INNER PORTION OF THE APPROACH SURFACES
7	ULTIMATE INNER PORTION OF THE APPROACH SURFACES
8	AIRPORT AIRSPACE, 14 CFR PART 77
9	AIRPORT AIRSPACE PROFILES
10	AIRPORT PROPERTY MAP

STATE OF ALASKA
DEPARTMENT OF TRANSPORTATION
AND PUBLIC FACILITIES
CENTRAL REGION

KOLIGANEK AIRPORT
 KOLIGANEK, ALASKA
 AIRPORT LAYOUT PLAN
 DATA

DATE: 6/5/2019
 SHEET: 1 OF 9

SOURCE: ARCTIC ENVIRONMENTAL INFORMATION AND DATA CENTER, UNIVERSITY OF ALASKA, ANCHORAGE. THE ANEMOMETER WAS LOCATED AT THE OLD AIRPORT APPROXIMATELY 0.5 MILES FROM THE EXISTING AIRPORT (SEE VICINITY MAP) THE ANEMOMETER WAS MOUNTED ON A 10 FT TOWER AND DATA ADJUSTED TO 30 FT
 PERIOD: 09/01/91 - 08/31/92

Date Plotted: 6/05/2019, 1:00 PM
 Layout Name: Near_Term
 File Name: W:\Projects\KolikaneK\ALP\ALP_2019\ALP_Plan.dwg
 Designed By: rkbryant
 Drawn By: rkbryant
 Checked By:

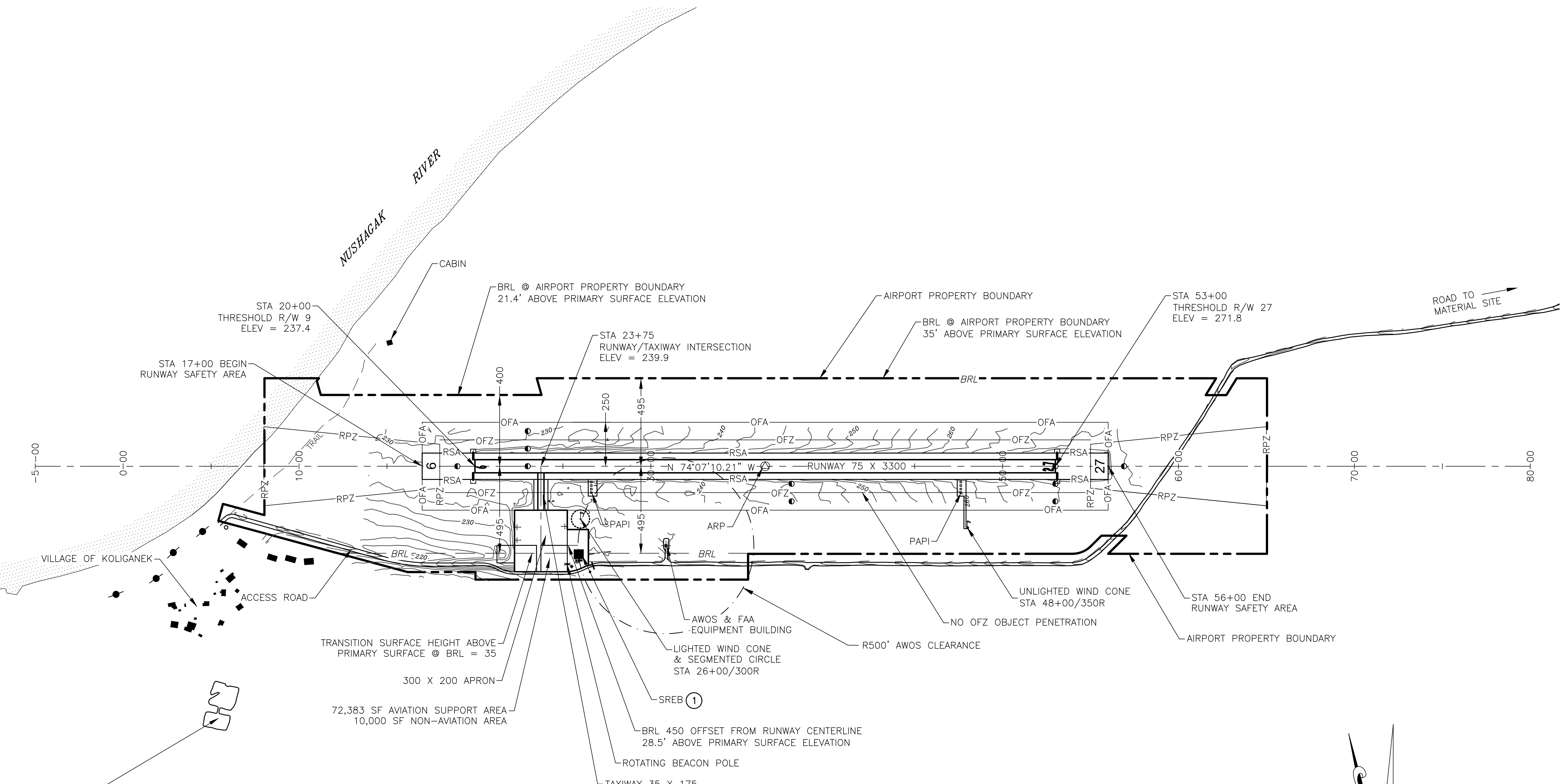

BUILDING DATA TABLE				
ID #	DESCRIPTION	STATION/OFFSET	TOP ELEV (MSL)	OBSTRUCT MARKING
1	SRE BUILDING	25+64/475R	258.71	NONE

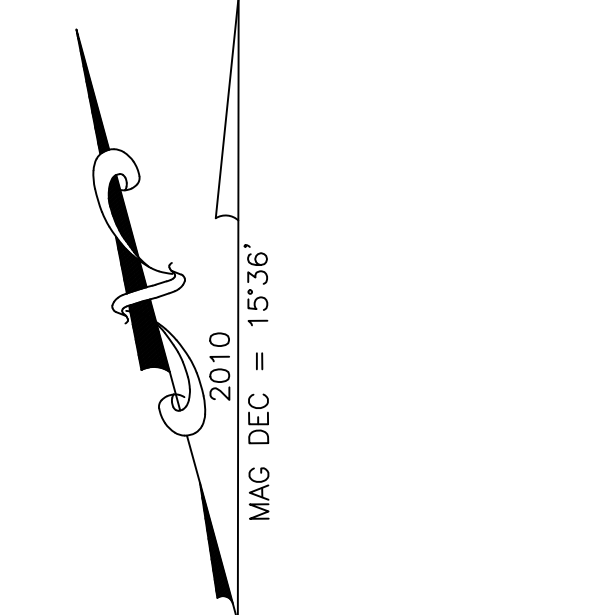

STATE OF ALASKA DEPARTMENT OF TRANSPORTATION AND PUBLIC FACILITIES CENTRAL REGION			KOLIGANEK AIRPORT KOLIGANEK, ALASKA AIRPORT LAYOUT PLAN EXISTING LAYOUT		DATE: 4/12/2019 SHEET: 2 OF 9
BY	DATE	REVISION			
	06/2018	AS-BUILT PER AKSAS 59276			

Date Plotted: 6/05/2019, 1:00 PM
 Layout Name: Ultimate
 File Name: W:\Projects\Koliganek\ALP\ALP_2018\ALP_Plan.dwg
 Designed By: rkbryant
 Drawn By: rkbryant
 Checked By:

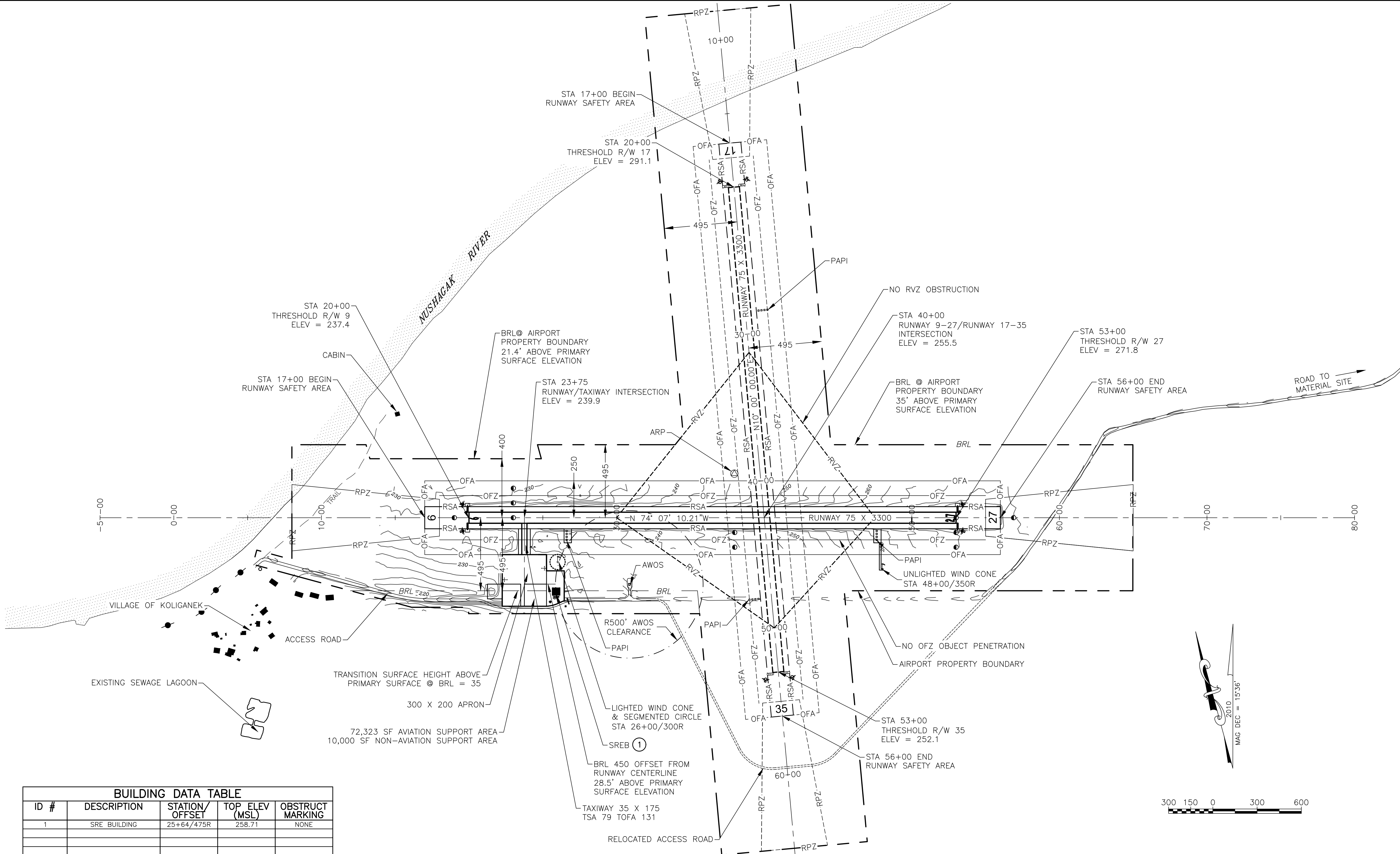

BUILDING DATA TABLE

ID #	DESCRIPTION	STATION/OFFSET	TOP ELEV (MSL)	OBSTRUCT MARKING
1	SRE BUILDING	25+64/475R	258.71	NONE

BY	DATE	REVISION
	06/2018	AS-BUILT PER AKSAS 59276

STATE OF ALASKA
DEPARTMENT OF TRANSPORTATION
AND PUBLIC FACILITIES
CENTRAL REGION

KOLIGANEK AIRPORT
 KOLIGANEK, ALASKA
 AIRPORT LAYOUT PLAN
 ULTIMATE LAYOUT

DATE: 4/12/2019
 SHEET: 3 OF 9

6/05/2019, 1:00 PM
 Near Term
 W:\Projects\Koliganek\ALP\ALP_2016\ALP_Plan.dwg
 Date Plotted: 6/05/2019, 1:00 PM
 Layout Name: Near Term
 File Name: W:\Projects\Koliganek\ALP\ALP_2016\ALP_Plan.dwg
 Designed By: rkbjgall
 Drawn By: rkbjgall
 Checked By:

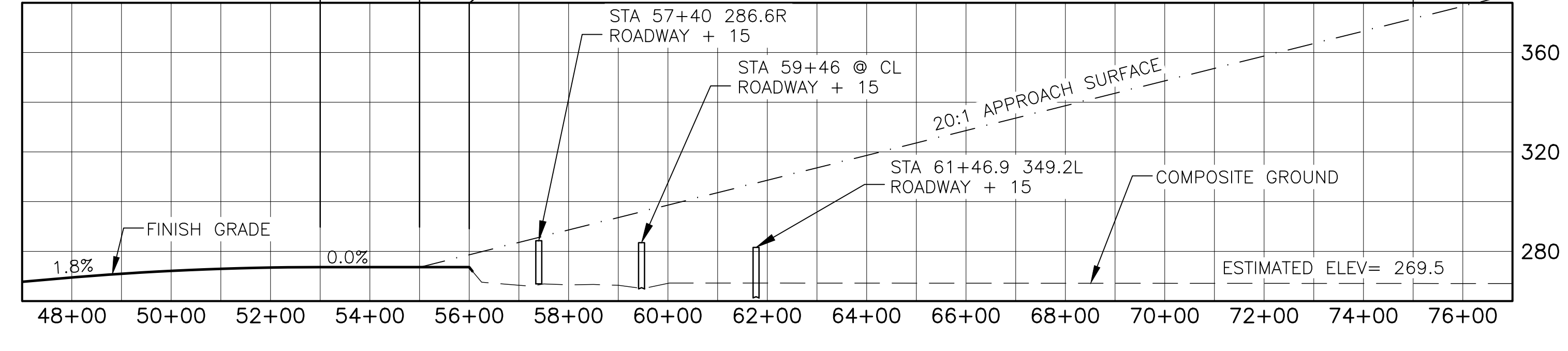
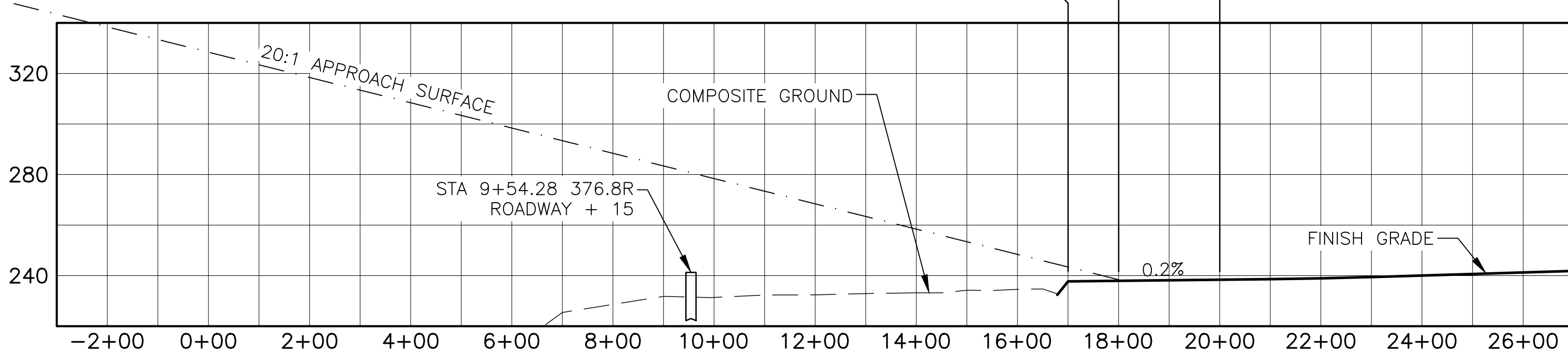
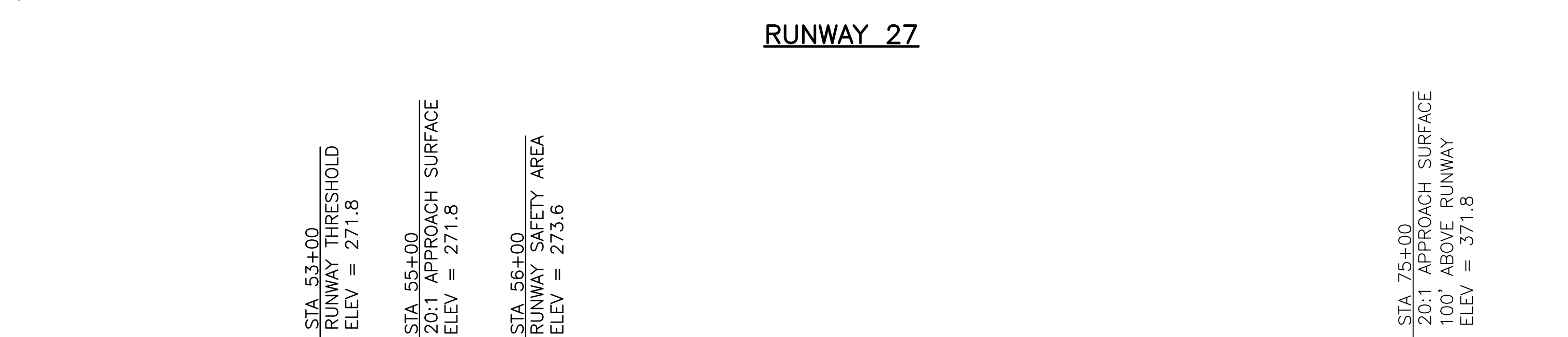
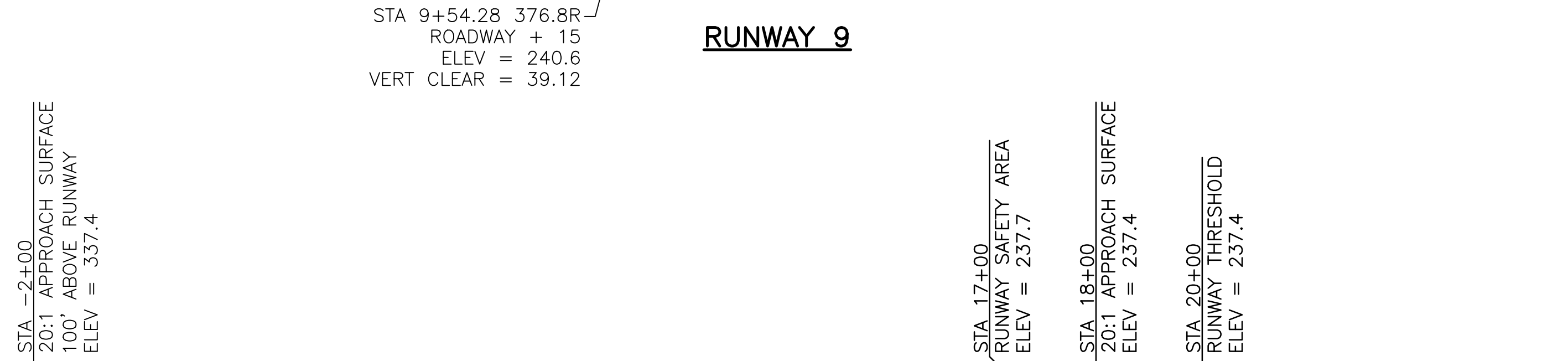
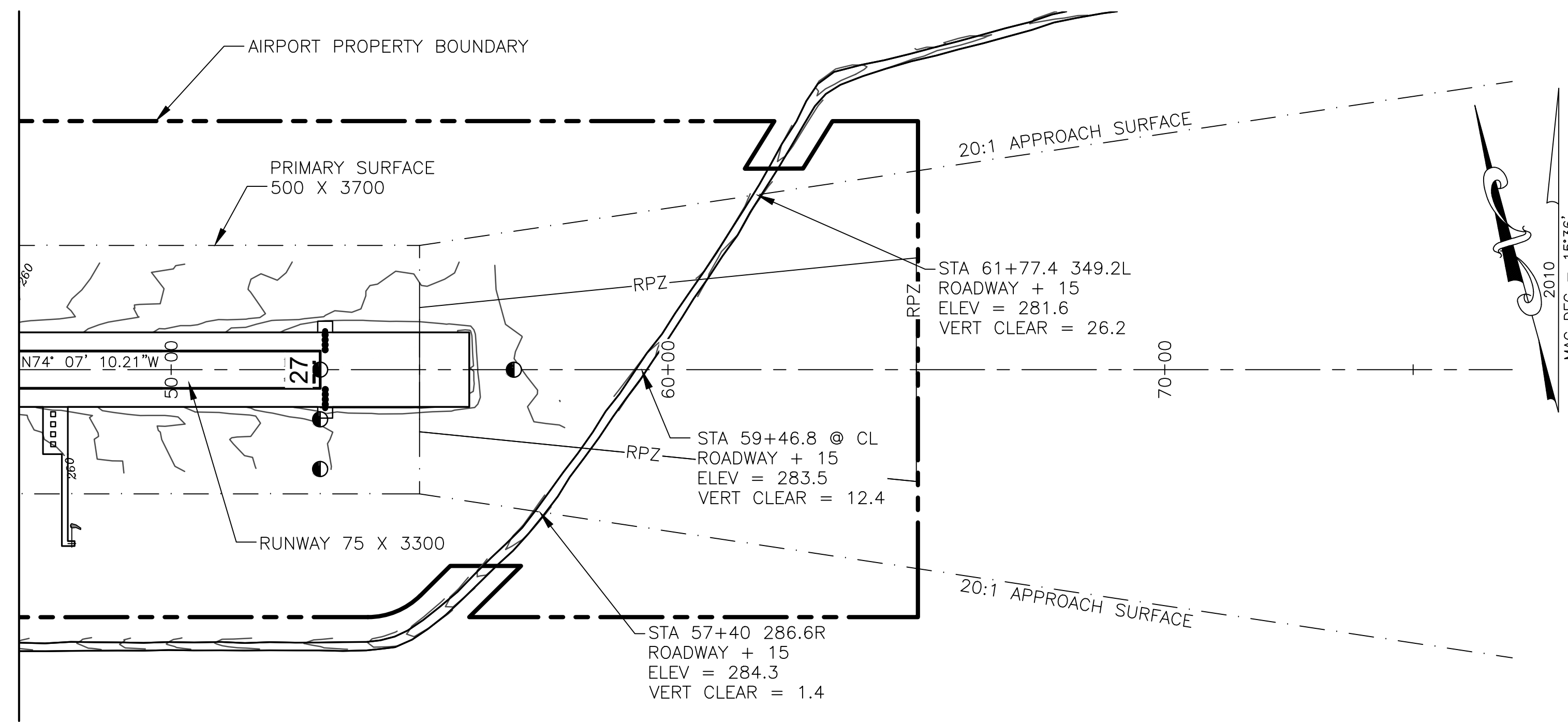
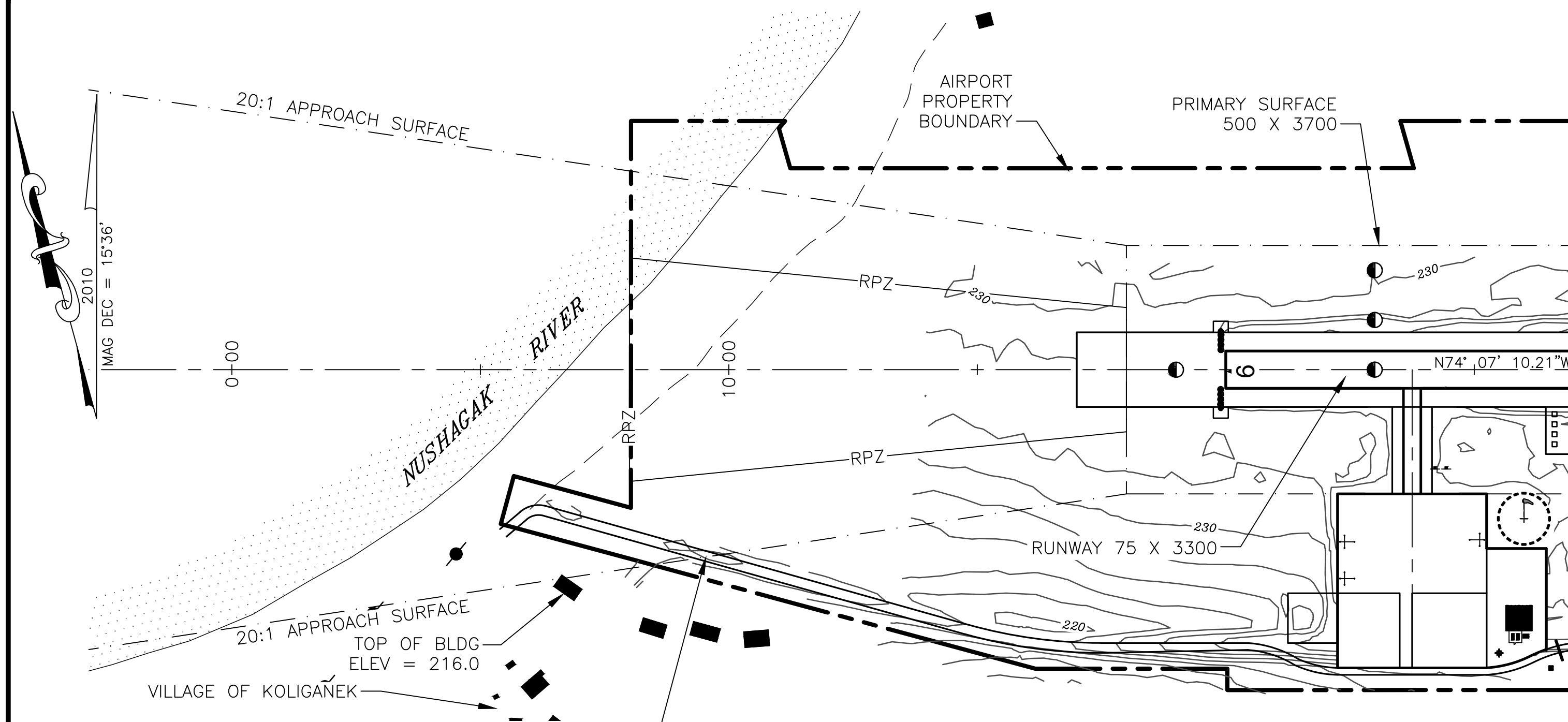

PART 77 SURFACE OBSTRUCTION TABLE (INNER PORTION RW 9)

ID #	DESCRIPTION	STATION/OFFSET	ELEVATION	SURFACE PENETRATED	SURFACE ELEVATION	AMOUNT PENETRATION	DISPOSITION	STAGE TO CORRECT
	NONE							

PART 77 SURFACE OBSTRUCTION TABLE (INNER PORTION RW 27)

ID #	DESCRIPTION	STATION/OFFSET	ELEVATION	SURFACE PENETRATED	SURFACE ELEVATION	AMOUNT PENETRATION	DISPOSITION	STAGE TO CORRECT
	NONE							

NOTE: REFER TO THE AIRPORT AIRSPACE DRAWING FOR PENETRATIONS OF THE OUTER APPROACH SURFACES

NOTE: REFER TO THE AIRPORT AIRSPACE DRAWING FOR PENETRATIONS OF THE OUTER APPROACH SURFACES

- NOTES:
- THERE ARE NO CONTROLLING OBSTRUCTIONS FOR RUNWAY 9, THEREFORE THE CONTROLLING OBSTRUCTION CLEARANCE SLOPE IS ESTABLISHED AS 20:1 PER FAA AC 150/5200-35A, CHAPTER 4, DATA ELEMENT NUMBER 57.
 - THERE ARE NO OBJECT PENETRATIONS IN THE RUNWAY APPROACH END SITING SURFACES OF RUNWAY 9, AS DEFINED IN FAA AC 150/5300-13A, TABLE 3-2, LINE 5.
 - THERE ARE NO THRESHOLD SITING SURFACE PENETRATIONS.

- NOTES:
- THERE ARE NO CONTROLLING OBSTRUCTION FOR RUNWAY 27. THEREFORE THE CONTROLLING OBSTRUCTION CLEARANCE SLOPE IS ESTABLISHED AS 20:1 PER FAA AC 150/5200-35A, CHAPTER 4, DATA ELEMENT NUMBER 57.
 - THERE ARE NO OBJECT PENETRATIONS IN THE RUNWAY APPROACH END SITING SURFACES OF RUNWAY 27, AS DEFINED IN FAA AC 150/5300-13A, TABLE 3-2, LINE 5.
 - THERE ARE NO THRESHOLD SITING SURFACE PENETRATIONS.

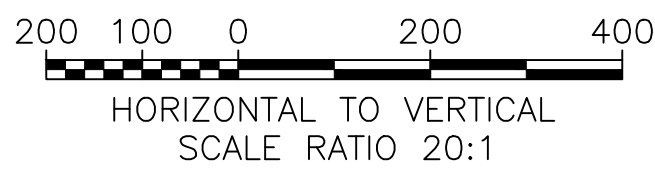

STATE OF ALASKA DEPARTMENT OF TRANSPORTATION AND PUBLIC FACILITIES CENTRAL REGION		KOLIGANEK AIRPORT KOLIGANEK, ALASKA AIRPORT LAYOUT PLAN EXISTING INNER PORTION OF THE APPROACH SURFACES		DATE: 4/12/2019 SHEET: 4 OF 9
BY	DATE	REVISION		
	06/2018	AS-BUILT PER AKSAS 59276		

6/05/2019, 1:00 PM
 Date Plotted: 6/05/2019, 1:00 PM
 Layout Name: W:\Projects\Koliganek\ALP\ALP_2016\ALP_Plan.dwg
 File Name: W:\Projects\Koliganek\ALP\ALP_2016\ALP_Plan.dwg
 Uti Inn App
 Designed By: rkbryant
 Drawn By: rkbryant
 Checked By:

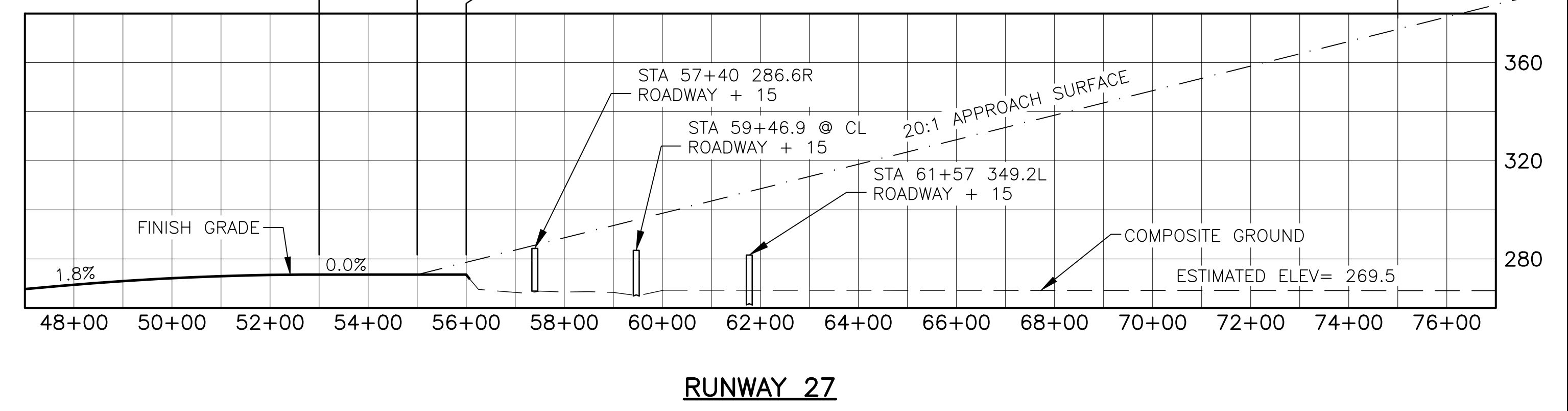
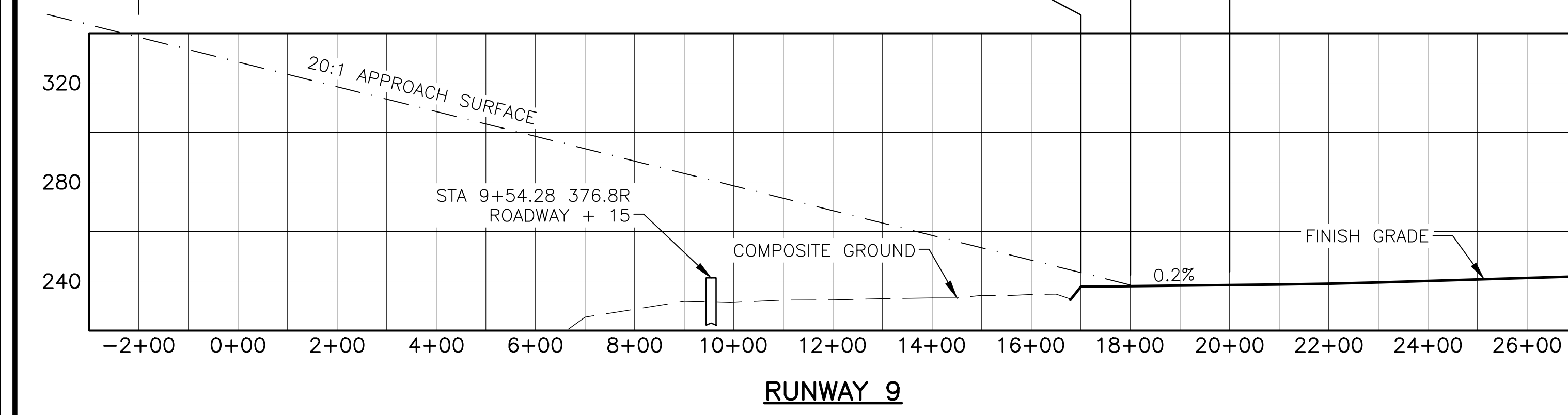
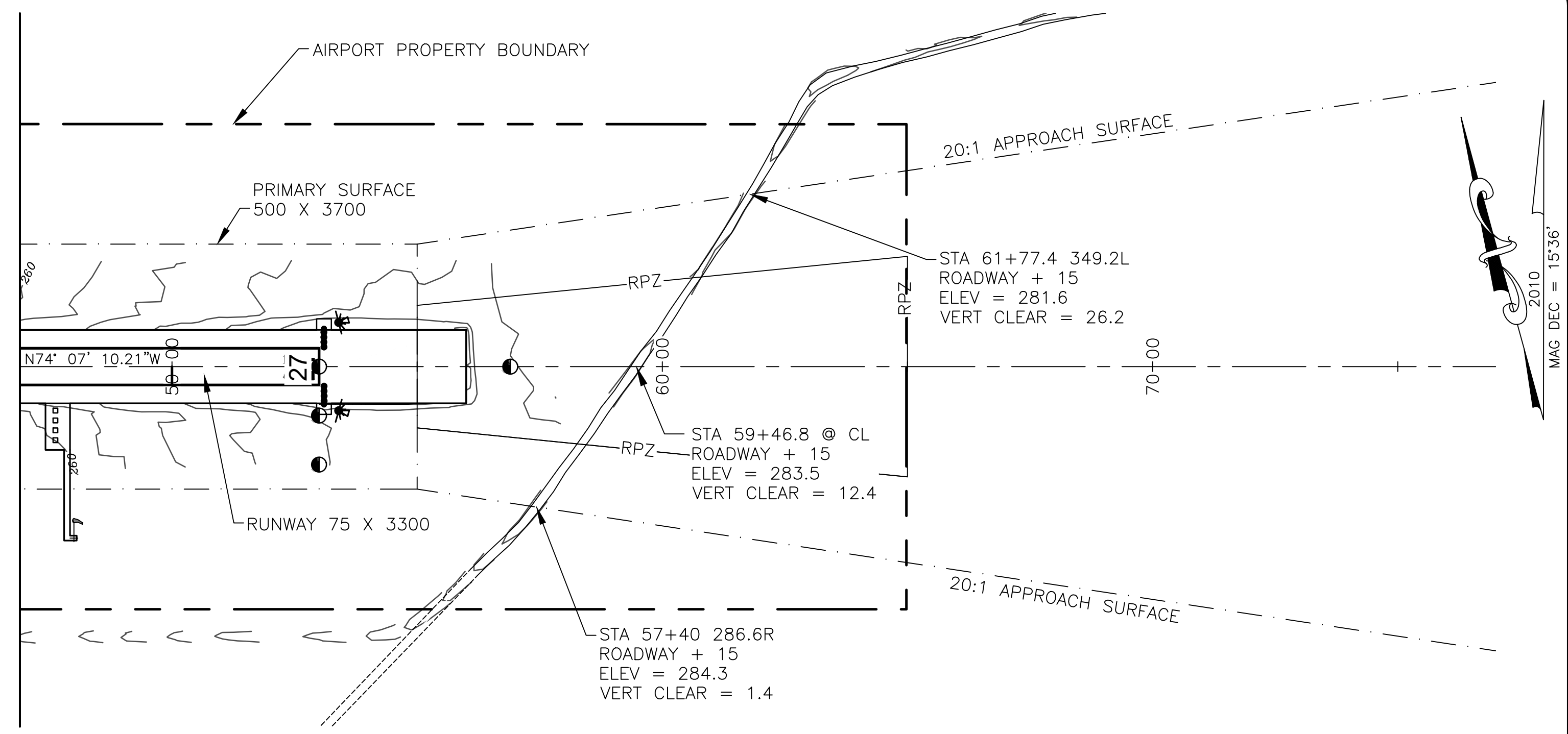
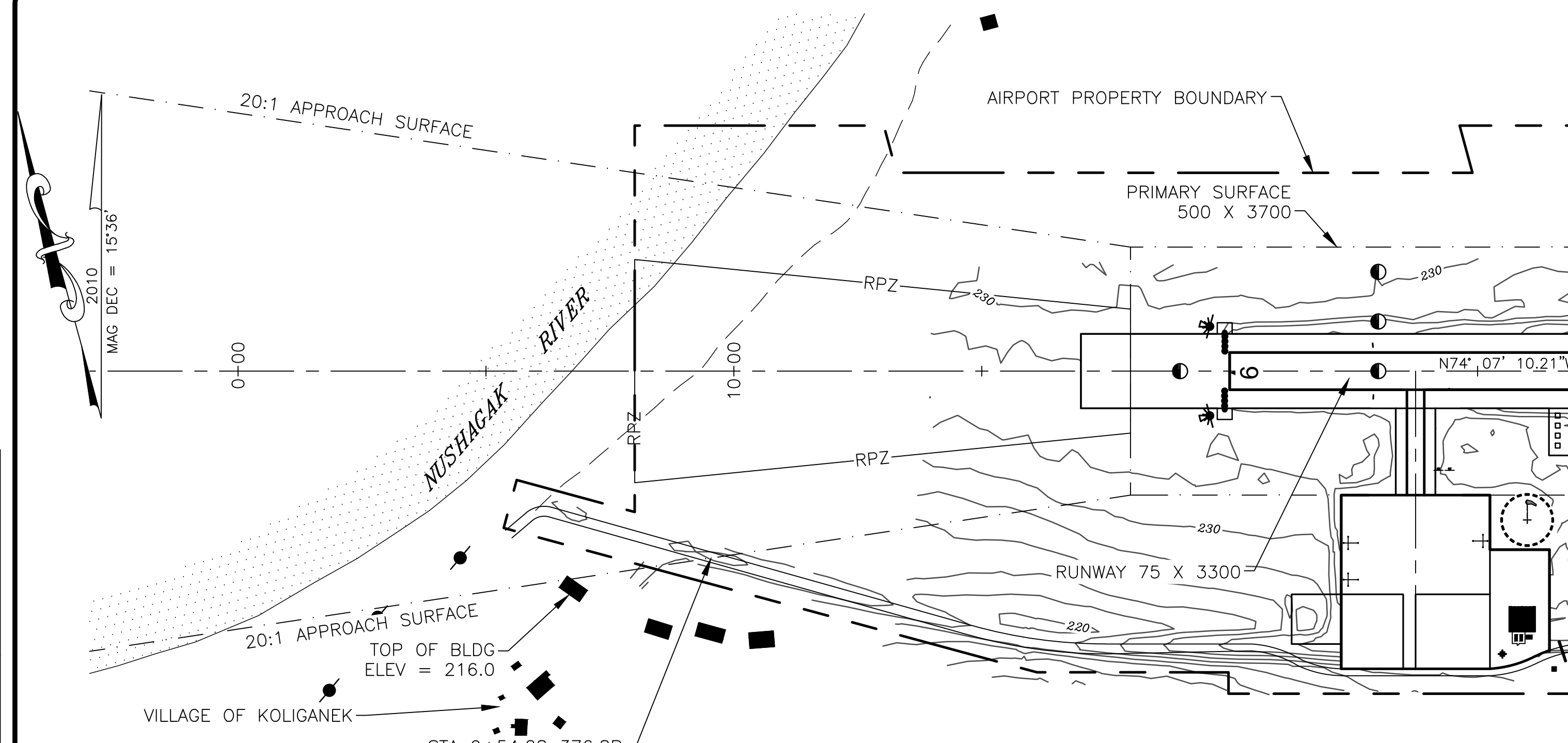

PART 77 SURFACE OBSTRUCTION TABLE (INNER PORTION RW 9)

ID #	DESCRIPTION	STATION/OFFSET	ELEVATION	SURFACE PENETRATED	SURFACE ELEVATION	AMOUNT PENETRATION	DISPOSITION	STAGE TO CORRECT
	NONE							

PART 77 SURFACE OBSTRUCTION TABLE (INNER PORTION RW 27)

ID #	DESCRIPTION	STATION/OFFSET	ELEVATION	SURFACE PENETRATED	SURFACE ELEVATION	AMOUNT PENETRATION	DISPOSITION	STAGE TO CORRECT
	NONE							

NOTE: REFER TO THE AIRPORT AIRSPACE DRAWING FOR PENETRATIONS OF THE OUTER APPROACH SURFACES

NOTE: REFER TO THE AIRPORT AIRSPACE DRAWING FOR PENETRATIONS OF THE OUTER APPROACH SURFACES

- NOTES:**
- THERE ARE NO CONTROLLING OBSTRUCTIONS FOR RUNWAY 9, THEREFORE THE CONTROLLING OBSTRUCTION CLEARANCE SLOPE IS ESTABLISHED AS 20:1 PER FAA AC 150/5200-35A, CHAPTER 4, DATA ELEMENT NUMBER 57.
 - THERE ARE NO OBJECT PENETRATIONS IN THE RUNWAY APPROACH END SITING SURFACES OF RUNWAY 9, AS DEFINED IN FAA AC 150/5300-13A, TABLE 3-2, LINE 5.
 - THERE ARE NO THRESHOLD SITING SURFACE PENETRATIONS.

- NOTES:**
- THERE ARE NO CONTROLLING OBSTRUCTION FOR RUNWAY 27, THEREFORE THE CONTROLLING OBSTRUCTION CLEARANCE SLOPE IS ESTABLISHED AS 20:1 PER FAA AC 150/5200-35A, CHAPTER 4, DATA ELEMENT NUMBER 57.
 - THERE ARE NO OBJECT PENETRATIONS IN THE RUNWAY APPROACH END SITING SURFACES OF RUNWAY 27, AS DEFINED IN FAA AC 150/5300-13A, TABLE 3-2, LINE 5.
 - THERE ARE NO THRESHOLD SITING SURFACE PENETRATIONS.

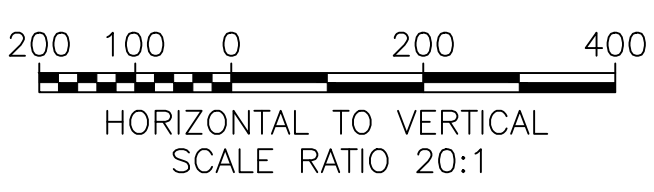

BY	DATE	REVISION
	06/2018	AS-BUILT PER AKSAS 59276

**STATE OF ALASKA
 DEPARTMENT OF TRANSPORTATION
 AND PUBLIC FACILITIES
 CENTRAL REGION**

KOLIGANEK AIRPORT
 KOLIGANEK, ALASKA
 AIRPORT LAYOUT PLAN
 ULTIMATE INNER PORTION
 OF THE APPROACH SURFACES
 RUNWAY 9/27

DATE: 4/12/2019
 SHEET: 5 OF 9

Date Plotted: 6/05/2019, 1:00 PM
 Layout Name: W:\Projects\koliganek\ALP\ALP_2018\ALP_Plan.dwg
 File Name:
 Designed By: rkbryant
 Drawn By: rkbryant
 Checked By:

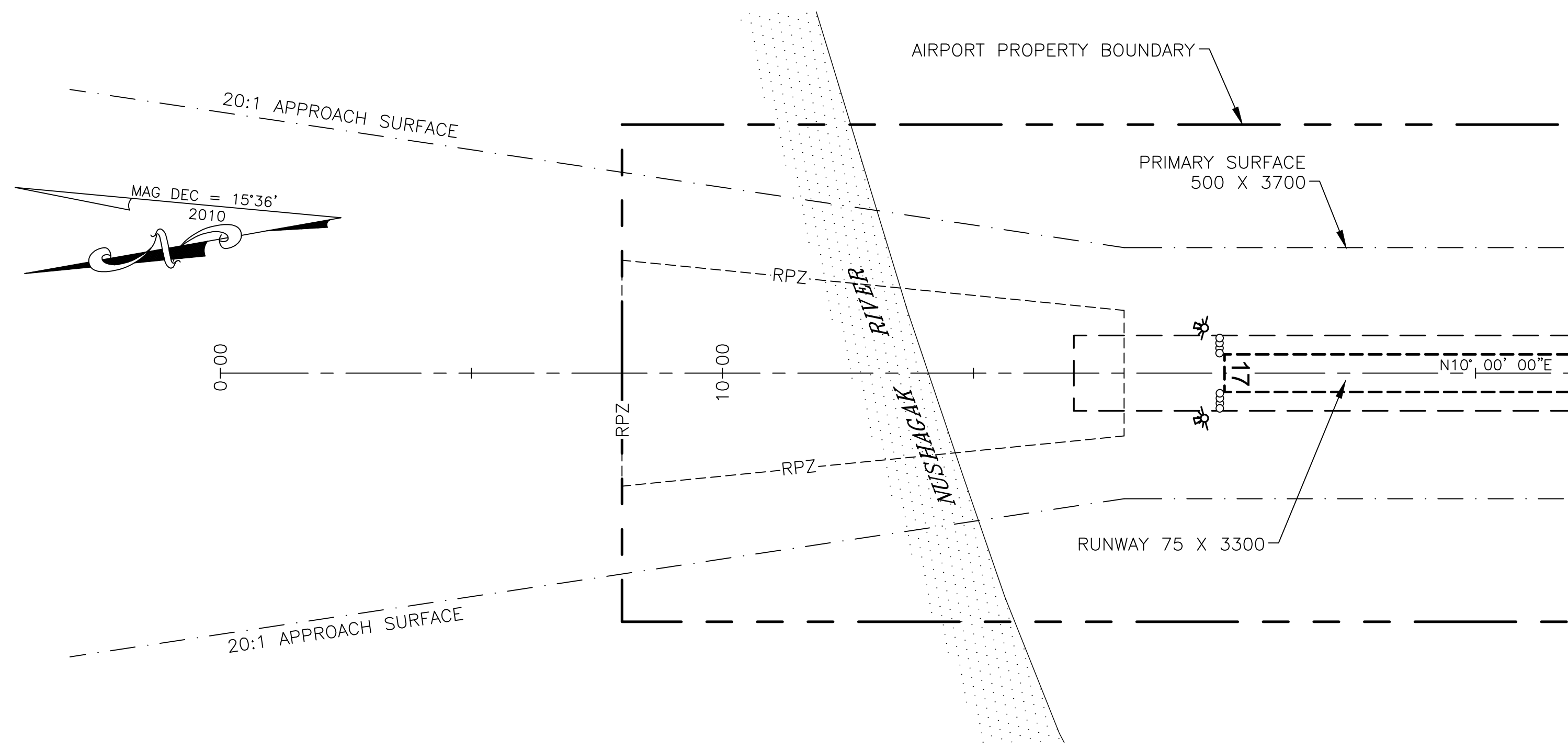

RUNWAY 17

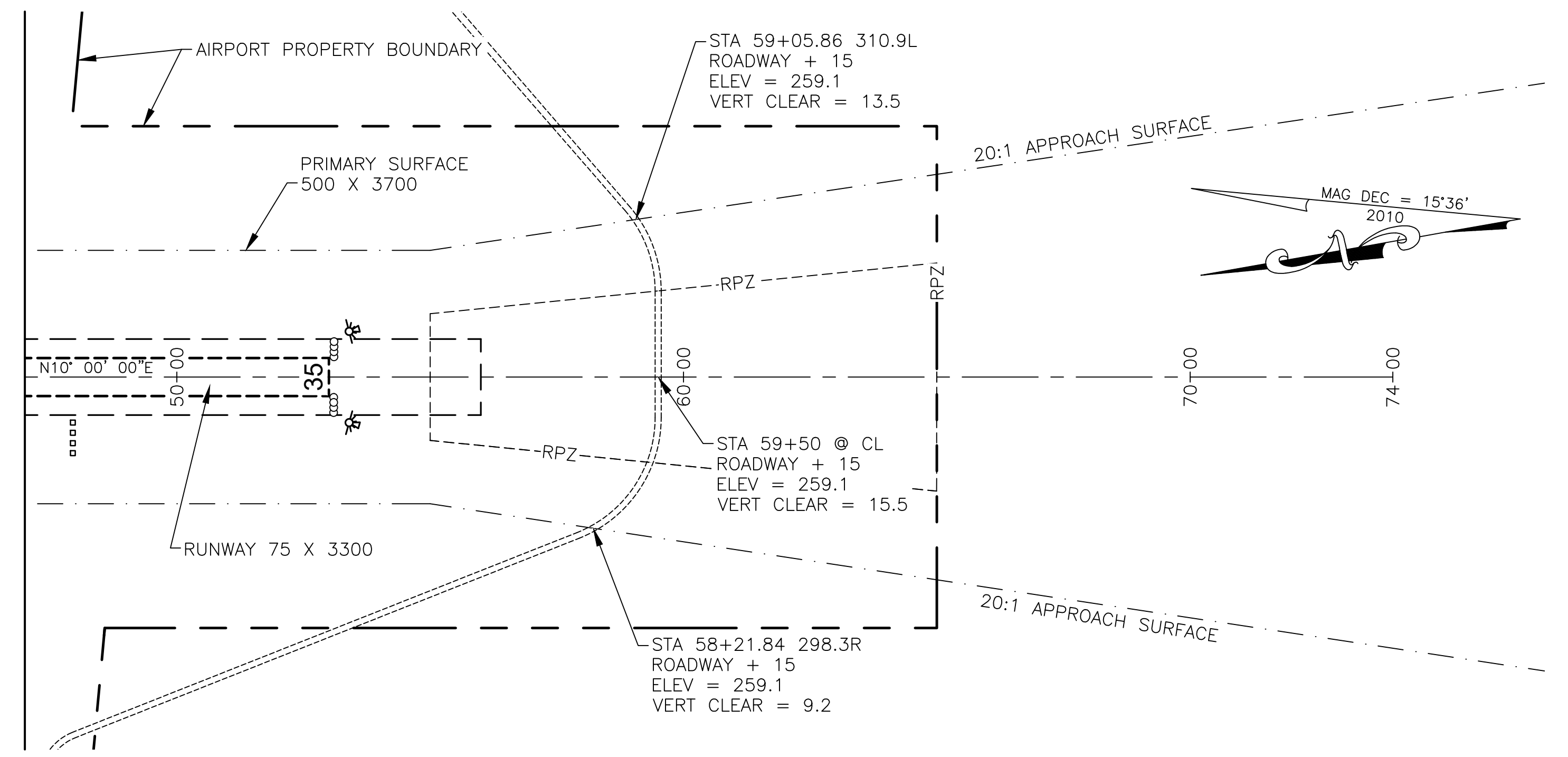

RUNWAY 35

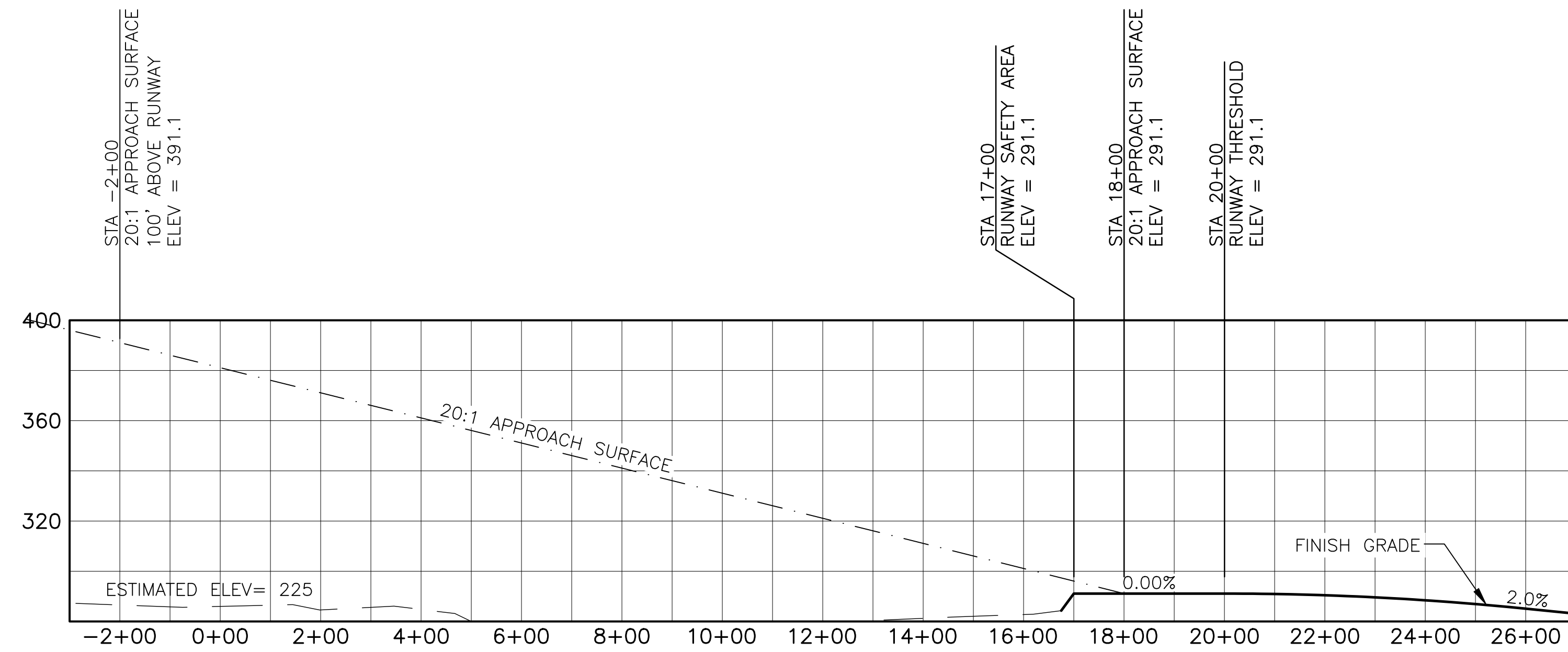

RUNWAY 17

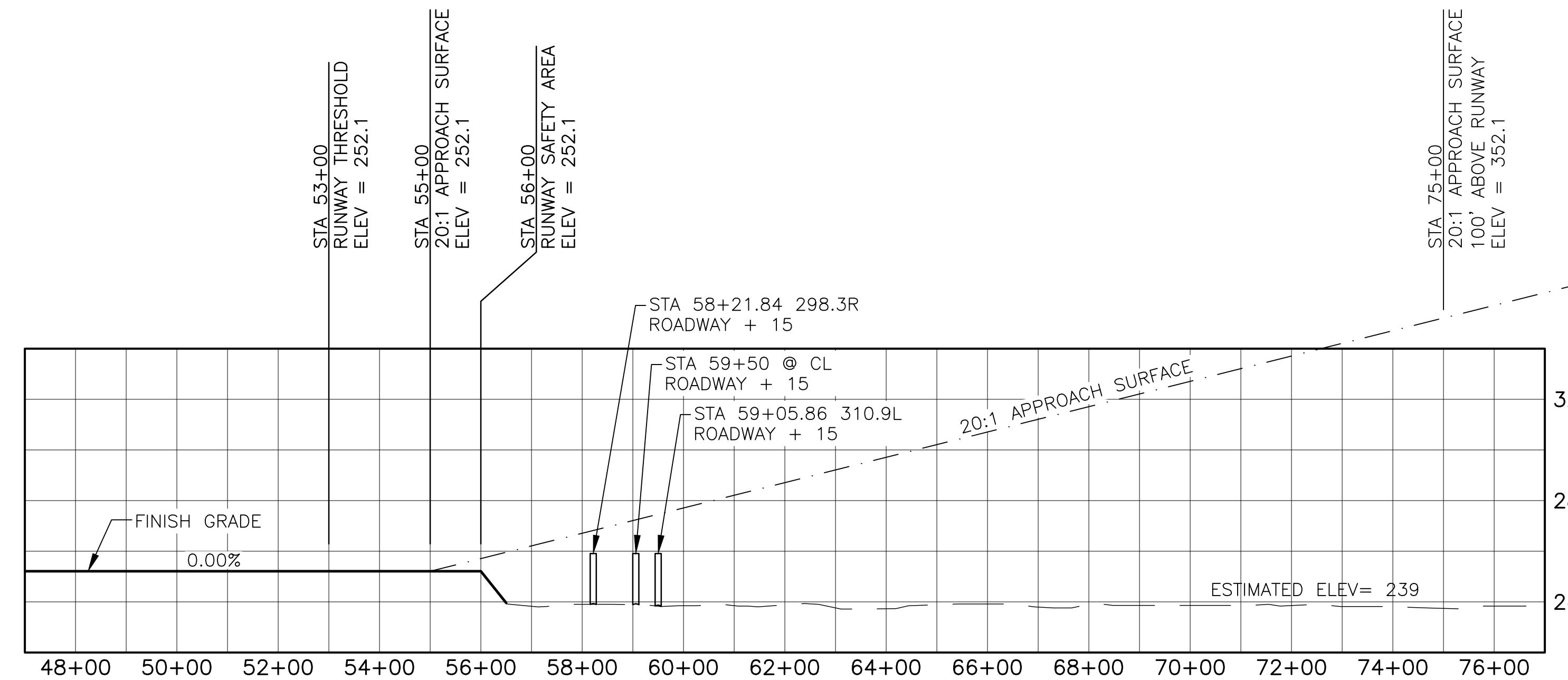

RUNWAY 35

ID #	DESCRIPTION	STATION/OFFSET	ELEVATION	SURFACE PENETRATED	SURFACE ELEVATION	AMOUNT PENETRATION	DISPOSITION	STAGE TO CORRECT
	NONE							

NOTE: REFER TO THE AIRPORT AIRSPACE DRAWING FOR PENETRATIONS OF THE OUTER APPROACH SURFACES

NOTES:

- THERE ARE NO CONTROLLING OBSTRUCTIONS FOR RUNWAY 17, THEREFORE THE CONTROLLING OBSTRUCTION CLEARANCE SLOPE IS ESTABLISHED AS 20:1 PER FAA AC 150/5200-35A, CHAPTER 4, DATA ELEMENT NUMBER 57.
- THERE ARE NO OBJECT PENETRATIONS IN THE RUNWAY APPROACH END SITING SURFACES OF RUNWAY 17, AS DEFINED IN FAA AC 150/5300-13A, TABLE 3-2, LINE 5.
- THERE ARE NO THRESHOLD SITING SURFACE PENETRATIONS.

ID #	DESCRIPTION	STATION/OFFSET	ELEVATION	SURFACE PENETRATED	SURFACE ELEVATION	AMOUNT PENETRATION	DISPOSITION	STAGE TO CORRECT
	NONE							

NOTE: REFER TO THE AIRPORT AIRSPACE DRAWING FOR PENETRATIONS OF THE OUTER APPROACH SURFACES

NOTES:

- THERE ARE NO CONTROLLING OBSTRUCTION FOR RUNWAY 35, THEREFORE THE CONTROLLING OBSTRUCTION CLEARANCE SLOPE IS ESTABLISHED AS 20:1 PER FAA AC 150/5200-35A, CHAPTER 4, DATA ELEMENT NUMBER 57.
- THERE ARE NO OBJECT PENETRATIONS IN THE RUNWAY APPROACH END SITING SURFACES OF RUNWAY 35, AS DEFINED IN FAA AC 150/5300-13A, TABLE 3-2, LINE 5.
- THERE ARE NO THRESHOLD SITING SURFACE PENETRATIONS.

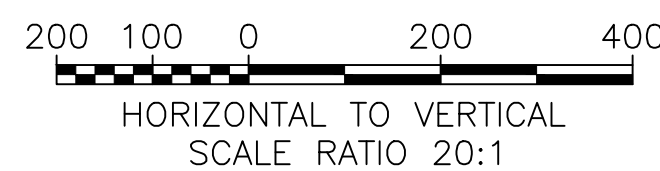

BY	DATE	REVISION
	06/2018	RPZ UPDATE

STATE OF ALASKA
DEPARTMENT OF TRANSPORTATION
AND PUBLIC FACILITIES
CENTRAL REGION

KOLIGANEK AIRPORT
 KOLIGANEK, ALASKA
 AIRPORT LAYOUT PLAN
 ULTIMATE INNER PORTION
 OF THE APPROACH SURFACES
 RUNWAY 17/35

DATE: 4/12/2019
 SHEET: 6 OF 9

Date Plotted: 6/05/2019, 1:00 PM
 Airport: Airspace
 Layout Name: W:\Projects\KolikaneK\ALP\ALP_2018\ALP_Plan.dwg
 File Name:
 Designed By: rkbrvant
 Drawn By:
 Checked By:

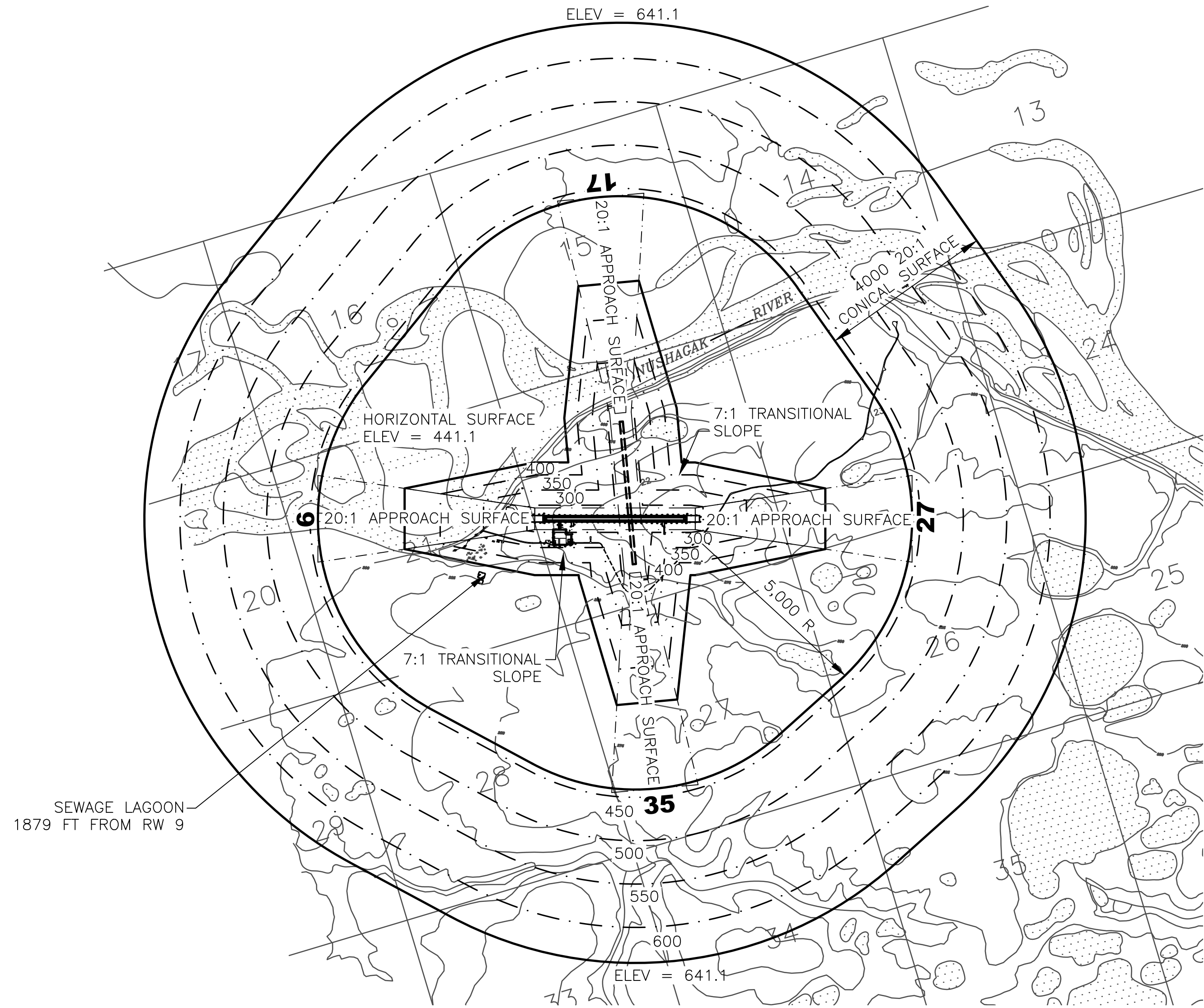

PART 77 SURFACE OBSTRUCTION TABLE (OUTER PORTION)								
ID #	DESCRIPTION	STATION/OFFSET	ELEVATION	SURFACE PENETRATED	SURFACE ELEVATION	AMOUNT PENETRATION	DISPOSITION	STAGE TO CORRECT
	NONE							

NOTES

- AIRPORT ELEVATION IS 291.1.
- APPROACH SURFACES ARE 20:1 BEGINNING AT 200' FROM THE THRESHOLDS.
- BASE MAP DATA FROM USGS QUAD, DILLINGHAM C-4.
- REFER TO THE INNER PORTION OF THE APPROACH SURFACE DRAWINGS FOR CLOSE-IN OBSTRUCTIONS.
- PRIMARY SURFACE WIDTH IS 500 FEET.
- THERE ARE NO KNOWN HEIGHT RESTRICTIONS.

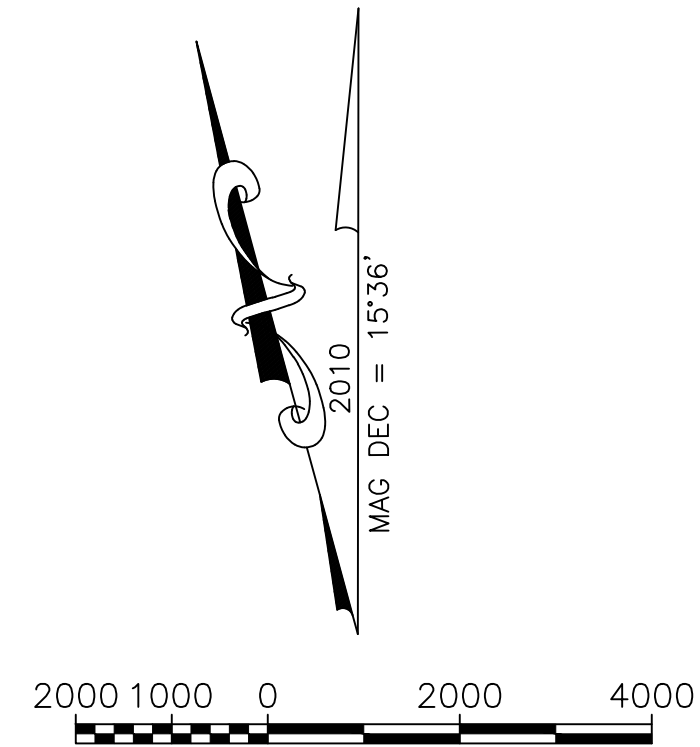

BY	DATE	REVISION
	06/2018	AS-BUILT PER AKSAS 59276

STATE OF ALASKA
DEPARTMENT OF TRANSPORTATION
AND PUBLIC FACILITIES
CENTRAL REGION

KOLIGANEK AIRPORT
 KOLIGANEK, ALASKA
 AIRPORT LAYOUT PLAN

 AIRPORT AIRSPACE,
 14 CFR PART 77

DATE:
 4/12/2019
 SHEET:
 7
 OF
 9

Date Plotted: 6/05/2019, 1:00 PM
 Profiles
 Layout Name: W:\Projects\KolikaneK\ALP\ALP_2018\ALP_Plan.dwg
 File Name:
 Designed By: rklbrant
 Drawn By:
 Checked By:

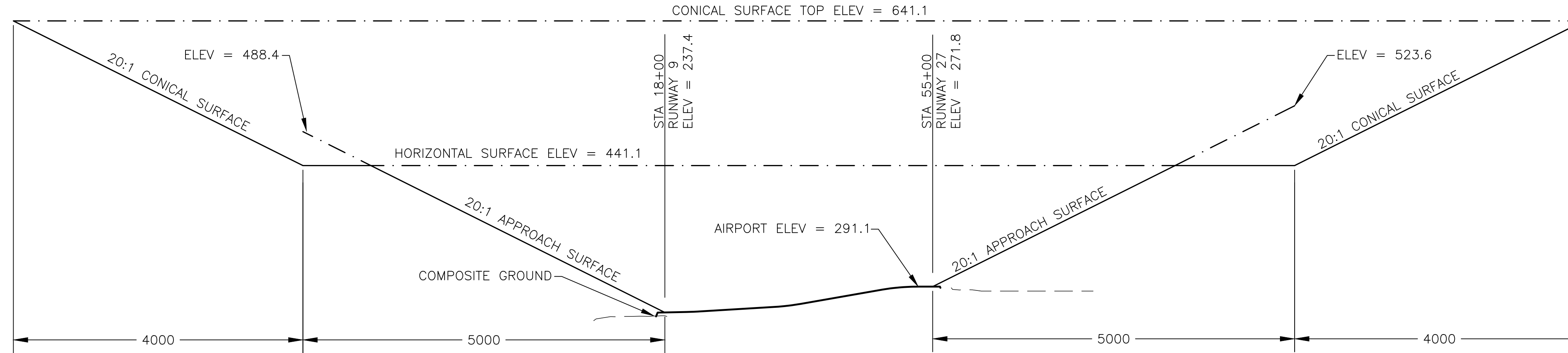

RUNWAY 9/27 PROFILE

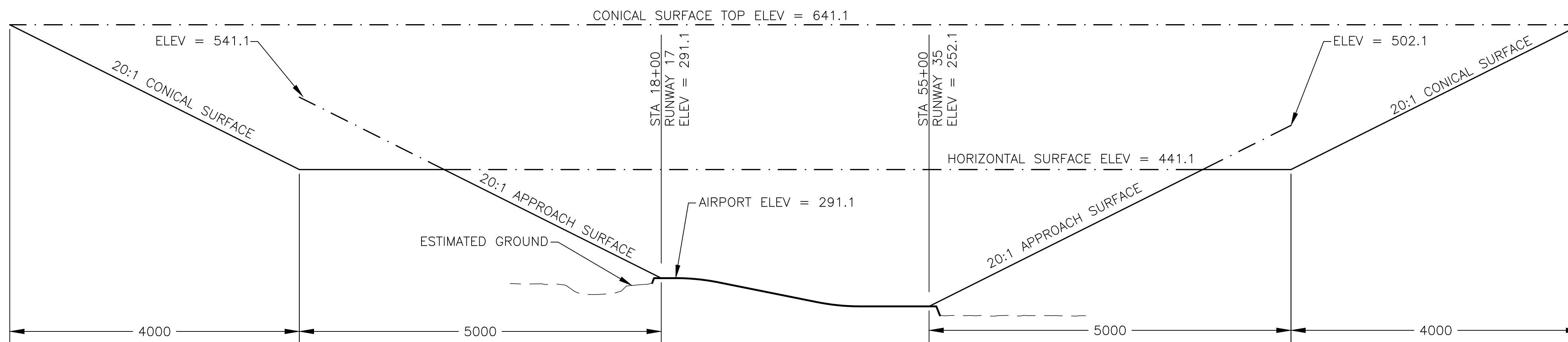

RUNWAY 17/35 PROFILE

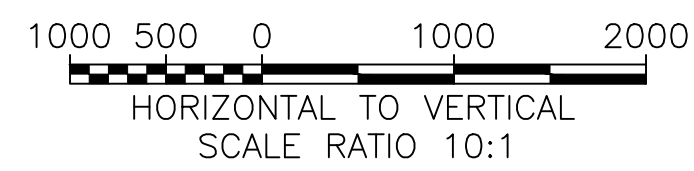

BY	DATE	REVISION
	06/2018	AS-BUILT PER AKSAS 59276

STATE OF ALASKA
DEPARTMENT OF TRANSPORTATION
AND PUBLIC FACILITIES
CENTRAL REGION

KOLIGANEK AIRPORT
 KOLIGANEK, ALASKA
 AIRPORT LAYOUT PLAN
 AIRPORT AIRSPACE
 PROFILES

DATE:
 4/12/2019
 SHEET:
 8 OF
 9

PROPERTY STATUS

TRACT NO.	GRANTOR	GRANTEE	INTEREST ACQUIRED	DATE ACQUIRED	ACQUIRED UNDER AIP NO.	RECORDED DOCUMENT NO.
A	STATE OF ALASKA D.O.T. & P.F.	KOLIGANEK NATIVES LIMITED	RETAINED	9/23/2001	N/A	2002-000511-0
A	KOLIGANEK NATIVES LIMITED	STATE OF ALASKA D.O.T. & P.F.	FEE	10/31/1985	3-02-0424-001-1994	BK. 30, PG. 445-452
B	KOLIGANEK NATIVES LIMITED (Surface)	STATE OF ALASKA D.O.T. & P.F.	FEE	5/25/1994	3-02-0424-001-1994	BK. 42, PG. 391-396
	BRISTOL BAY NATIVE CORP. (Subsurface)	STATE OF ALASKA D.O.T. & P.F.	FEE	5/25/1994	3-02-0424-001-1994	BK. 42, PG. 397-402
D	ANDREW, ET. AL.	STATE OF ALASKA D.O.T. & P.F.	FEE	7/18/1994	3-02-0424-001-1994	BK. 42, PG. 636-685
F	KOLIGANEK NATIVES LIMITED (Surface)	STATE OF ALASKA D.O.T. & P.F.	FEE	5/25/1994	3-02-0424-001-1994	BK. 42, PG. 391-396
	BRISTOL BAY NATIVE CORP. (Subsurface)	STATE OF ALASKA D.O.T. & P.F.	FEE	5/25/1994	3-02-0424-001-1994	BK. 42, PG. 397-402
2	KOLIGANEK NATIVES LIMITED (Surface)	STATE OF ALASKA D.O.T. & P.F.	FEE	2/10/2016	3-02-0424-002-2013	2016-000231-0
	BRISTOL BAY NATIVE CORP. (Subsurface)	STATE OF ALASKA D.O.T. & P.F.	FEE	2/10/2016	3-02-0424-002-2013	2016-000235-0
3	KOLIGANEK NATIVES LIMITED (Surface)	STATE OF ALASKA D.O.T. & P.F.	FEE	2/10/2016	3-02-0424-002-2013	2016-000231-0
	BRISTOL BAY NATIVE CORP. (Subsurface)	STATE OF ALASKA D.O.T. & P.F.	FEE	2/10/2016	3-02-0424-002-2013	2016-000235-0
4	KOLIGANEK NATIVES LIMITED (Surface)	STATE OF ALASKA D.O.T. & P.F.	FEE	2/10/2016	3-02-0424-002-2013	2016-000231-0
	BRISTOL BAY NATIVE CORP. (Subsurface)	STATE OF ALASKA D.O.T. & P.F.	FEE	2/10/2016	3-02-0424-002-2013	2016-000235-0
5	KOLIGANEK NATIVES LIMITED (Surface)	STATE OF ALASKA D.O.T. & P.F.	FEE	2/10/2016	3-02-0424-002-2013	2016-000231-0
	BRISTOL BAY NATIVE CORP. (Subsurface)	STATE OF ALASKA D.O.T. & P.F.	FEE	2/10/2016	3-02-0424-002-2013	2016-000235-0
E-6B	STATE OF ALASKA D.O.T. & P.F.	HEIRS OF GUST JOHNSON SR.	ESMT	7/1/2016	3-02-0424-002-2013	2016-000233-0
E-6C	STATE OF ALASKA D.O.T. & P.F.	HEIRS OF GUST JOHNSON SR.	ESMT	7/1/2016	3-02-0424-002-2013	2016-000234-0
7	STATE OF ALASKA D.N.R.	STATE OF ALASKA D.O.T. & P.F.	ILMA	3/7/16	3-02-0424-002-2013	2016-000365-0
8	KOLIGANEK NATIVES LIMITED (Surface)	STATE OF ALASKA D.O.T. & P.F.	FEE	2/10/16	3-02-0424-002-2013	2016-000232-0
	BRISTOL BAY NATIVE CORP. (Subsurface)	STATE OF ALASKA D.O.T. & P.F.	FEE	2/10/16	3-02-0424-002-2013	2016-000236-0
9	KOLIGANEK NATIVES LIMITED (Surface)	STATE OF ALASKA D.O.T. & P.F.	FEE	TBA		
	BRISTOL BAY NATIVE CORP. (Subsurface)	STATE OF ALASKA D.O.T. & P.F.	FEE	TBA		
10	STATE OF ALASKA D.N.R.	STATE OF ALASKA D.O.T. & P.F.	ILMA	TBA		
E-11A	STATE OF ALASKA D.O.T. & P.F.	KOLIGANEK VILLAGE COUNCIL	ESMT	7/5/1995	3-02-0424-001-1994	PERMIT ADA-07149
E-11B	STATE OF ALASKA D.O.T. & P.F.	KOLIGANEK VILLAGE COUNCIL	ESMT	7/5/1995	3-02-0424-001-1994	PERMIT ADA-07149

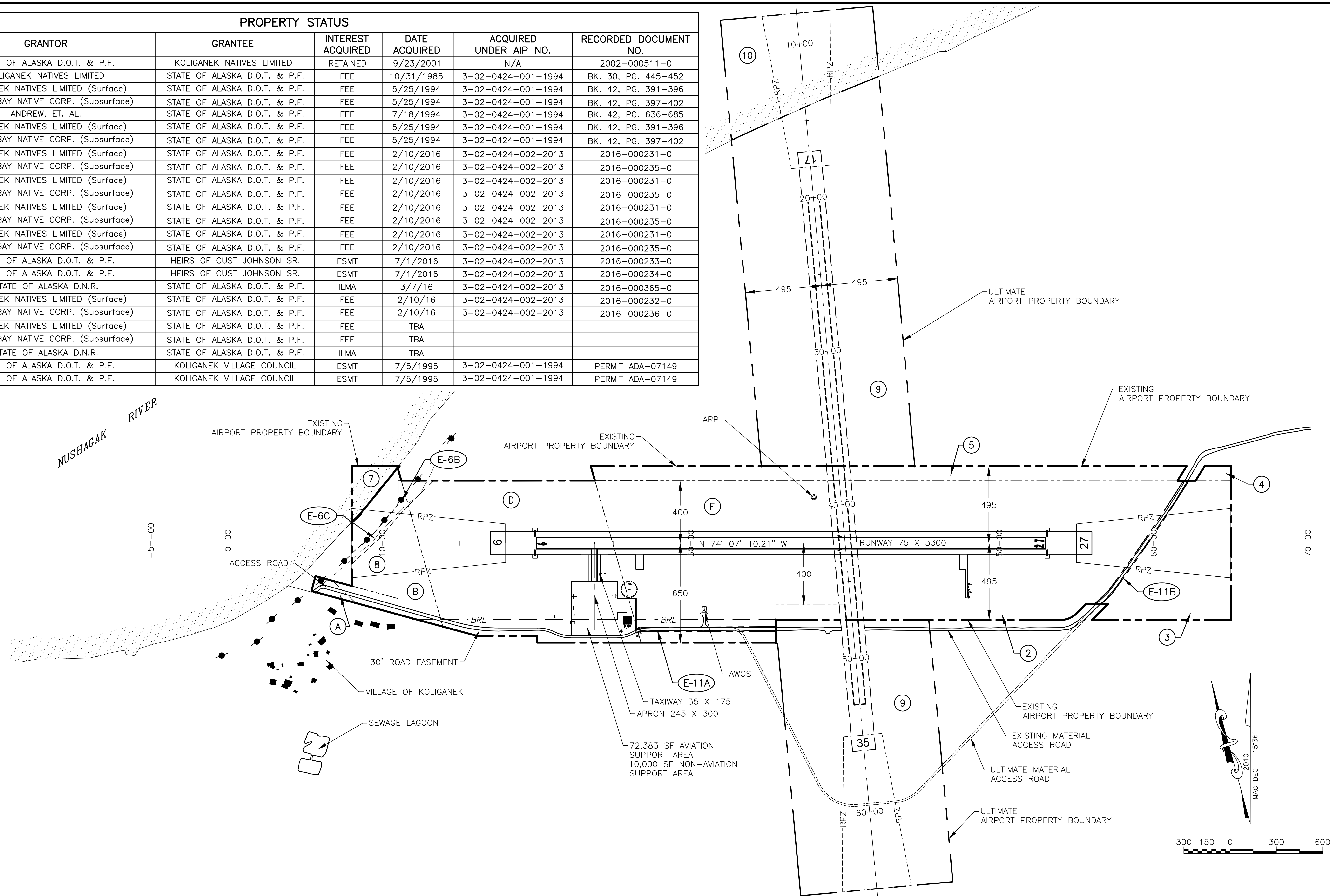

Date Plotted: 6/05/2019, 1:00 PM
 Property Map
 Layout Name: W:\Projects\Koliganek\ALP\ALP_2016\ALP_Property_Map.dwg
 File Name:
 Designed By: rkbryant
 Drawn By:
 Checked By:

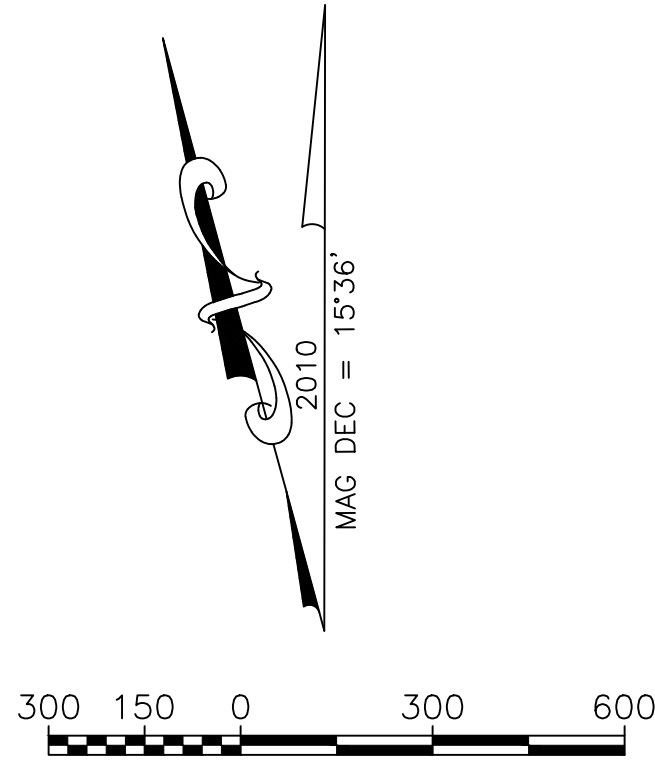

BY	DATE	REVISION
	06/2018	AS-BUILT PER AKSAS 59276

STATE OF ALASKA
 DEPARTMENT OF TRANSPORTATION
 AND PUBLIC FACILITIES
 CENTRAL REGION

KOLIGANEK AIRPORT
 KOLIGANEK, ALASKA
 AIRPORT LAYOUT PLAN
 AIRPORT PROPERTY MAP

DATE: 4/4/2019
 SHEET: 9 OF 9