



U.S. Department
of Transportation
**Federal Aviation
Administration**

Alaskan Region Airports Division

222 W. 7th Avenue, #14
Anchorage, Alaska 99513-7587
Tel. (907) 271-5438 / Fax (907) 271-2851

August 24, 2022

Tadd Isaacson, P.E.
ADOT&PF Aviation Design
4111 Aviation Ave
Anchorage, AK 99519-6900

Dear Mr. Isaacson:

**Birchwood Airport
Birchwood, Alaska
As-Built Airport Layout Plan (July 2022)
(Original ALP Airspace # 2011-AAL-309-NRA)**

We have completed our review of the Birchwood Airport As-Built Airport Layout Plan (ALP) dated July 2022, and find it acceptable for documenting the existing conditions of the airport.

Please retain this letter in your files for future reference.

Sincerely,

Pat Zettler, P.E., Lead Engineer
Airports Division

Date Plotted: 2-16-2012
 Layout Name: ALP-SHEET-1
 File Name: W:\Projects\Birchwood\ALP\Birchwood_ALP_2022\Airport_Layout_Plan\CAD\BIRCH_ALP-01_update.dwg
 Designed By: DLG
 Drawn By: LJW
 Checked By: LJGW

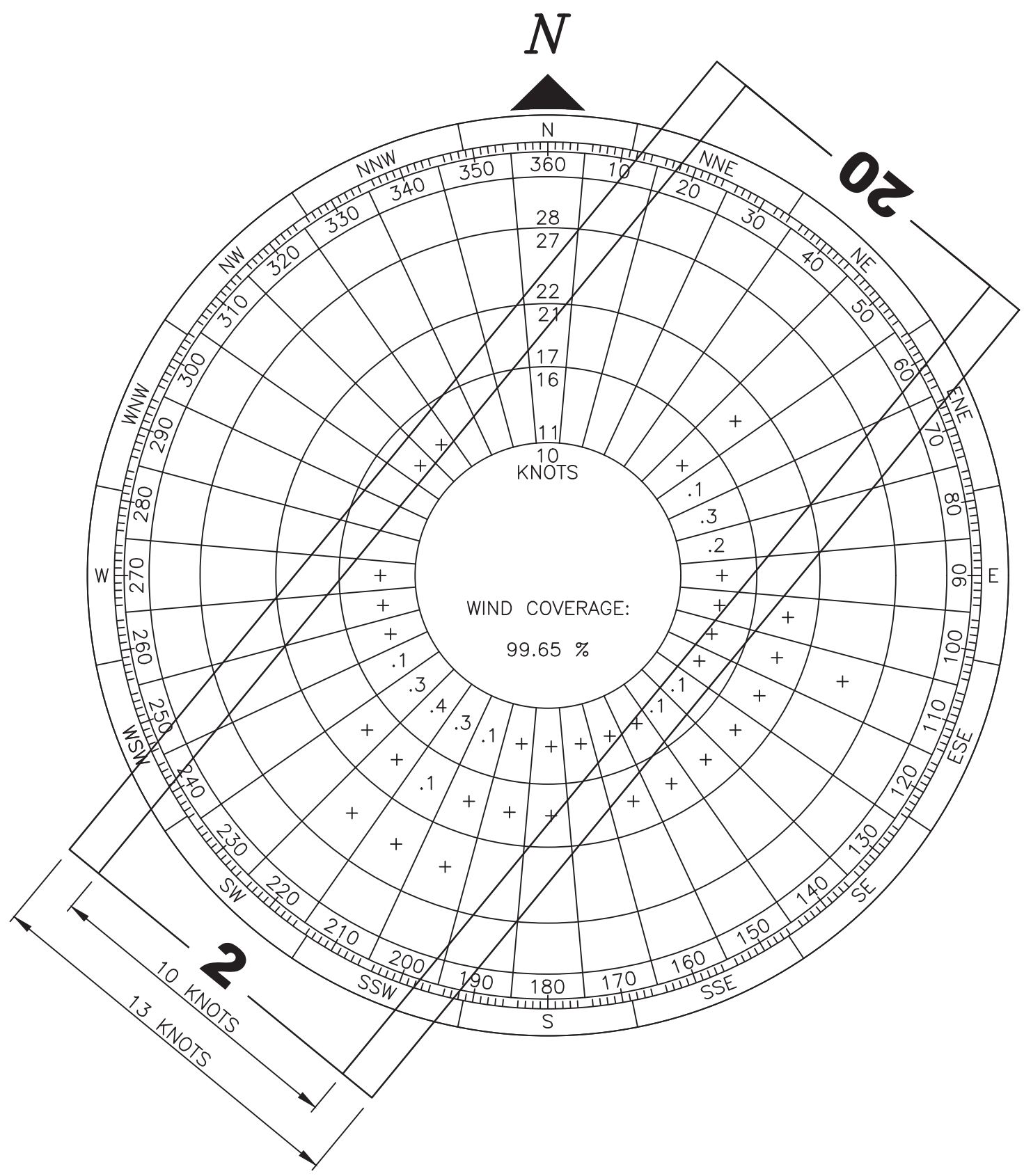
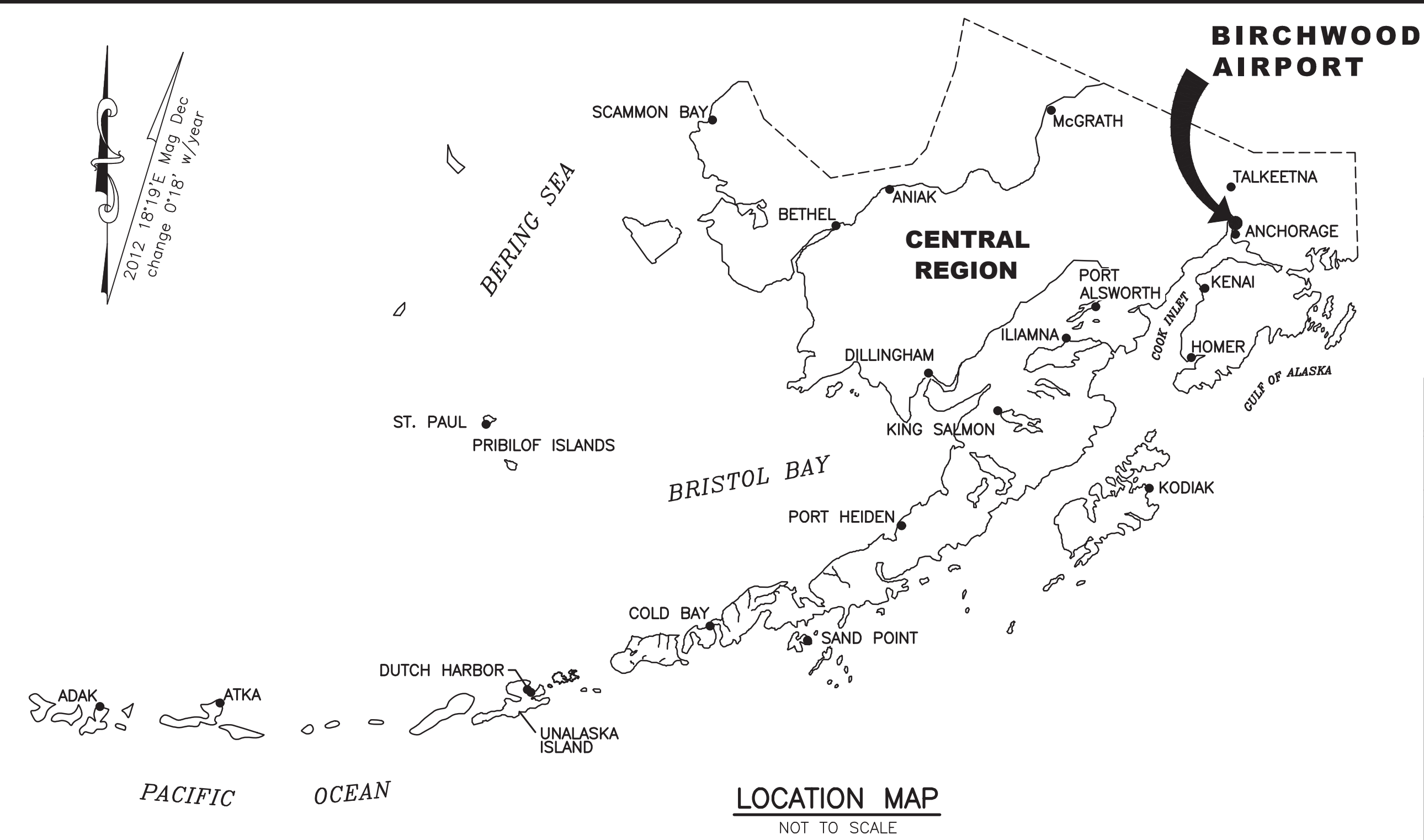

WIND DATA TABLE		
RUNWAY	10.5 kt	13 kt
2L/20R	99.65%	99.81%

SOURCE: BIRCHWOOD AWOS
 DATA IS FOR BIRCHWOOD ALASKA
 PERIOD: JULY 1996 - DECEMBER 1998

AIRPORT DATA		
ITEM	EXISTING	ULTIMATE
ICAO/ NATIONAL AIRPORT IDENTIFIER	PABV/BCV	SAME
FAA SITE NUMBER	50069.*A	SAME
AIRPORT ELEVATION SEE NOTE 1 BELOW	83.1'	83.02' (NAVD 88)
AIRPORT REFERENCE POINT (A.R.P.) (NAD 83)	LATITUDE 61°24'57.59"	SAME
	LONGITUDE 149°30'32.13"	SAME
MEAN MAX. TEMPERATURE, HOTTEST MONTH (JULY)	65.0°F	SAME
AIRPORT REFERENCE CODE	B-II	SAME
AIRPORT NAVIGATION AIDS	ROTATING BEACON	SAME
TAXIWAY LIGHTING AND MARKING	M.I.	M.I.
MAGNETIC DECLINATION, RATE OF CHANGE WITH YEAR	2012 MAG DEC 18°19'E, 0'18' w/yr	
OBSTRUCTION SURVEY AND TYPE	NONE	AV / ANP

RUNWAY DATA				
ITEM	RUNWAY 2L/20R		RUNWAY 2R/20L	RUNWAY 2S/20S
	EXISTING	ULTIMATE	EXISTING	ULTIMATE
RUNWAY TYPE	UTILITY OR OTHER THAN UTILITY	UTILITY	UTILITY	SAME
FAR PART 77 APPROACH CATEGORY (V, NPI, P)	V / V	V / NPI	V / V	V / V
RUNWAY END IDENTIFIER NUMBER	2L/20R	2L/20R	2R/20L	2S/20S
EFFECTIVE GRADE	0.37 %	SAME	0.30 %	0.13 %
INSTRUMENT RUNWAY	NONE	19	NONE	SAME
RUNWAY SURFACE	ASPHALT	SAME	GRAVEL	SAME
PAVEMENT STRENGTH	lb. 12,500	>12,500	12,500	SAME
APPROACH SURFACES	20:1 / 20:1	20:1 / 34:1	20:1	SAME
VISIBILITY MINIMUM	VISUAL	NPI, 1SM	VISUAL	SAME
RUNWAY LIGHTING	MIRL	SAME	NONE	SAME
RUNWAY MARKING	NON-PRECISION	SAME	NONE	SAME
RUNWAY VISUAL AIDS	VASI (R/W 19)	PAPI (R/W 19)	NONE	SAME
AIRCRAFT APPROACH CATEGORY	B	SAME	A	SAME
AIRCRAFT DESIGN GROUP	II	SAME	I	SAME
TRUE BEARING	N39°24'36"E	SAME	N39°24'43"E	SAME
RUNWAY TOUCHDOWN ZONE ELEVATIONS (NAVD88) 2L/20R	83.1' / 82.1'	83.02' / 81.90'	79.3	NA
RUNWAY DIMENSIONS	4,012'x100'	SAME	1,802'x50'	1,535'x60'
RUNWAY SAFETY AREA DIMENSIONS	4,492'x120'	4,610'x150'	2,682'x120'	2,015'x120'
RSA LENGTH BEYOND RUNWAY ENDS	240'	300'	240'	240'
RUNWAY OBJECT FREE AREA DIMENSIONS	4,492'x400'	4,610'x500'	2,682'x250'	2,015'x250'
RUNWAY OFA LENGTH BEYOND RUNWAY ENDS	240'	300'	240'	240'
RUNWAY OBSTACLE FREE ZONE DIMENSIONS	4,412'x250'	SAME	2,602'x250'	1,935'x250'
GEODETIC POSITIONS (N.A.D. 83)				
THRESHOLD RUNWAY 2	LATITUDE 61°24'42.32"N	SAME	61°24'48.81"N	61°24'43.63"N
	LONGITUDE 149°30'58.30"W	SAME	149°30'41.72"W	149°30'53.45"W
THRESHOLD RUNWAY 20	LATITUDE 61°25'12.84"N	SAME	61°25'05.68"N	61°24'55.37"N
	LONGITUDE 149°30'05.97"W	SAME	149°30'13.21"W	149°30'33.61"W
RUNWAY PROTECTION ZONE DIMENSIONS	INNER WIDTH 250'	500'	250'	SAME
	OUTER WIDTH 450'	700'	450'	SAME
	LENGTH 1,000'	1,000'	1,000'	SAME

NOTES
 1. VERTICAL DATUM IS NGS NAVD88, ESTABLISHED BY GPS TIES TO AKDOT CONTROL POINTS "BEAR" AND "PETER" USING GEOID99 UNDULATIONS AND FIXED ORTHOMETRIC HEIGHTS COMPUTED BY APPLYING A DATUM SHIFT OF +6.26311 TO AKDOT PROVIDED MOA GAAB72 ELEVATIONS. SAID DATUM SHIFT REFLECTS THE DIFFERENCE BETWEEN THE AKDOT PROVIDED MOA GAAB72 ELEVATION AND THE PUBLISHED NGS NAVD88 ELEVATION AT STATION "Q 83" (PID: TT0671)

TAXIWAY DATA															
	A		B	C		D		E		F	G		H	I	J
	EXISTING	ULTIMATE		EXISTING	ULTIMATE	EXISTING	ULTIMATE	EXISTING	ULTIMATE		EXISTING	ULTIMATE			
TAXIWAY WIDTH	50'	30'/50'	50'	50'	50'	50'	50'	34'	35'	50'	50'	50'	30'	30'	30'
TAXIWAY LENGTH	1,813'	4,444'	4,560'	349'	386'	350'	401'	357'	357'	225'	353'	511'	98'	98'	98'
TAXIWAY SHOULDER WIDTH	10'	10'	10'	10'	10'	10'	10'	10'	10'	10'	10'	10'	10'	10'	10'
TAXIWAY SEPARATION FROM RUNWAY	200'	150'/240'	300'	--	--	--	--	--	--	--	--	--	--	--	--
TAXIWAY SAFETY AREA WIDTH	--	79'	79'	--	79'	--	79'	--	79'	79'	--	79'	49'	49'	49'
TAXIWAY OBJECT FREE AREA WIDTH	--	131'	131'	--	131'	--	131'	--	131'	131'	--	131'	89'	89'	89'
TAXIWAY LIGHTING	NONE	M.I.T.L.	M.I.T.L.	M.I.T.L.	SAME	M.I.T.L.	SAME	M.I.T.L.	SAME	M.I.T.L.	M.I.T.L.	SAME	NONE	NONE	NONE

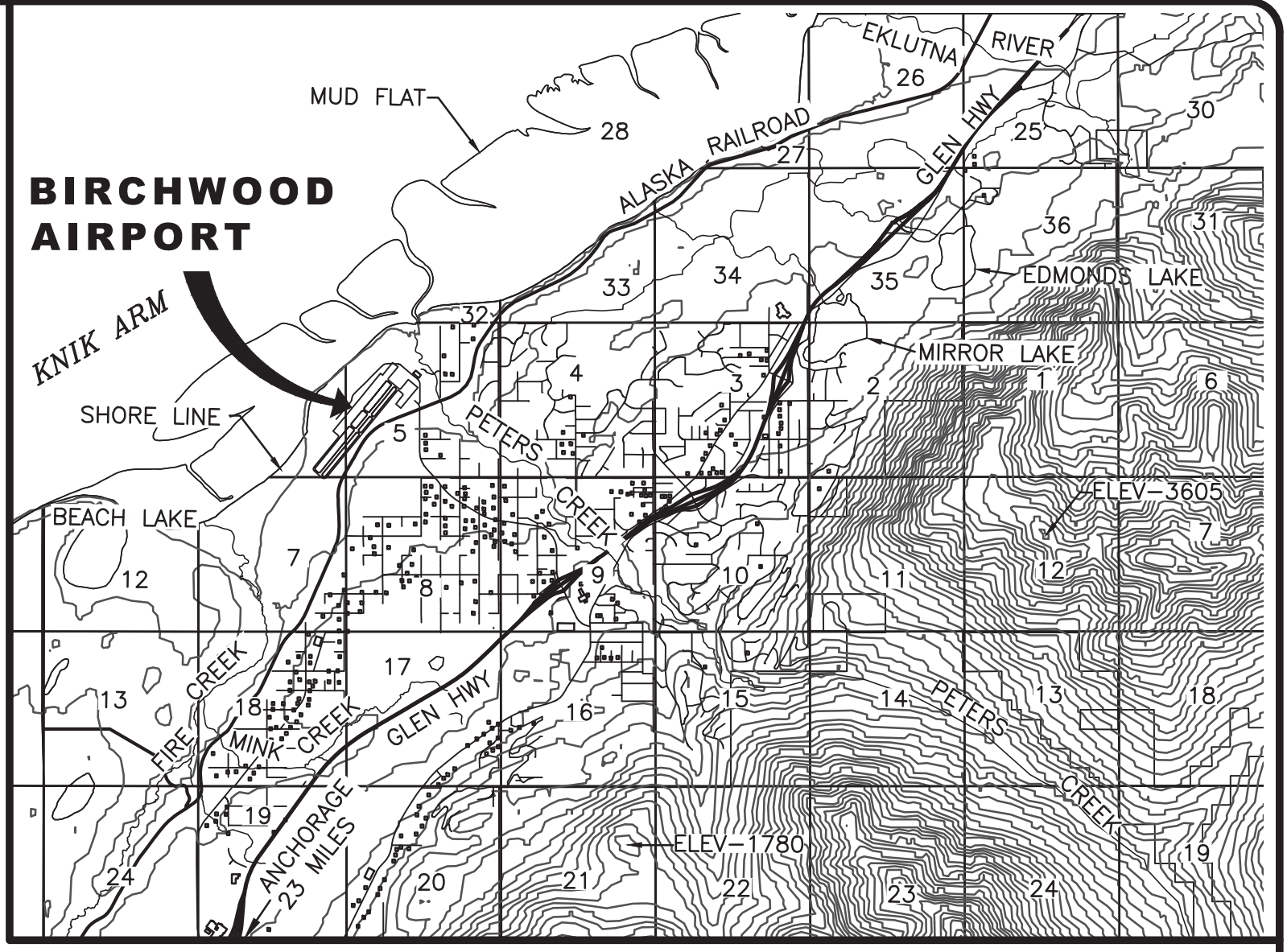

VICINITY MAP
 T 15 N, T 16 N, R 1 W, R 2 W, SEC 6 & 5
 SEWARD MERIDIAN
 U.S.G.S. ANCHORAGE (B-7), ALASKA
 NOTE: ELEVATIONS IN FEET.

LEGEND		
ITEM	EXISTING	ULTIMATE
AIRPORT REFERENCE POINT (A.R.P.)		
ANTENNA		
BLUFF		
BUILDINGS		
BUILDING RESTRICTION LINE		
FENCE		
PAPI		
PROPERTY LINE		
REIL		
ROADWAYS		
ROTATING BEACON		
SHORELINE		
SURVEY MONUMENT		
THRESHOLD MARKERS/LIGHTS		
TOPOGRAPHIC CONTOURS		
TREE (LARGE SINGLE)		
TREELINE		
VASI		
WIND CONE		
WIND CONE AND SEGMENTED CIRCLE		

DRAWING INDEX	
SHT No.	TITLE
1	DATA
2	AIRPORT LAYOUT PLAN, EXISTING
3	AIRPORT LAYOUT PLAN, ULTIMATE
4	AIRPORT LAYOUT PLAN, ULTIMATE
5	TERMINAL AREA
6	INNER PORTION OF THE APPROACH SURFACES, EXISTING
7	INNER PORTION OF THE APPROACH SURFACES, ULTIMATE
8	F.A.R. PART 77 AIRSPACE
9	F.A.R. PART 77 AIRSPACE OBSTRUCTIONS
10	LAND USE PLAN
11	PROPERTY MAP

BY	DATE	REVISION
	07/2022	AS-BUILT PER CAFPT00275
	09/12/16	AS-BUILT PER 8-2015 SURVEY

APPROVED: _____ **DATE:** _____
 KENNETH M. MORTON, P.E. **PRECONSTRUCTION ENGINEER**
RECOMMENDED: _____ **DATE:** _____
 HARVEY M. DOUTHIT, P.E. **DESIGN SECTION CHIEF**
 AIRPORT LAYOUT PLAN CONDITIONAL APPROVAL SUBJECT TO
 ALP APPROVAL LETTER DATED 11/7/2012
 FAA AIRSPACE REVIEW NUMBER: 2011-AAL-309-NRA
AS-BUILT ACCEPTED PATRICK J. ZETTLER
 Digitally signed by PATRICK J. ZETTLER
 Date: 2022.08.24 15:37:17 -0800 **DATE:** _____
FAA, AIRPORTS DIVISION ALASKAN REGION, AAL-

STATE OF ALASKA
DEPARTMENT OF TRANSPORTATION
AND PUBLIC FACILITIES
CENTRAL REGION
BIRCHWOOD AIRPORT
BIRCHWOOD, ALASKA
AIRPORT LAYOUT PLAN
 DATE: 9/26/2012
 SHEET: 1 OF 11
 DATA

Date Plotted: 18/08/2022
 Layout Name: Full Pdf
 File Name: W:\Projects\Birchwood\ALP\Birchwood_ALP_2022\Airport_Layout_Plan\CAD\Birchwood_ALP-02_update.dwg
 Designed By: DJG
 Drawn By: LJM
 Checked By: JGW

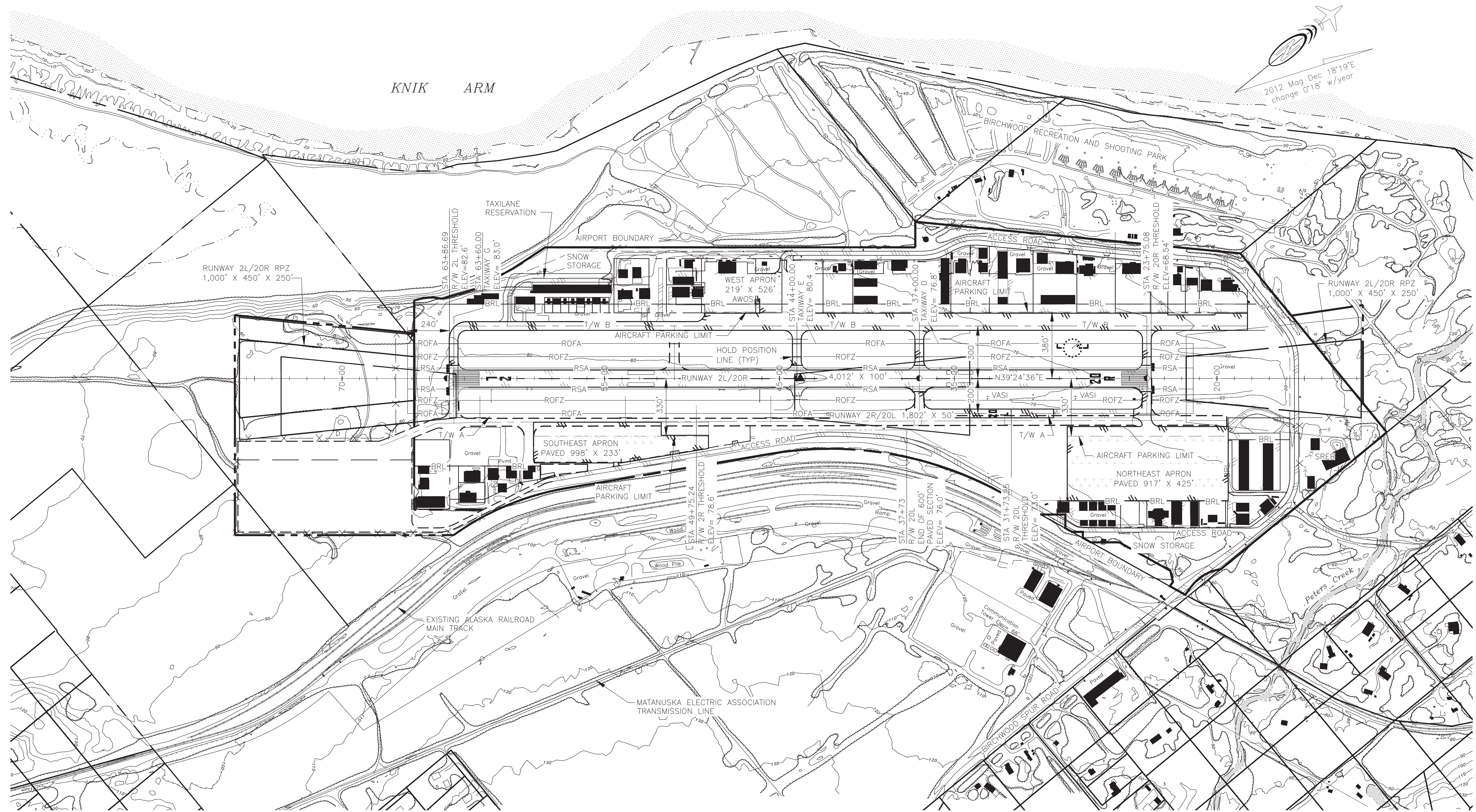

NOTES:

1. THERE IS AN OFZ PENETRATION; A FENCE CROSSES THE OFZ AT THE APPROACH END OF RUNWAY 2L.
2. FOR BRL HEIGHT AND STATION AND OFFSETS, SEE SHEET 5.

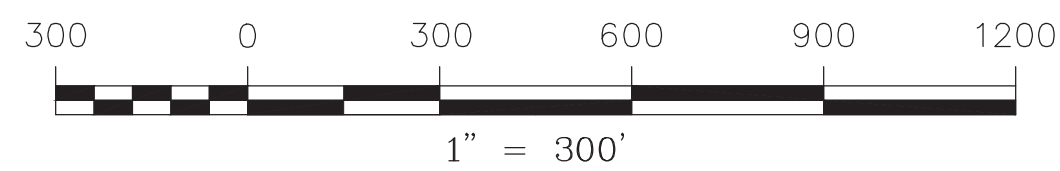

BY	DATE	REVISION
	07/2022	AS-BUILT PER CFAP00275
	09/21/16	AS-BUILT PER 8-2015 SURVEY
	6/2013	TAXILANE RESERVATION ADDED

STATE OF ALASKA
DEPARTMENT OF TRANSPORTATION
AND PUBLIC FACILITIES
CENTRAL REGION

BIRCHWOOD AIRPORT
 BIRCHWOOD, ALASKA
 AIRPORT LAYOUT PLAN

AIRPORT LAYOUT PLAN, EXISTING

DATE:	6/14/2013
SHEET:	2 OF 11

Date Plotted: 7/13/2022
 Layout Name: Full Ref
 File Name: W:\Projects\Birchwood_ALP_2022\Airport_Layout_Plan\CAD\BIRCH_ALP-03-04_update.dwg
 Designed By: DUG
 Drawn By: LJW
 Checked By: LJW

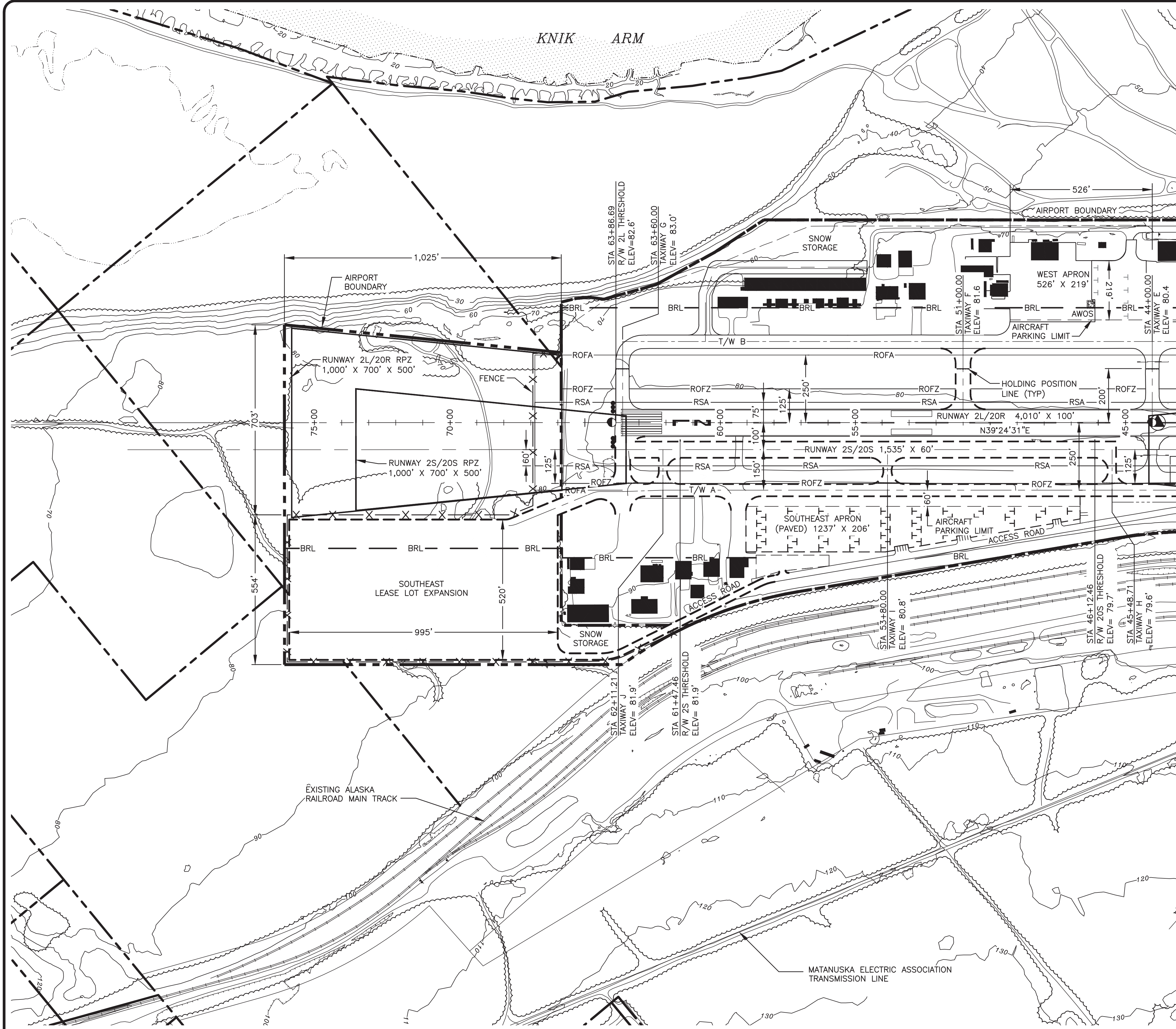

STA 43+00 MATCHLINE

- NOTES:
1. NO RVZ OBSTRUCTIONS.
 2. NO OFZ OBJECT PENETRATIONS.
 3. FOR BRL HEIGHT AND STATION AND OFFSETS SEE SHEET 5.

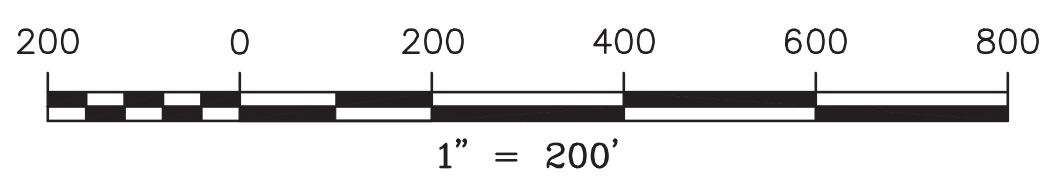

BY	DATE	REVISION
	07/2022	AS-BUILT PER CFAPT00275
	06/09/16	AS-BUILT PER 8-2015 SURVEY
	6/2013	TAXILANE RESERVATION ADDED

STATE OF ALASKA
DEPARTMENT OF TRANSPORTATION
AND PUBLIC FACILITIES
CENTRAL REGION

BIRCHWOOD AIRPORT
 BIRCHWOOD, ALASKA
 AIRPORT LAYOUT PLAN

AIRPORT LAYOUT PLAN, ULTIMATE

DATE:	6/14/2013
SHEET:	3 OF 11

Date Plotted: 7/13/2022
 Layout Name: Full Ref
 File Name: W:\Projects\Birchwood_ALP\2022\Airport_Layout_Plan\CAD\Birchwood_ALP-03-04_update.dwg
 Designed By: DUG
 Drawn By: LJW
 Checked By: LJW

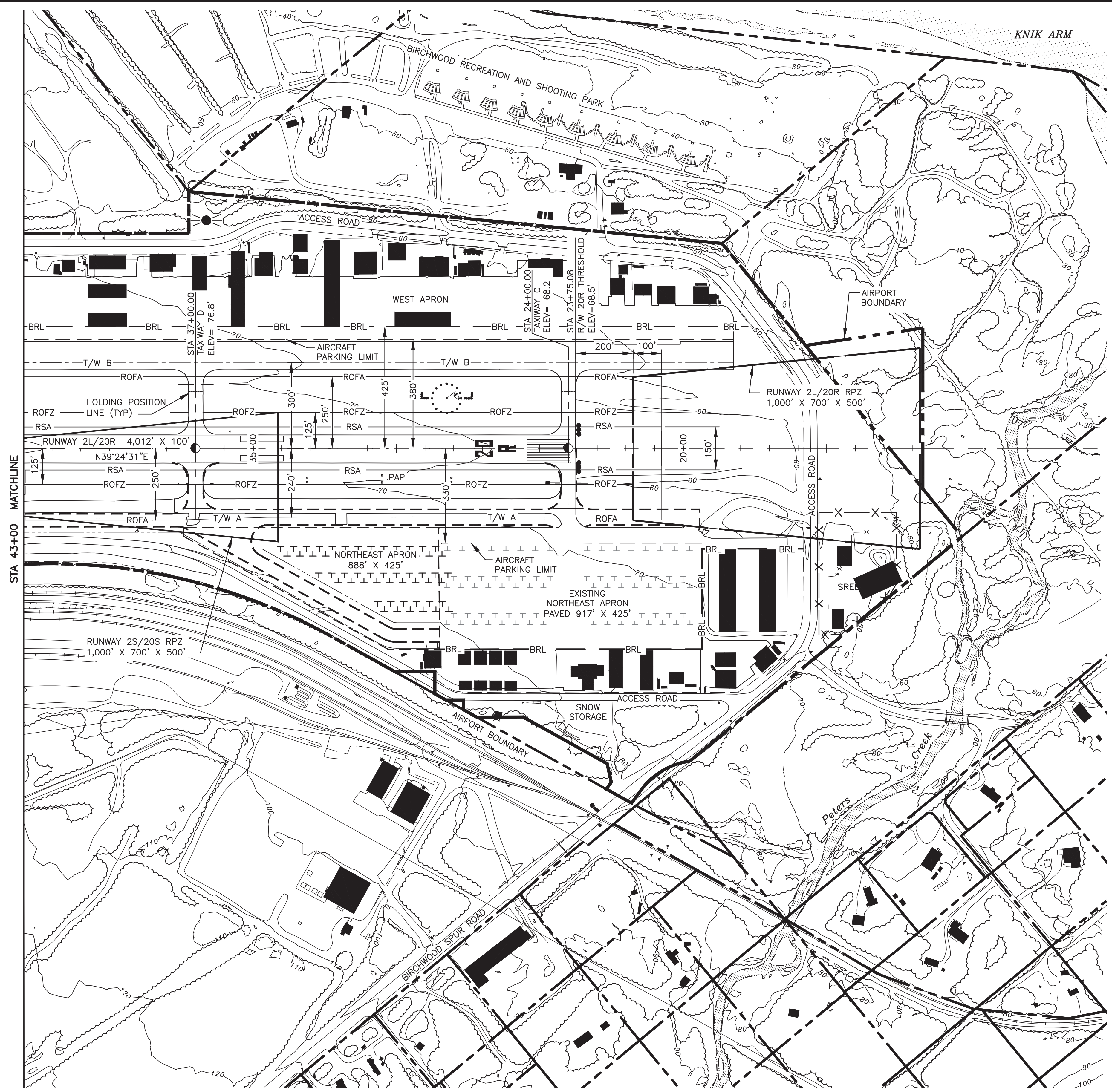
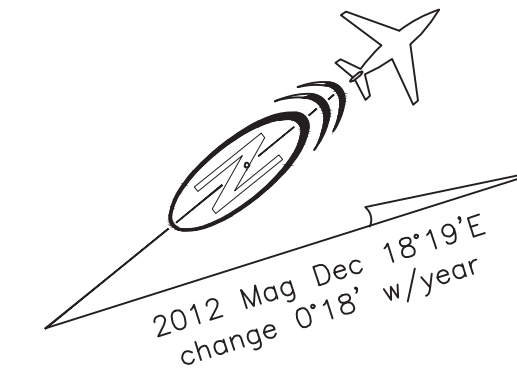

- NOTES:
1. NO RVZ OBSTRUCTIONS.
 2. NO OFZ OBJECT PENETRATIONS.
 3. FOR BRL HEIGHT AND STATION AND OFFSETS SEE SHEET 5.

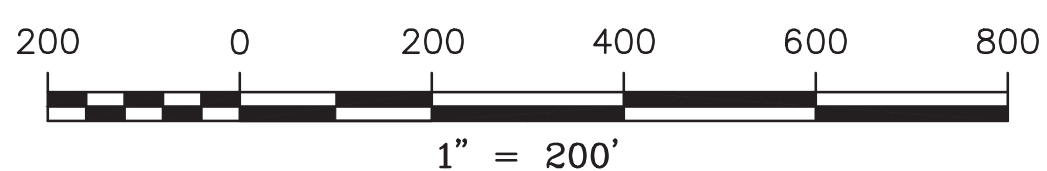

BY	DATE	REVISION

STATE OF ALASKA
DEPARTMENT OF TRANSPORTATION
AND PUBLIC FACILITIES
CENTRAL REGION

BIRCHWOOD AIRPORT
 BIRCHWOOD, ALASKA
 AIRPORT LAYOUT PLAN
 AIRPORT LAYOUT PLAN, ULTIMATE

DATE:	9/26/2012
SHEET:	4 OF 11

Date Plotted: 7/13/2022
 Layout Name: Full Ref
 File Name: W:\Projects\Birchwood_ALP_2022\Airport_Layout_Plan\CAD\BIRCH_ALP-05_update.dwg
 Designed By: DUG
 Drawn By: LJW
 Checked By: LJW

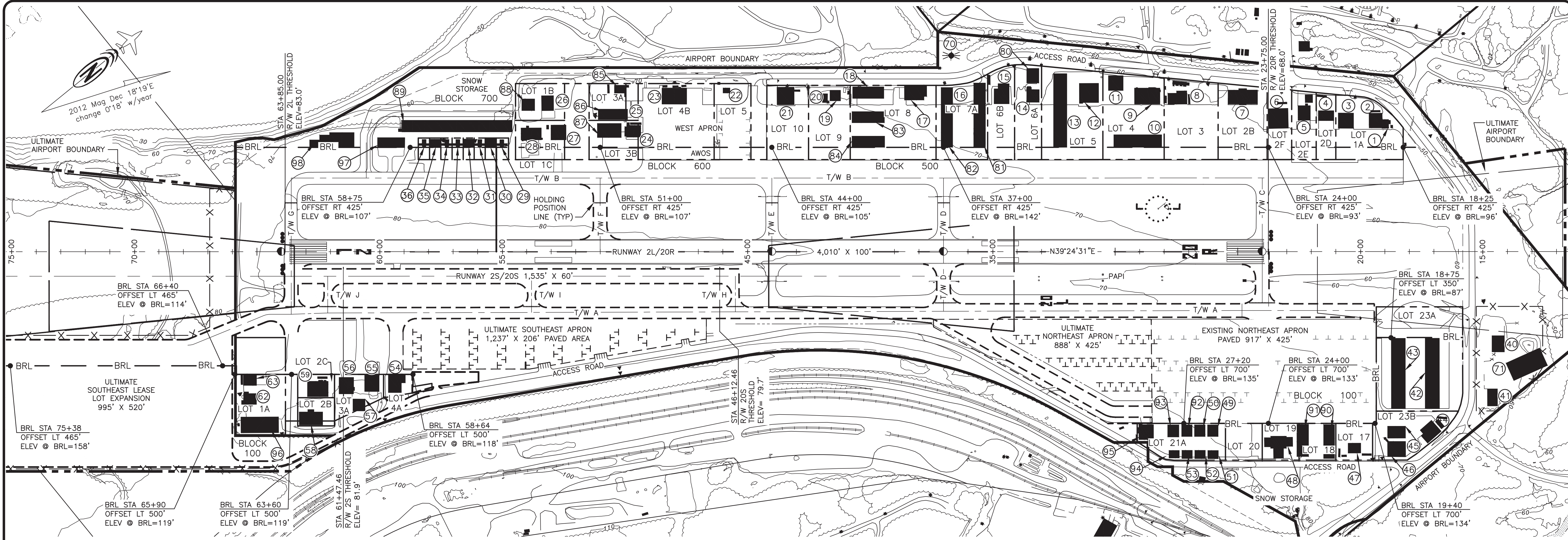

TERMINAL AREA BUILDING TABLE

No.	DESCRIPTION	TOP ELEVATION	LOT	BLOCK	OBSTRUCTION MARKING	STATION	OFFSET	COMMENT
1	OFFICE BUILDING	67	1A	500	NONE	18+85	500	
2	HANGAR	74	1A	500	NONE	19+15	501	
3	HANGAR	85	1A	500	NONE	20+28	503	
4	HANGAR	78	2D	500	NONE	21+08	534	
5	HANGAR	80	2E	500	NONE	22+04	534	
6	HANGAR	85	2F	500	NONE	22+94	503	
7	HANGAR	89	2B	500	NONE	24+19	602	
8	HANGAR	85	3	500	NONE	27+08	587	
9	HANGAR	87	4	500	NONE	28+17	601	
10	T HANGARS	83	4	500	NONE	28+10	425	
11	HANGAR	82	4	500	NONE	29+67	657	
12	HANGAR	90	5	500	NONE	30+67	608	
13	T HANGARS	83	5	500	NONE	31+97	425	
14	HANGAR	83	6A	500	NONE	33+11	608	
15	HANGAR	92	6B	500	NONE	34+32	602	
17	HANGAR	99	8	500	NONE	37+79	616	
18	T HANGARS	91	8	500	NONE	39+43	625	
19	HANGAR	90	9	500	NONE	41+20	615	
20	OFFICE BUILDING	87	9	500	NONE	41+73	608	
21	HANGAR	99	10	500	NONE	43+09	599	
22	PILOT SHELTER	86	5	600	NONE	45+71	646	
23	HANGAR	91	4B	600	NONE	47+47	601	
24	HANGAR	98	3B	600	NONE	49+59	465	
26	HANGAR	101	1B	600	NONE	52+10	574	
27	HANGAR	106	1C	600	NONE	52+39	455	
28	HANGAR	105	1C	600	NONE	53+43	455	
29	SINGLE T HANGER	88	1	700	NONE	54+79	432	
30	BOX HANGER	89	2	700	NONE	55+24	426	
31	SINGLE T HANGER	88	3	700	NONE	55+69	432	
32	BOX HANGER	88	4	700	NONE	56+15	425	
33	SINGLE T HANGER	88	5	700	NONE	56+58	433	

TERMINAL AREA BUILDING TABLE

No.	DESCRIPTION	TOP ELEVATION	LOT	BLOCK	OBSTRUCTION MARKING	STATION	OFFSET	COMMENT
34	SINGLE T HANGER	88	6	700	NONE	57+03	432	
35	BOX HANGER	89	7A	700	NONE	57+49	424	
36	SINGLE T HANGER	89	8	700	NONE	57+96	432	
40	FIRE STATION / SREB	81	--	100	NONE	14+15	343	
41	WARM STORAGE	88	--	100	NONE	14+41	559	
42	T HANGARS	87	23A	100	NONE	16+78	353	
43	T HANGARS	87	23A	100	NONE	18+17	353	
44	HANGAR	100	23B	100	NONE	17+10	687	
45	HANGAR	96	23B	100	NONE	18+16	712	
46	HANGAR	101	23B	100	NONE	18+16	774	
47	HANGAR	97	17	100	NONE	19+99	781	
48	HANGAR, OFFICE BUILDING	99	19	100	NONE	22+77	758	
49	HANGAR	102	20	100	NONE	25+80	705	
50	HANGAR	102	20	100	NONE	26+33	705	
51	HANGAR	103	21	100	NONE	25+79	810	
52	HANGAR	104	21	100	NONE	26+32	810	
53	HANGAR	104	21	100	NONE	26+85	810	
54	HANGAR	107	4A	100	NONE	58+95	501	
55	HANGAR	117	3A	100	NONE	60+02	503	
56	HANGAR	117	3A	100	NONE	61+06	512	
57	HANGAR	114	3A	100	NONE	60+59	601	
58	HANGAR	119	2B	100	NONE	62+32	653	
59	HANGAR	117	2C	100	NONE	62+10	529	
62	HANGAR	117	1A	100	NONE	65+04	567	
63	HANGAR	107	1A	100	NONE	65+04	502	
70	ROTATING BEACON TOWER	178	--	500	YES	36+68	799	
71	SAND STORAGE BUILDING	--	--	100	--	12+36	464	PROPOSED, MID TERM

TERMINAL AREA BUILDING TABLE

No.	DESCRIPTION	TOP ELEVATION	LOT	BLOCK	OBSTRUCTION MARKING	STATION	OFFSET	COMMENT
80	HANGAR		6A	500	NONE	33+11	687	
81	T HANGARS		7A	500	NONE	35+31	425	
82	T HANGARS		7A	500	NONE	36+62	425	
83	T HANGARS		8	500	NONE	39+41	525	
84	T HANGARS		8	500	NONE	39+39	425	
85	HANGAR		3A	600	NONE	49+95	631	
86	T HANGARS		3A	600	NONE	49+88	538	
87	HANGAR		3B	600	NONE	50+13	464	
88	HANGAR		1B	600	NONE	53+66	574	
89	10 BOX HANGARS		8	600	NONE	54+56	486	
90	HANGAR		18	100	NONE	21+04	705	
91	HANGAR		18	100	NONE	21+99	705	
92	HANGAR		21A	100	NONE	26+85	705	
93	HANGAR		21A	100	NONE	27+39	706	
94	HANGAR		21A	100	NONE	27+37	810	
95	HANGAR		21A	100	NONE	28+45	706	
96	HANGAR		1A	100	NONE	64+29	677	
97	HANGAR		14	700	NONE	58+98	425	
98	HANGAR		15	700	--	XX+XX	XXX	

NOTES

- BRL OFFSETS MEASURED FROM RUNWAY 2L/20R CENTERLINE.
- BUILDING STATION AND OFFSET TO FIRST CORNER OF BUILDING ENCOUNTERED GOING UP STATION.
- BUILDINGS 80 THROUGH 96 ADDED SINCE 2006.

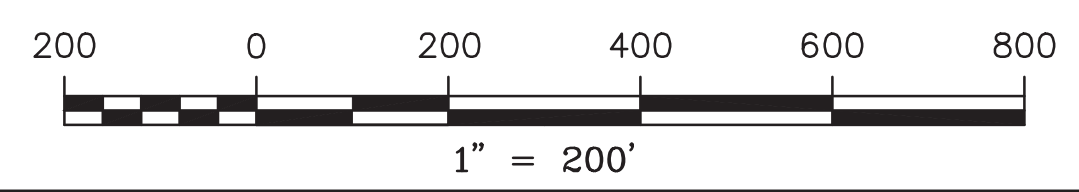

STATE OF ALASKA
DEPARTMENT OF TRANSPORTATION
AND PUBLIC FACILITIES
CENTRAL REGION

BIRCHWOOD AIRPORT
 BIRCHWOOD, ALASKA
 AIRPORT LAYOUT PLAN
 TERMINAL AREA

DATE: 6/14/2013
 SHEET: 5 OF 11

BY	DATE	REVISION
	07/2022	AS-BUILT PER CFAPT00275
	06/09/16	AS-BUILT PER 8-2015 SURVEY
	6/2013	TAXILANE RESERVATION ADDED

Date Plotted: 7/28/2022
 Layout Name: FULL PDF
 File Name: W:\Projects\Birchwood\ALP\Birchwood_ALP_2022\Airport_Layout_Plan\CAD\BIRCH_ALP_06_update.dwg
 Designed By: DJC
 Drawn By: LWW
 Checked By: JGW

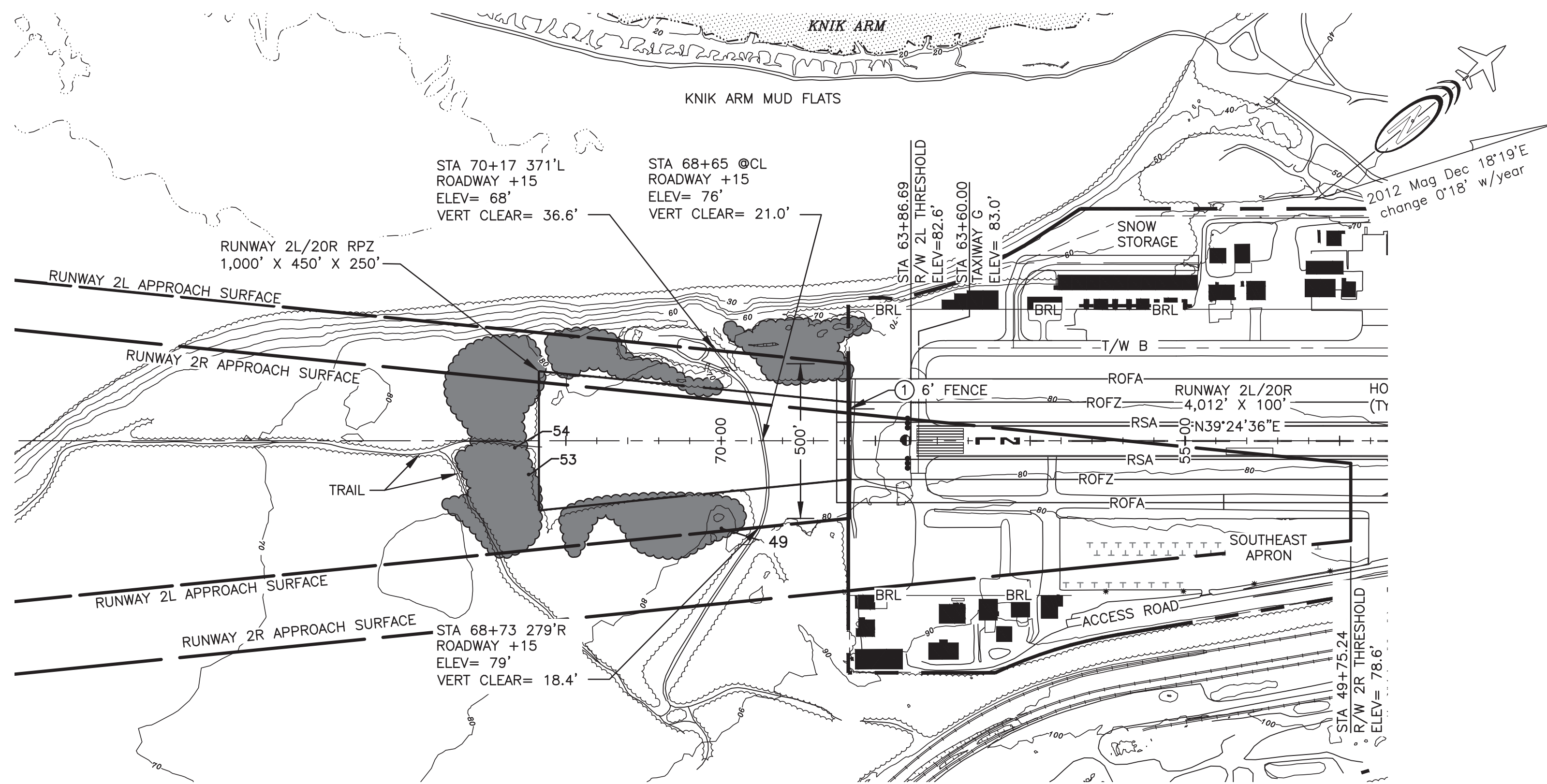

RUNWAY 2L & 2R

RUNWAY 2L TOUCHDOWN ZONE ELEV = 83.1' STATION 63+86.37

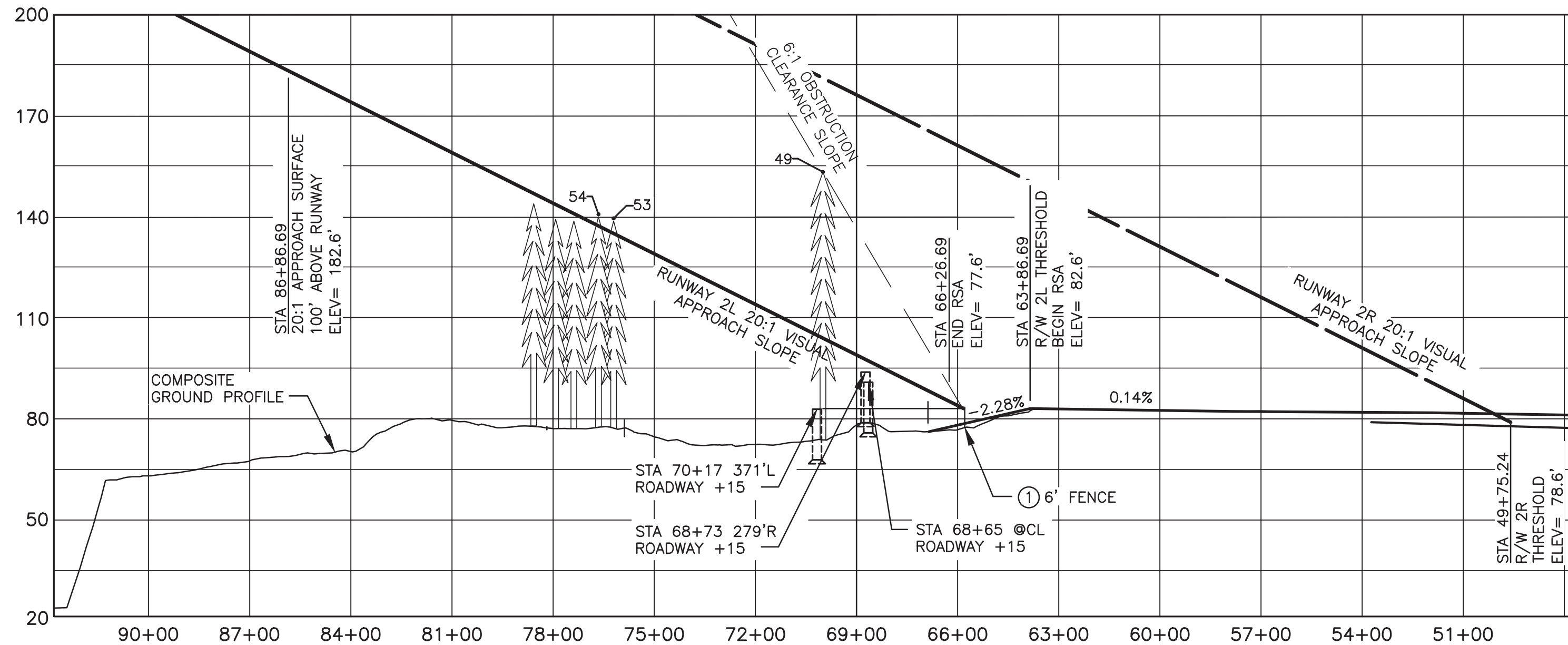

RUNWAY 2L & 2R

NOTES

- TREES ARE THE CONTROLLING OBSTRUCTIONS FOR RUNWAY 2L. THE EXISTING OBSTRUCTION CLEARANCE IS 6:1.
- THERE ARE OBJECT PENETRATIONS IN THE RUNWAY APPROACH END SITING SURFACES OF RUNWAY 2L AS DEFINED IN FAA 150/5300-13 CHG 15 APPENDIX 2, TABLE A2-1, LINE 2.
- THE SHADED AREAS IN THE PLAN VIEW REPRESENT GROUPS OF TREES THAT PENETRATE THE RUNWAY 2L APPROACH SURFACE, SEE SHEET 9 FOR TREE OBSTRUCTION DATA.
- THERE ARE OBJECT FREE AREA PENETRATIONS AT THE APPROACH END OF RUNWAY 2L. THE EXISTING PERIMETER FENCE CROSSES THE ROFA.

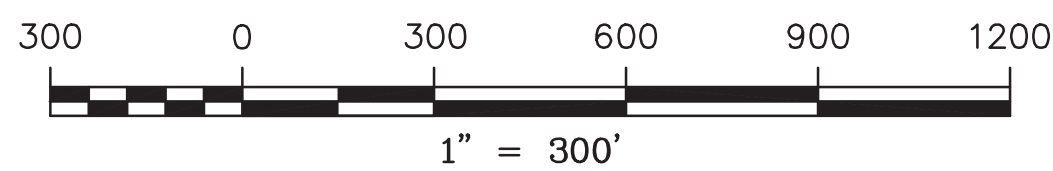

OBSTRUCTION TABLE					
OBSTRUCTION NUMBER	OBSTRUCTION ELEVATION	OBSTRUCTION	AMOUNT OF OBSTRUCTION	DESCRIPTION	DISPOSITION
①	83.43	YES	0.41	OBSTRUCTION TO 20:1 APPROACH SURFACE	ROUTE FENCE AROUND THE RSA

OBSTRUCTION CLEARANCE SLOPE DEFINED IN ORDER 5010.4 ITEM 57, PAGE 21.

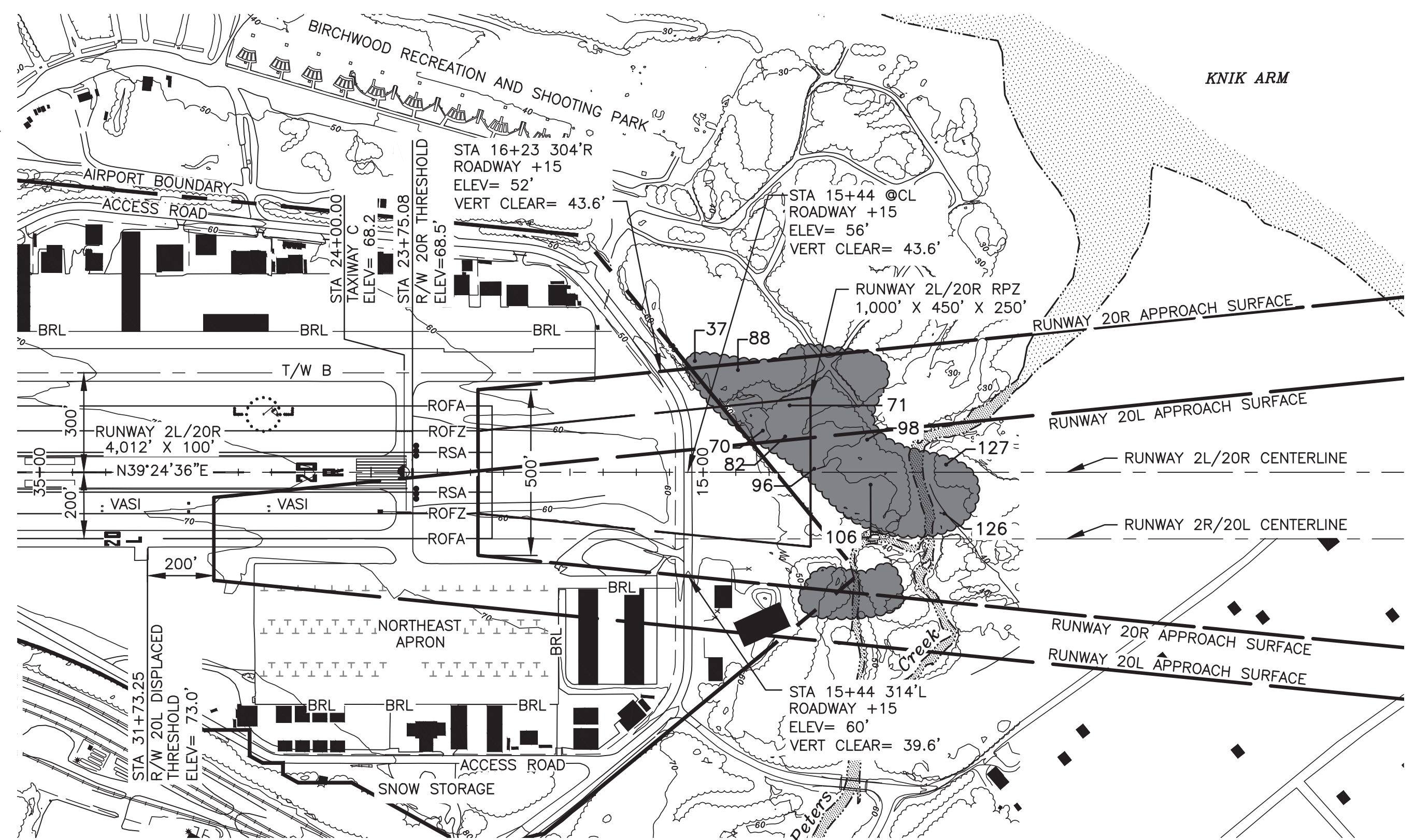

RUNWAY 20R & 20L

RUNWAY 20 TOUCHDOWN ZONE ELEV = 82.1' STATION 53+75.08, 3,000' FROM THRESHOLD

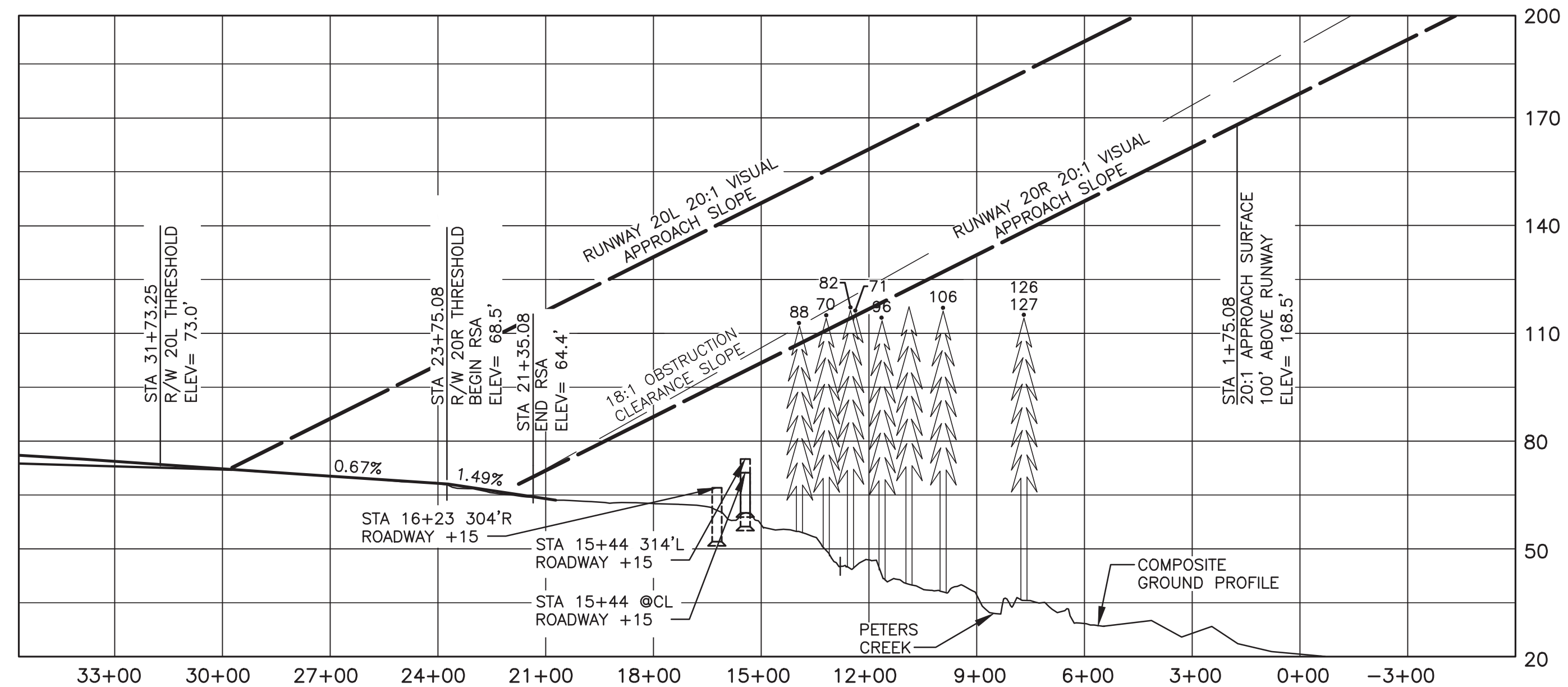

RUNWAY 20L & 20R

NOTES

- TREES ARE THE CONTROLLING OBSTRUCTIONS FOR RUNWAY 20R. THE EXISTING OBSTRUCTION CLEARANCE IS 18:1.
- THERE ARE OBJECT PENETRATIONS IN THE RUNWAY APPROACH END SITING SURFACES OF RUNWAY 20R AS DEFINED IN FAA 150/5300-13 CHG 15 APPENDIX 2, TABLE A2-1, LINE 2.
- THE SHADED AREAS IN THE PLAN VIEW REPRESENT GROUPS OF TREES THAT PENETRATE THE RUNWAY 20R APPROACH SURFACE, SEE SHEET 9 FOR TREE OBSTRUCTION DATA.

BY	DATE	REVISION
	07/2022	AS-BUILT PER CFAP00275
	06/09/16	AS-BUILT PER 8-2015 SURVEY
	6/2013	TAXILANE RESERVATION ADDED

STATE OF ALASKA
DEPARTMENT OF TRANSPORTATION
AND PUBLIC FACILITIES
CENTRAL REGION

BIRCHWOOD AIRPORT
 BIRCHWOOD, ALASKA
 AIRPORT LAYOUT PLAN
 INNER PORTION
 OF THE APPROACH SURFACES, EXISTING

DATE: 6/13/2013
 SHEET: 6 OF 11

Date Plotted: 8/6/2022
 Layout Name: Full Pdf
 File Name: W:\Projects\Birchwood\ALP\2022\Airport_Layout_Plan\CAD\BIRCH_ALP_07_updated.dwg
 Designed By: DJC
 Drawn By: LWW
 Checked By: JGW

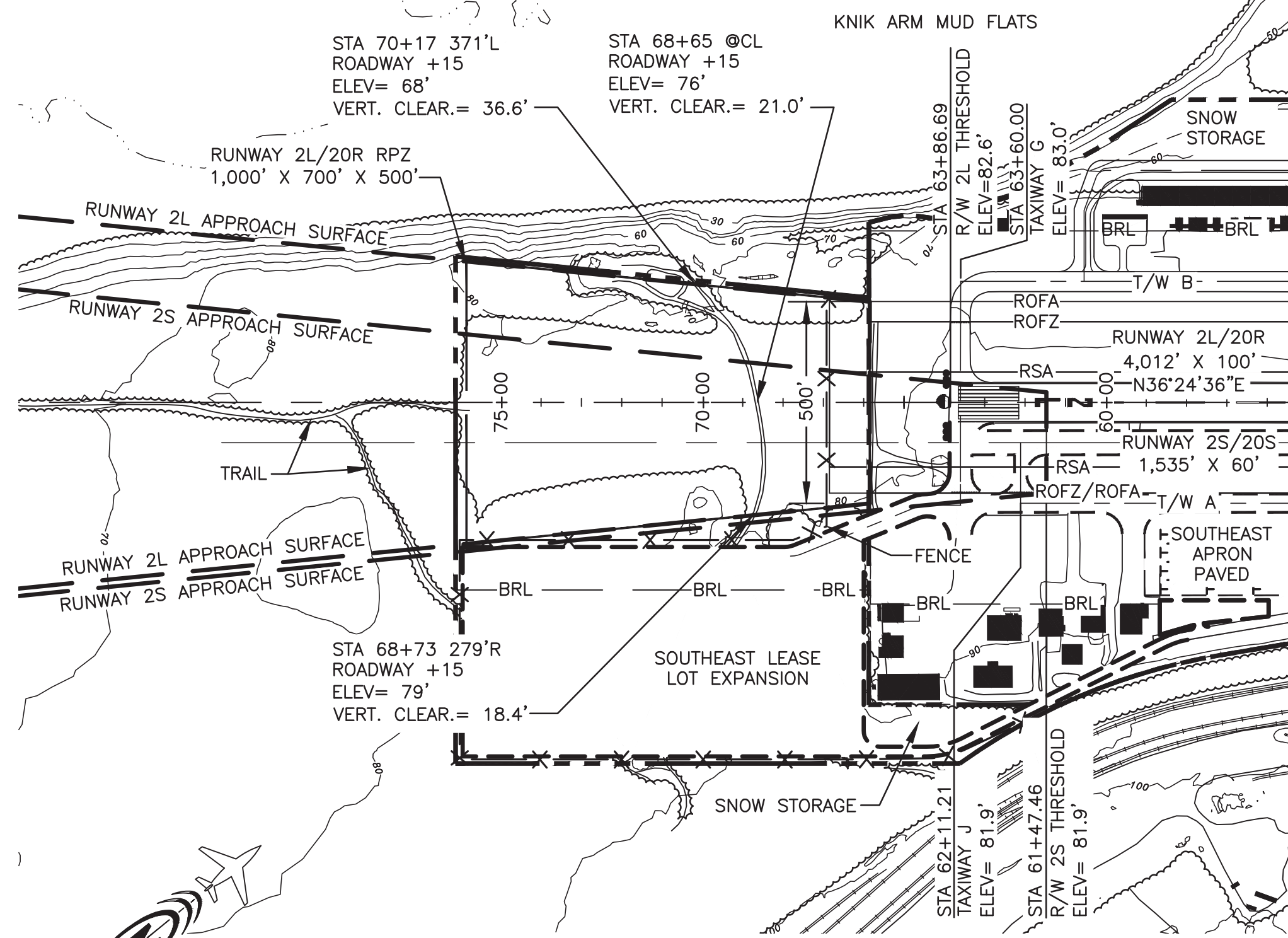

RUNWAY 2L & 2S

RUNWAY 2L TOUCHDOWN ZONE ELEV = 83.1' STATION 62+86.37

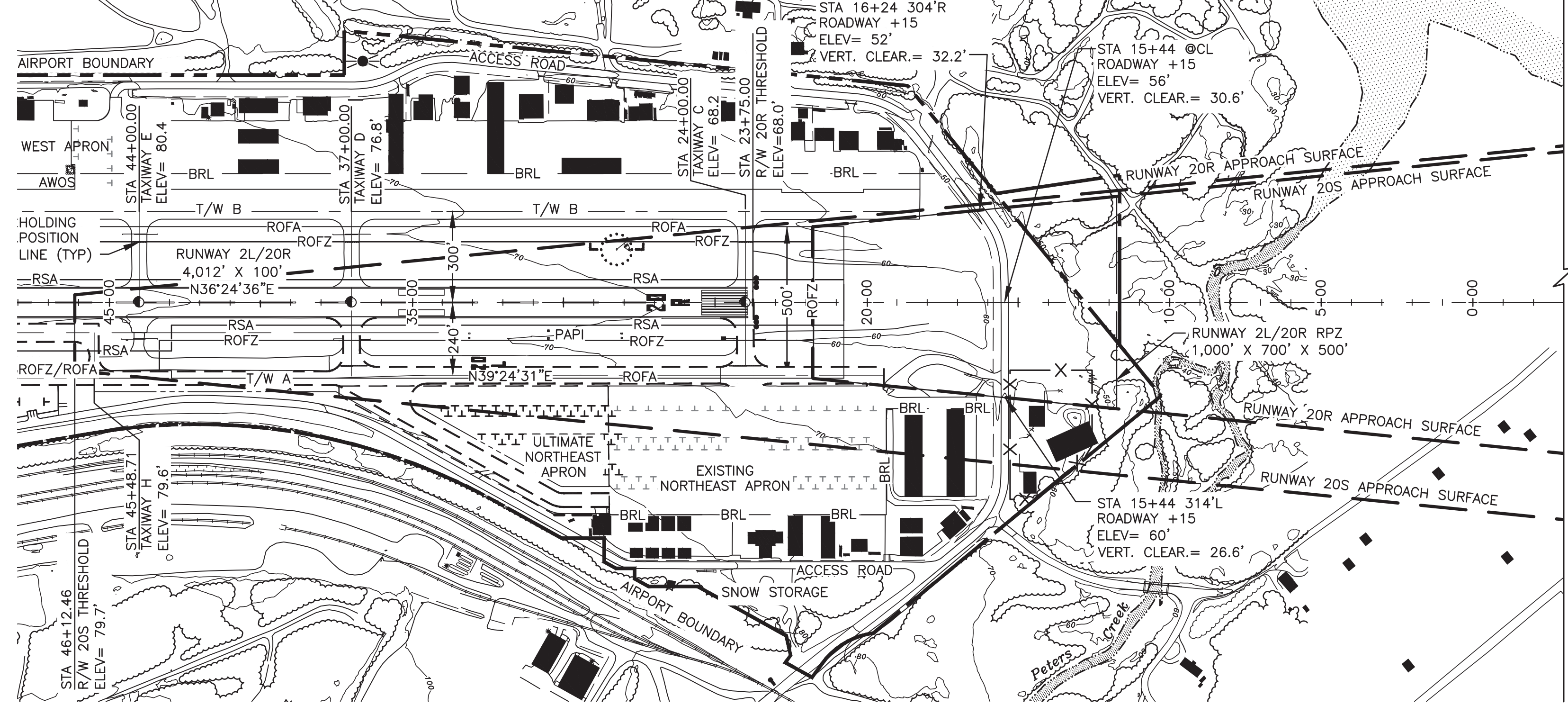

RUNWAY 20R & 20S

RUNWAY 20R TOUCHDOWN ZONE ELEV = 82.1' STATION 53+75.08, 3,000' FROM THRESHOLD

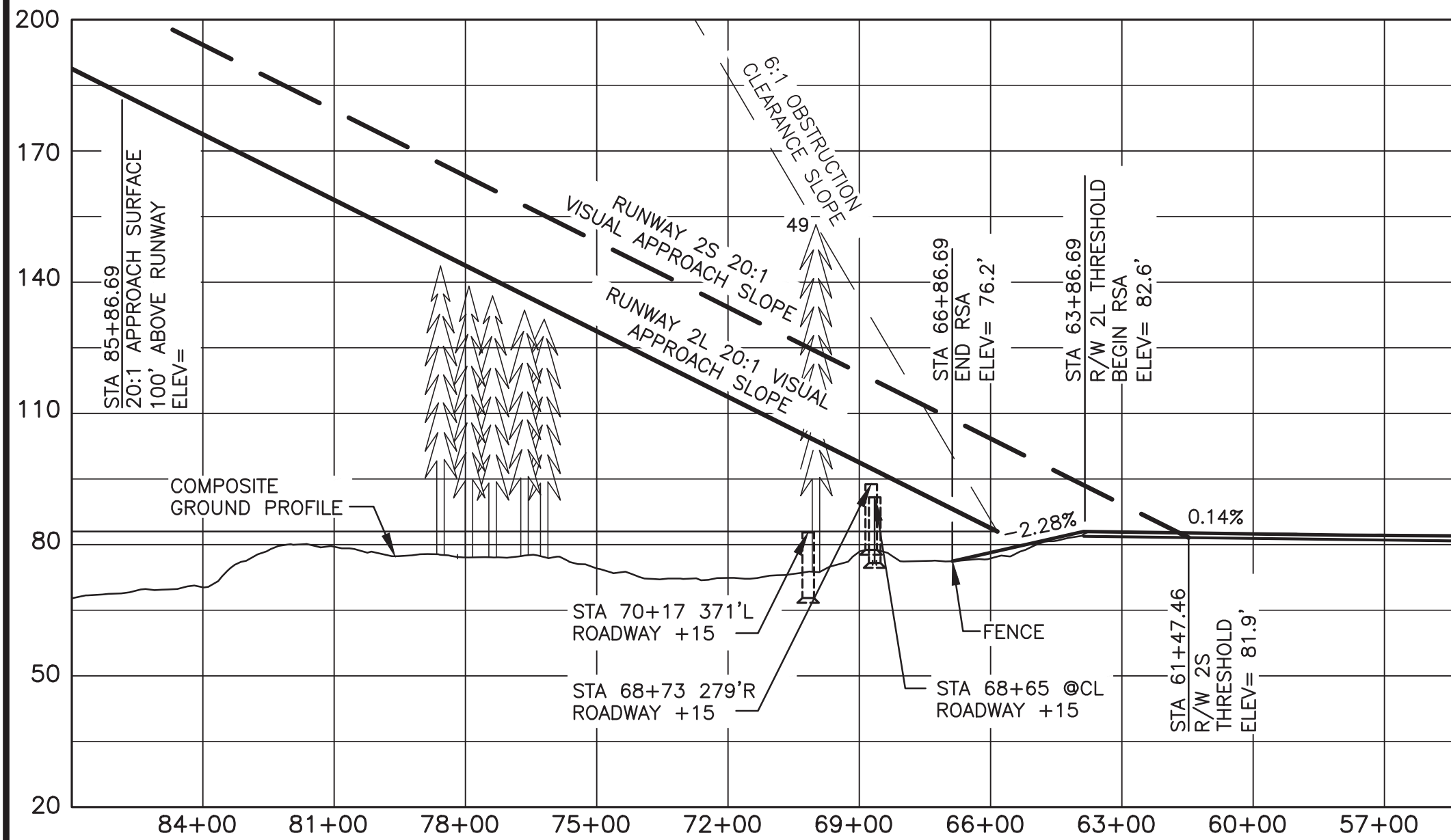

RUNWAY 2L & 2S

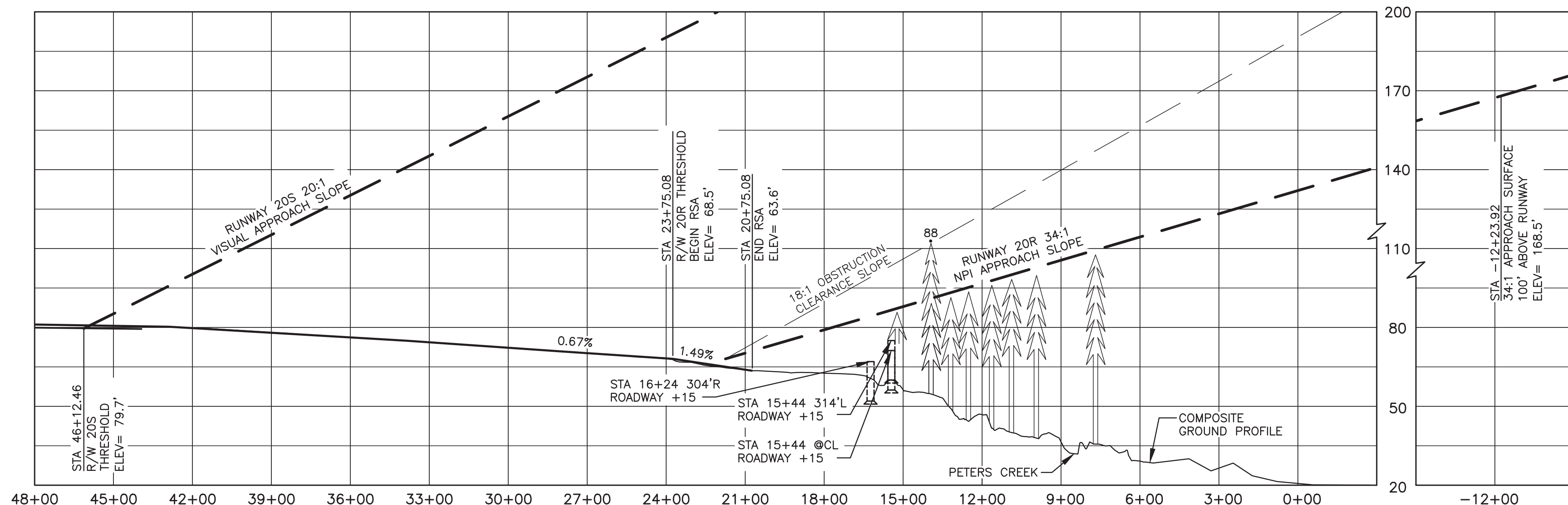

RUNWAY 20R & 20S

- NOTES**
- TREES ARE THE CONTROLLING OBSTRUCTIONS FOR RUNWAY 2L. THE ULTIMATE OBSTRUCTION CLEARANCE IS 20:1.
 - THERE ARE NO OBJECT PENETRATIONS IN THE RUNWAY APPROACH END SITING SURFACES OF RUNWAY 2L AS DEFINED IN FAA 150/5300-13 CHG 15 APPENDIX 2, TABLE A2-1, LINE 2.

- NOTES**
- TREES ARE THE CONTROLLING OBSTRUCTIONS FOR RUNWAY 20R. THE ULTIMATE OBSTRUCTION CLEARANCE IS 34:1.
 - THERE ARE NO OBJECT PENETRATIONS IN THE RUNWAY APPROACH END SITING SURFACES OF RUNWAY 20R AS DEFINED IN FAA 150/5300-13 CHG 15 APPENDIX 2, TABLE A2-1, LINE 5.

NOTE
 RUNWAY 2S/20S WILL REPLACE EXISTING RUNWAY 2R/20L.

OBSTRUCTION TABLE					
OBSTRUCTION NUMBER	OBSTRUCTION ELEVATION	OBSTRUCTION	AMOUNT OF OBSTRUCTION	DESCRIPTION	DISPOSITION
NONE				NO OBSTRUCTIONS	

OBSTRUCTION CLEARANCE SLOPE DEFINED IN ORDER 5010.4 ITEM 57, PAGE 21.

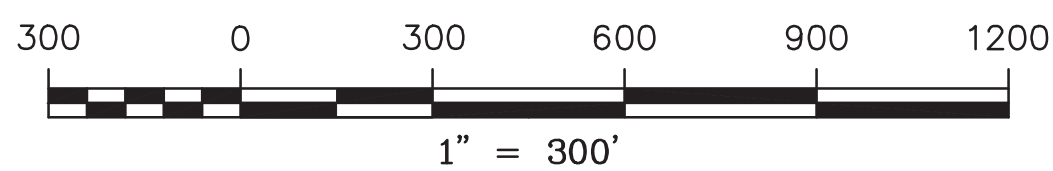

BY	DATE	REVISION
	07/2022	AS-BUILT PER CFAPTO0275
	06/09/16	AS-BUILT PER 8-2015 SURVEY
	6/2013	TAXILANE RESERVATION ADDED

STATE OF ALASKA
DEPARTMENT OF TRANSPORTATION
AND PUBLIC FACILITIES
CENTRAL REGION

BIRCHWOOD AIRPORT
 BIRCHWOOD, ALASKA
 AIRPORT LAYOUT PLAN

INNER PORTION
 OF THE APPROACH SURFACES, ULTIMATE

DATE: 6/13/2013
 SHEET: 7 OF 11

Date Plotted: 7/13/2022
 Layout Name: Full Pdf
 File Name: W:\Projects\Birchwood\ALP\Birchwood_ALP_2022\Airport_Layout\Plan\CAD\BIRCH_ALP_08_34-1_update.dwg
 Designed By: DJG
 Drawn By: LAW
 Checked By: JGW

PART 77 SURFACE OBSTRUCTIONS TABLE (OUTER PORTION)									
ID #	DESCRIPTION	STATION/OFFSET	ELEVATION	SURFACE PENETRATED	SURFACE ELEVATION	AMOUNT PENETRATION	DISPOSITION	STAGE TO CORRECT	
1	TOWER	29+22/8,683'	455'	HORIZONTAL	233'	222'	TO REMAIN	N/A	
2	TOWER	129+54/5,165'	276'	HORIZONTAL	233'	43'	TO REMAIN	N/A	

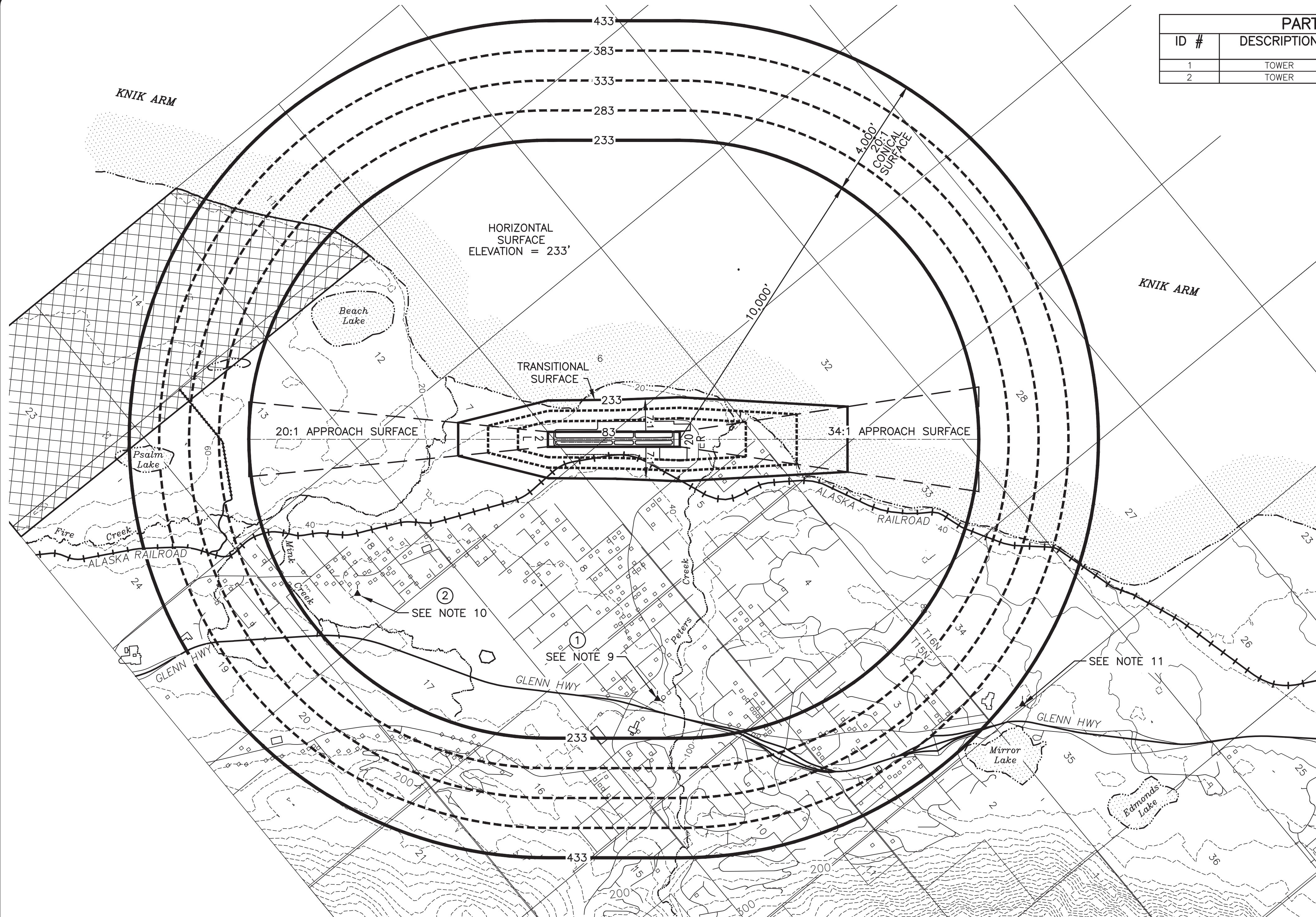
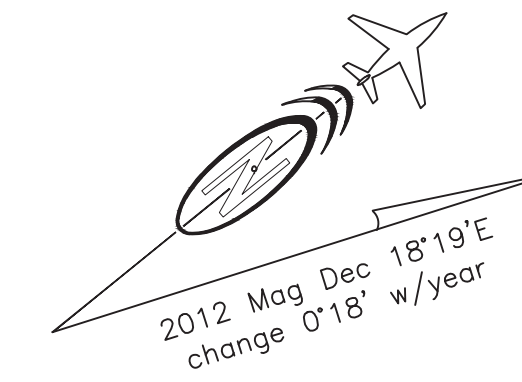

NOTES

- ELEVATIONS ARE IN FEET.
- AIRPORT ELEVATION IS 83.1' NAVD88 SEE NOTE 1, SHEET 1.
- HORIZONTAL SURFACE IS 150 FEET ABOVE AIRPORT ELEVATION.
- THIS DRAWING IS BASED ON U.S.G.S QUAD ANCHORAGE (B-7 NW) ALASKA 1979 (REV. 1993).
- REFER TO THE INNER PORTION OF THE APPROACH SURFACE PLAN VIEW DETAILS FOR CLOSE IN OBSTRUCTIONS, SHEETS 6 AND 7.
- SEE SHEET 9 FOR TREE OBSTRUCTIONS TO APPROACH AND TRANSITION SURFACES.
- RUNWAY 2L/20R PRIMARY SURFACE IS 500' WIDE. RUNWAY 2R/20L PRIMARY SURFACE IS 250' WIDE.
- RUNWAY 2S/20S PRIMARY AND APPROACH SURFACES CONTAINED WITHIN RUNWAY 2L/20R SURFACES.
- CELL TOWER ASN# 2010-AAL-250-OE SITE ELEV 325'; TOWER HEIGHT; 130'; TOTAL HEIGHT MSL 455' 1.43nm FROM AIRPORT
- CELL TOWER ASN# 2002-AAL-104-OE SITE ELEV 196'; TOWER HEIGHT; 80'; TOTAL HEIGHT MSL 276' 1.63nm FROM AIRPORT
- CELL TOWER ASN# 1996-AAL-113-OE SITE ELEV 340'; TOWER HEIGHT; 95'; TOTAL HEIGHT MSL 435' 2.68nm FROM AIRPORT
- NO SEWAGE OR SOLID WASTE FACILITY WITHIN 10,000' OF AIRPORT.
- HEIGHT RESTRICTIONS ARE IN EFFECT. SEE ANCHORAGE MUNICIPAL CHARTER, TITLE 21, CHAPTER 21.65 AIRPORT HEIGHT ZONING REGULATIONS.

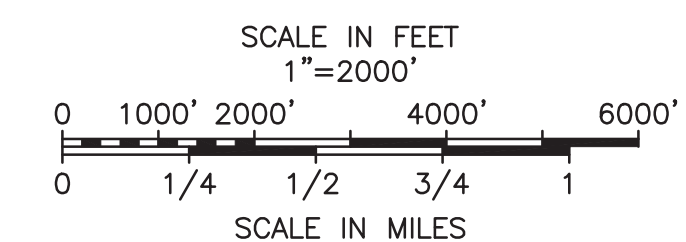
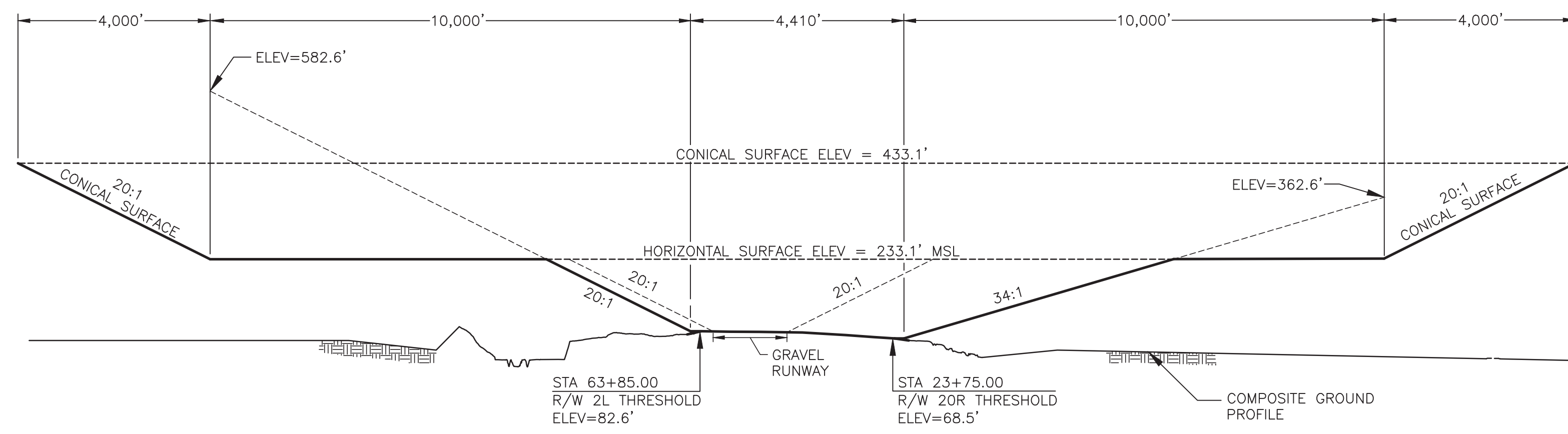

LEGEND

FORT RICHARDSON RESTRICTED AREA R-2203B. SURFACE TO 11,000'

STATE OF ALASKA
DEPARTMENT OF TRANSPORTATION
AND PUBLIC FACILITIES
CENTRAL REGION

BIRCHWOOD AIRPORT
 BIRCHWOOD, ALASKA
 AIRPORT LAYOUT PLAN

F.A.R. PART 77 AIRSPACE

DATE: 6/26/2012
 SHEET: 8 OF 11

BY	DATE	REVISION
	07/2022	AS-BUILT PER CFAP00275
	06/09/16	AS-BUILT PER 8-2015 SURVEY

F.A.R. PART 77 IMAGINARY SURFACE COMPOSITE GROUND PROFILE

Date Plotted: 7/13/2022
 Layout Name: Full Pdf
 File Name: W:\Projects\Birchwood\ALP_2022\Airport_Layout_Plan\CAD\BIRCH_ALP_09_update.dwg
 Designed By: DUC
 Drawn By: LWJ
 Checked By: JGW

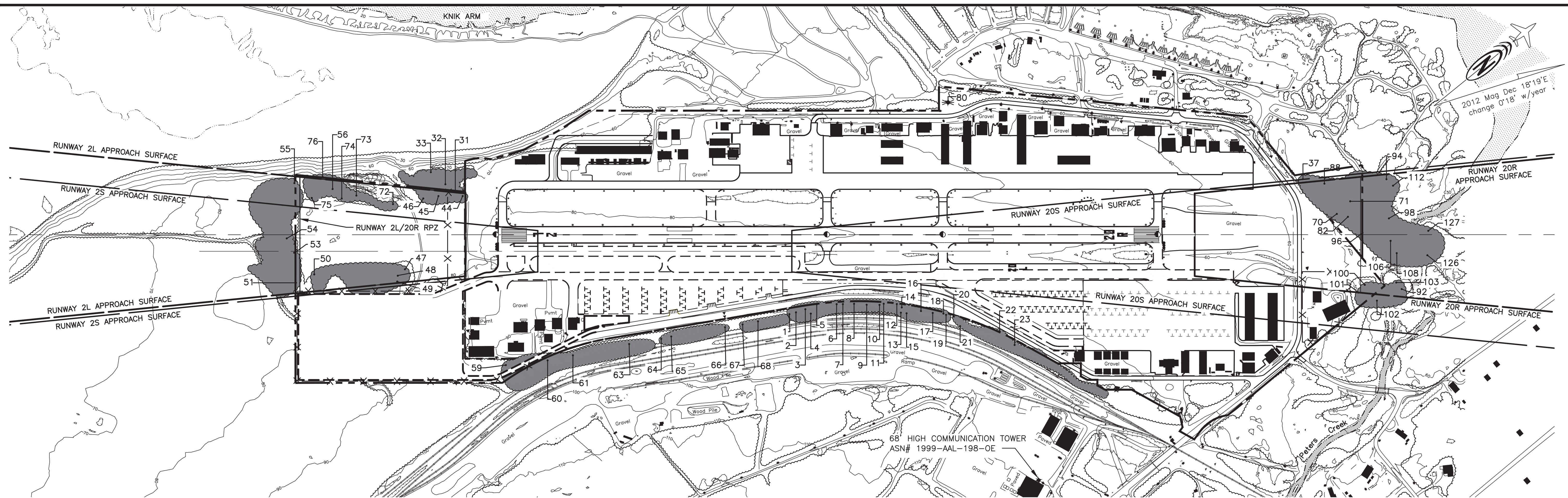

OBSTRUCTION TABLE					
OBSTRUCTION NUMBER	OBSTRUCTION ELEVATION	OBSTRUCTION	AMOUNT OF OBSTRUCTION	DESCRIPTION	DISPOSITION
1	135.2	YES	21.6	OBSTRUCTION TO 7:1 TRANSITIONAL SURFACE	REMOVE
2	134.1	YES	22.2	OBSTRUCTION TO 7:1 TRANSITIONAL SURFACE	REMOVE
3	133.4	YES	24.2	OBSTRUCTION TO 7:1 TRANSITIONAL SURFACE	REMOVE
4	132.2	YES	19.4	OBSTRUCTION TO 7:1 TRANSITIONAL SURFACE	REMOVE
5	127.4	YES	22.6	OBSTRUCTION TO 7:1 TRANSITIONAL SURFACE	REMOVE
6	134.8	YES	30.4	OBSTRUCTION TO 7:1 TRANSITIONAL SURFACE	REMOVE
7	133.5	YES	29.2	OBSTRUCTION TO 7:1 TRANSITIONAL SURFACE	REMOVE
8	135.1	YES	31.3	OBSTRUCTION TO 7:1 TRANSITIONAL SURFACE	REMOVE
9	139.7	YES	35.5	OBSTRUCTION TO 7:1 TRANSITIONAL SURFACE	REMOVE
10	142.6	YES	38.7	OBSTRUCTION TO 7:1 TRANSITIONAL SURFACE	REMOVE
11	141.3	YES	38.5	OBSTRUCTION TO 7:1 TRANSITIONAL SURFACE	REMOVE
12	139.9	YES	37.3	OBSTRUCTION TO 7:1 TRANSITIONAL SURFACE	REMOVE
13	140.1	YES	30.2	OBSTRUCTION TO 7:1 TRANSITIONAL SURFACE	REMOVE
14	140.3	YES	34.9	OBSTRUCTION TO 7:1 TRANSITIONAL SURFACE	REMOVE
15	138.7	YES	28.5	OBSTRUCTION TO 7:1 TRANSITIONAL SURFACE	REMOVE
16	138.9	YES	31.2	OBSTRUCTION TO 7:1 TRANSITIONAL SURFACE	REMOVE
17	135.1	YES	26.2	OBSTRUCTION TO 7:1 TRANSITIONAL SURFACE	REMOVE
18	134.5	YES	25.5	OBSTRUCTION TO 7:1 TRANSITIONAL SURFACE	REMOVE
19	145.0	YES	35.0	OBSTRUCTION TO 7:1 TRANSITIONAL SURFACE	REMOVE
20	132.6	YES	21.4	OBSTRUCTION TO 7:1 TRANSITIONAL SURFACE	REMOVE
21	135.9	YES	16.6	OBSTRUCTION TO 7:1 TRANSITIONAL SURFACE	REMOVE
22	140.1	YES	17.7	OBSTRUCTION TO 7:1 TRANSITIONAL SURFACE	REMOVE
23	143.4	YES	9.9	OBSTRUCTION TO 7:1 TRANSITIONAL SURFACE	REMOVE
31	133.5	YES	47.2	OBSTRUCTION TO 7:1 TRANSITIONAL SURFACE	REMOVE
32	142.4	YES	48.1	OBSTRUCTION TO 7:1 TRANSITIONAL SURFACE	REMOVE
33	151.0	YES	43.8	OBSTRUCTION TO 7:1 TRANSITIONAL SURFACE	REMOVE
37	117.6	YES	17.2	OBSTRUCTION TO 34:1 APPROACH SURFACE	REMOVE
44	126.5	YES	42.8	OBSTRUCTION TO 20:1 APPROACH SURFACE	REMOVE
45	130.5	YES	39.5	OBSTRUCTION TO 20:1 APPROACH SURFACE	REMOVE
46	137.7	YES	42.1	OBSTRUCTION TO 20:1 APPROACH SURFACE	REMOVE
47	141.1	YES	39.9	OBSTRUCTION TO 20:1 APPROACH SURFACE	REMOVE
48	148.5	YES	45.4	OBSTRUCTION TO 20:1 APPROACH SURFACE	REMOVE
49	153.4	YES	50.1	OBSTRUCTION TO 20:1 APPROACH SURFACE	REMOVE
50	139.4	YES	10.9	OBSTRUCTION TO 20:1 APPROACH SURFACE	REMOVE
51	142.5	YES	8.4	OBSTRUCTION TO 20:1 APPROACH SURFACE	REMOVE

OBSTRUCTION TABLE					
OBSTRUCTION NUMBER	OBSTRUCTION ELEVATION	OBSTRUCTION	AMOUNT OF OBSTRUCTION	DESCRIPTION	DISPOSITION
53	138.6	YES	4.0	OBSTRUCTION TO 20:1 APPROACH SURFACE	REMOVE
54	139.8	YES	2.9	OBSTRUCTION TO 20:1 APPROACH SURFACE	REMOVE
55	135.5	YES	1.0	OBSTRUCTION TO 20:1 APPROACH SURFACE	REMOVE
56	146.1	YES	22.8	OBSTRUCTION TO 20:1 APPROACH SURFACE	REMOVE
59	161.3	YES	1.6	OBSTRUCTION TO 7:1 TRANSITIONAL SURFACE	REMOVE
60	164.1	YES	8.8	OBSTRUCTION TO 7:1 TRANSITIONAL SURFACE	REMOVE
61	155.9	YES	5.2	OBSTRUCTION TO 7:1 TRANSITIONAL SURFACE	REMOVE
63	152.0	YES	11.4	OBSTRUCTION TO 7:1 TRANSITIONAL SURFACE	REMOVE
64	148.0	YES	11.9	OBSTRUCTION TO 7:1 TRANSITIONAL SURFACE	REMOVE
65	150.1	YES	16.2	OBSTRUCTION TO 7:1 TRANSITIONAL SURFACE	REMOVE
66	139.3	YES	13.8	OBSTRUCTION TO 7:1 TRANSITIONAL SURFACE	REMOVE
67	144.3	YES	21.4	OBSTRUCTION TO 7:1 TRANSITIONAL SURFACE	REMOVE
68	140.0	YES	20.0	OBSTRUCTION TO 7:1 TRANSITIONAL SURFACE	REMOVE
70	114.2	YES	3.5	OBSTRUCTION TO 34:1 APPROACH SURFACE	REMOVE
71	115.5	YES	0.8	OBSTRUCTION TO 34:1 APPROACH SURFACE	REMOVE
72	126.7	YES	21.9	OBSTRUCTION TO 20:1 APPROACH SURFACE	REMOVE
73	141.1	YES	25.3	OBSTRUCTION TO 20:1 APPROACH SURFACE	REMOVE
74	140.7	YES	20.5	OBSTRUCTION TO 20:1 APPROACH SURFACE	REMOVE
75	135.3	YES	6.0	OBSTRUCTION TO 20:1 APPROACH SURFACE	REMOVE
76	142.6	YES	16.6	OBSTRUCTION TO 20:1 APPROACH SURFACE	REMOVE
ROTATING BEACON					
80	120.5	YES	7.6	OBSTRUCTION TO 7:1 TRANSITIONAL SURFACE	REMAIN
82	116.4	YES	2.3	OBSTRUCTION TO 34:1 APPROACH SURFACE	REMOVE
88	112.0	YES	21.0	OBSTRUCTION TO 34:1 APPROACH SURFACE	REMOVE
92	108.5	YES	19.7	OBSTRUCTION TO 34:1 APPROACH SURFACE	REMOVE
94	115.7	YES	13.7	OBSTRUCTION TO 34:1 APPROACH SURFACE	REMOVE
96	113.5	YES	15.7	OBSTRUCTION TO 34:1 APPROACH SURFACE	REMOVE
98	105.1	YES	2.6	OBSTRUCTION TO 34:1 APPROACH SURFACE	REMOVE
100	111.6	YES	13.4	OBSTRUCTION TO 34:1 APPROACH SURFACE	REMOVE
101	116.3	YES	19.2	OBSTRUCTION TO 34:1 APPROACH SURFACE	REMOVE
102	117.4	YES	17.0	OBSTRUCTION TO 34:1 APPROACH SURFACE	REMOVE
103	107.7	YES	3.9	OBSTRUCTION TO 34:1 APPROACH SURFACE	REMOVE
106	116.2	YES	13.4	OBSTRUCTION TO 34:1 APPROACH SURFACE	REMOVE
108	112.5	YES	8.6	OBSTRUCTION TO 34:1 APPROACH SURFACE	REMOVE
112	110.7	YES	7.5	OBSTRUCTION TO 34:1 APPROACH SURFACE	REMOVE
126	114.3	YES	5.0	OBSTRUCTION TO 34:1 APPROACH SURFACE	REMOVE
127	115.2	YES	5.7	OBSTRUCTION TO 34:1 APPROACH SURFACE	REMOVE

NOTES

1. THE SHADED AREAS REPRESENT A GROUP OF TREES THAT PENETRATE THE PART 77 TRANSITIONAL SURFACE.
2. THE OBSTRUCTION NUMBER IDENTIFIES REPRESENTATIVE TREES OF EACH GROUP. ALL OBSTRUCTIONS EXCEPT THE ROTATING BEACON ARE TREES.
3. OBSTRUCTION ELEVATION IS THE ELEVATION OF THE TREE TOPS.
4. AMOUNT OF OBSTRUCTION IS THE LENGTH OF TREE ABOVE THE PART 77 SURFACE.
5. RUNWAY ELEVATION IS 83' NAVD88.
6. ELEVATIONS ARE IN FEET.
7. TREE HEIGHTS DETERMINED BY PHOTOGRAMMETRIC METHODS FROM AERIAL PHOTOGRAPHY ACQUIRED ON 5-26-2000.
8. BEFORE OBSTRUCTION REMOVAL A MORE COMPLETE OBSTRUCTION SURVEY SHOULD BE COMPLETED.

LEGEND

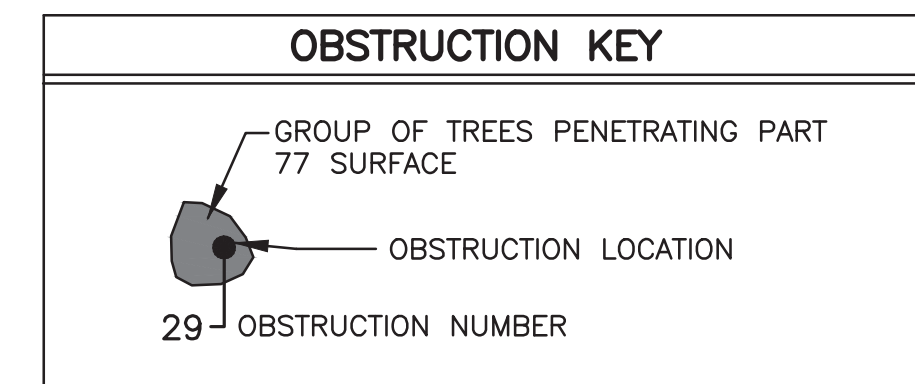

STATE OF ALASKA
DEPARTMENT OF TRANSPORTATION
AND PUBLIC FACILITIES
CENTRAL REGION

BIRCHWOOD AIRPORT
 BIRCHWOOD, ALASKA
 AIRPORT LAYOUT PLAN

DATE: 6/13/2013
 SHEET: 9 OF 11
 F.A.R. PART 77 AIRSPACE OBSTRUCTIONS

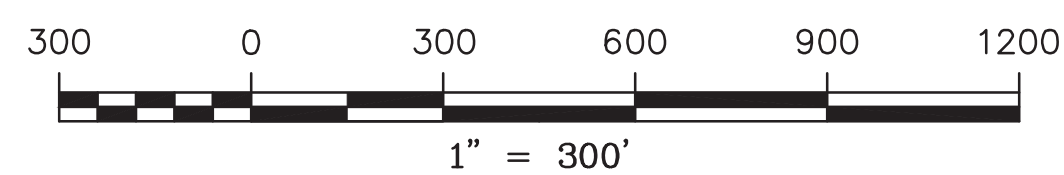

BY	DATE	REVISION
	07/2022	AS-BUILT PER CFAPT00275
	06/09/16	AS-BUILT PER 8-2015 SURVEY
	6/2013	TAXILANE RESERVATION ADDED

AIRPORT LAND USE LEGEND

- A** AVIATION USE
- A-TA** AIRPORT TERMINAL AREA AIRSIDE
- A-M** AIRPORT MAINTENANCE & SUPPORT
- A-TL** AIRPORT TERMINAL AREA LANDSIDE
- R-YR** ARRC RAIL YARD RESERVE

ZONE = I1SL
 I1SL = LIGHT INDUSTRIAL
 I2SL = HEAVY INDUSTRIAL
 PLI = PUBLIC LANDS & INSTITUTIONS
 R6 = SUBURBAN RESIDENTIAL
 T = TRANSITION, NONRESIDENTIAL

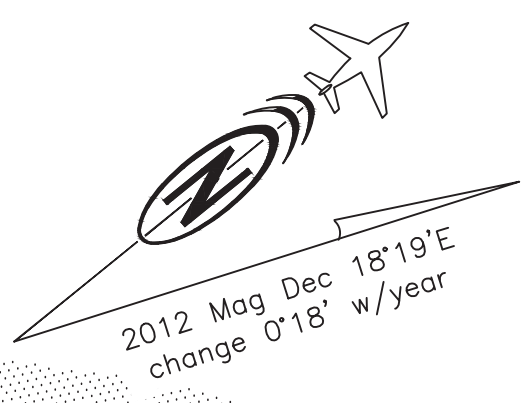

Date Plotted: 7/13/2022
 Layout Name: Full Pdf
 File Name: W:\Projects\Birchwood_ALP\Birchwood_ALP_2022\Airport_Layout_Plan_CAD\BIRCH_ALP-10_update.dwg
 Designed By: DJC
 Drawn By: LWJ
 Checked By: JGW

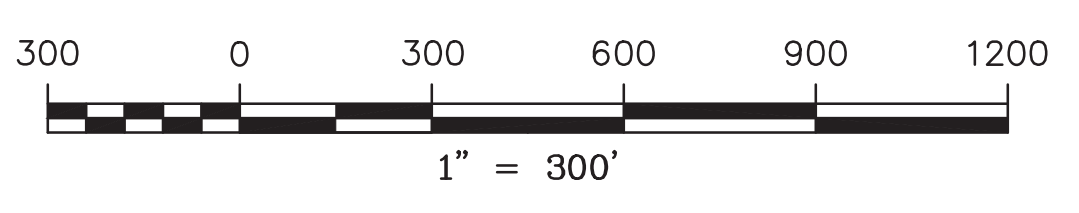
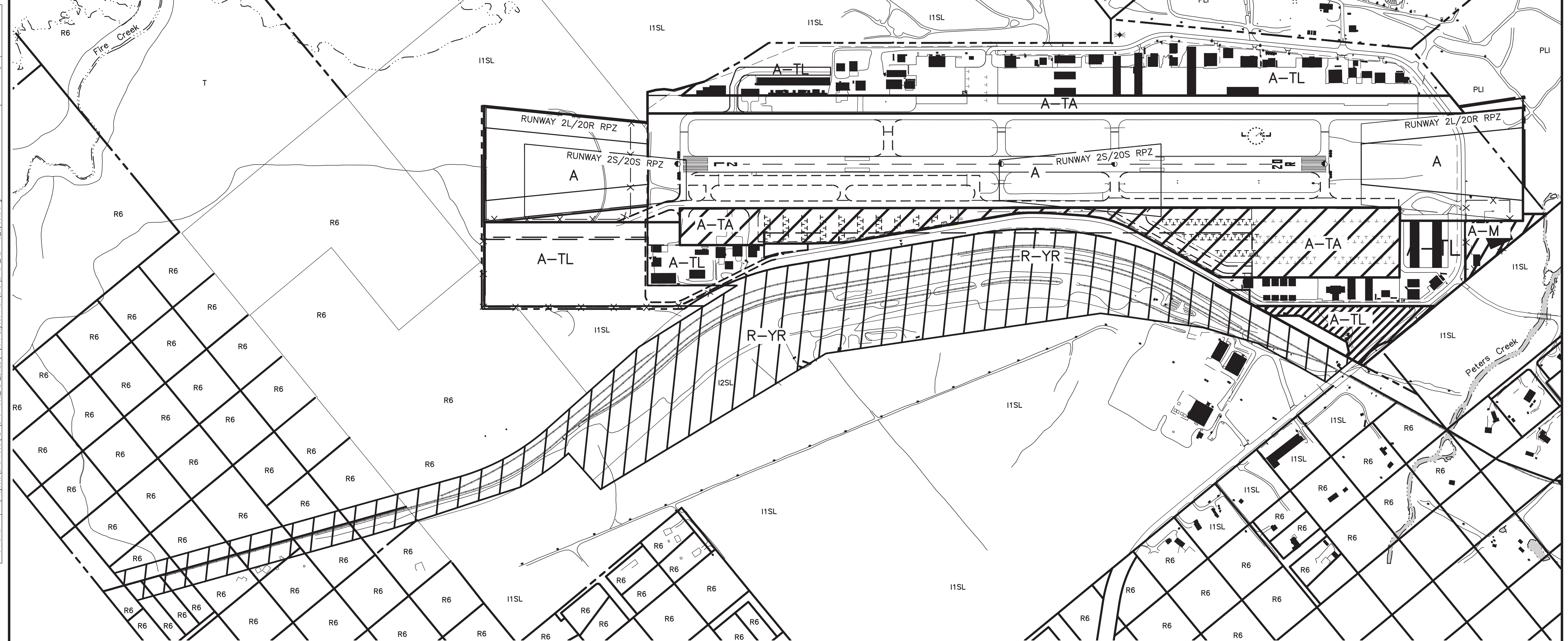

**STATE OF ALASKA
 DEPARTMENT OF TRANSPORTATION
 AND PUBLIC FACILITIES
 CENTRAL REGION**

BY	DATE	REVISION
	07/2022	AS-BUILT PER CFAPT00275
	06/09/16	AS-BUILT PER 8-2015 SURVEY
	6/2013	TAXILANE RESERVATION ADDED

BIRCHWOOD AIRPORT
 BIRCHWOOD, ALASKA
 AIRPORT LAYOUT PLAN
 LAND USE PLAN

DATE: 6/13/2013
 SHEET: 10 OF 11

AIRPORT LAND ACQUISITION

LOCATION	PURPOSE	SIZE (ACRE)	OWNER
1	RPZ	14.5	EKLUTNA, INC
2	RPZ	2.4	IZAAK WALTON
3	LEASE LOT EXPANSION	12.0	EKLUTNA, INC

LEGEND



AIRPORT PROPERTY TO BE ACQUIRED
SEE AIRPORT LAND ACQUISITION TABLE

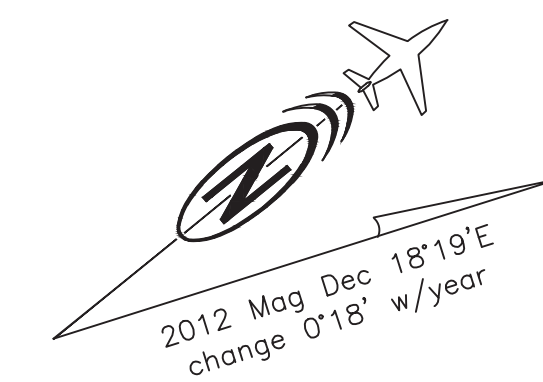

Date Plotted: 7/13/2022
 Layout Name: Full Pdf
 File Name: W:\Projects\Birchwood\ALP\Birchwood_ALP_2022\Airport_Layout_Plan_GAD\BIRCH_ALP-11_update.dwg
 Designed By: DJG
 Drawn By: LWW
 Checked By: JGW

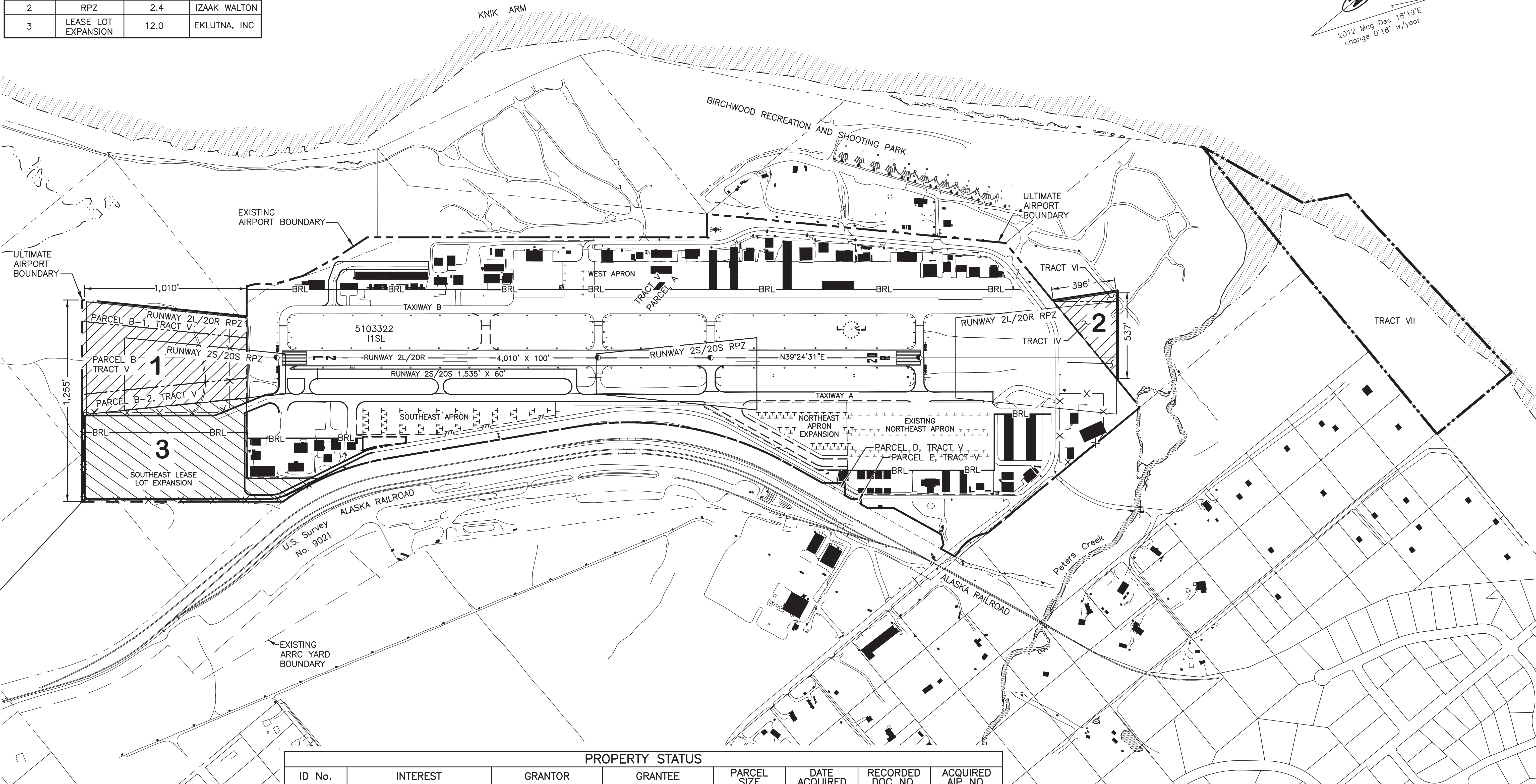

PROPERTY STATUS

ID No.	INTEREST	GRANTOR	GRANTEE	PARCEL SIZE	DATE ACQUIRED	RECORDED DOC NO.	ACQUIRED AIP NO.
TR IV	PERMIT NAVIGATION & HAZARD EASEMENT CORRECTED A & H ESMT.	IZAAK WALTON LEAGUE	STATE OF ALASKA, DOT/PF	2.15± ac	12/29/75	BK 75, Pg 416	--
TR V, PCL A	QCD-SURFACE EST. 14(c)(4) - ANCSA	EKLUTNA, INC.	STATE OF ALASKA, DOT/PF	166± ac	7/8/81	BK 617, Pg 667	--
TR V, PCL B	PERMIT AVIGATION & HAZARD EASEMENT (FEE TITLE)	EKLUTNA, INC. (TO BE ACQUIRED)	STATE OF ALASKA, DOT/PF	8.04± ac	8/31/78	BK 332, Pg 936	--
TR V, PCL B-1	FEE TITLE	TO BE ACQUIRED	STATE OF ALASKA, DOT/PF	2.58± ac	--	--	--
TR V, PCL B-2	FEE TITLE	TO BE ACQUIRED	STATE OF ALASKA, DOT/PF	2.58± ac	--	--	--
TR V, PCL D	QCD - SURFACE EST.	EKLUTNA, INC.	STATE OF ALASKA, DOT/PF	0.13± ac	4/24/87	BK 1596, Pg 297	--
TR V, PCL E	QCD - SURFACE EST.	EKLUTNA, INC.	STATE OF ALASKA, DOT/PF	0.02± ac	4/24/87	BK 1596, Pg 297	--
TR VI	PERMIT AVIGATION & HAZARD EASEMENT	IZAAK WALTON LEAGUE	STATE OF ALASKA, DOT/PF	0.26± ac	12/22/88	BK 1845, Pg 168	--
TR VII	PERMIT AVIGATION & HAZARD EASEMENT	MUNICIPALITY OF ANCHORAGE	STATE OF ALASKA, DOT/PF	22.78± ac	12/9/94	BK 2785, Pg 600	--

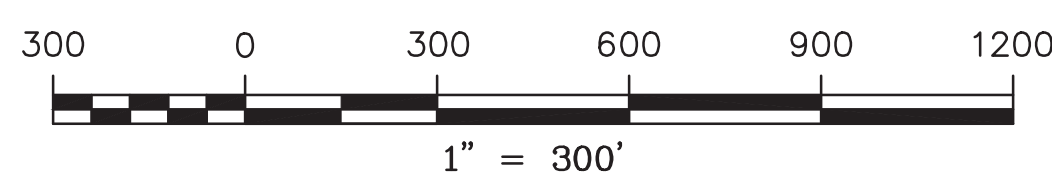

**STATE OF ALASKA
DEPARTMENT OF TRANSPORTATION
AND PUBLIC FACILITIES
CENTRAL REGION**

BIRCHWOOD AIRPORT
BIRCHWOOD, ALASKA
AIRPORT LAYOUT PLAN

PROPERTY MAP

DATE:	6/13/2013
SHEET:	11 OF 11
REVISION	07/2022 AS-BUILT PER CFAP00275 06/09/16 AS-BUILT PER 8-2015 SURVEY 6/2013 TAXILANE RESERVATION ADDED