

FILE G:\sit\681000\planset\2017 Options\Opt. 2\681000\_A1\_Tsht.dwg DATE 5/4/2017 14:02 LAYOUT A1 DESIGNED NG CHECKED CT DRAFTED RC, NG

# STATE OF ALASKA

## DEPARTMENT OF TRANSPORTATION & PUBLIC FACILITIES

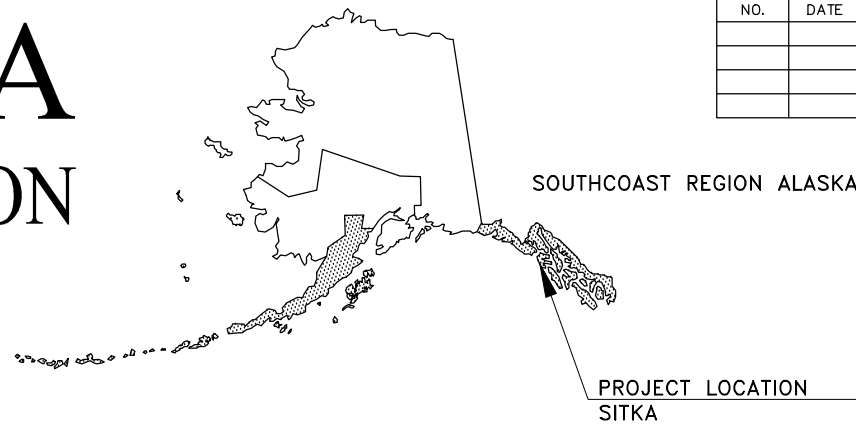

NO.	DATE	REVISIONS	STATE	PROJECT DESIGNATION	YEAR	SHEET NO.	TOTAL SHEETS
			ALASKA	Z681000000/0933042	2017	A1	A1
						PLAN SET TOTAL	11
CDS ROUTE: 295500				MILEPOINT: 0.08 TO 0.42			

### PROPOSED HIGHWAY PROJECT

## SIT SAWMILL CREEK ROAD RESURFACING AND PEDESTRIAN IMPROVEMENTS

### PROJECT NO. NH-0933042/Z681000000

PAVING, PATHWAYS, SIGNING, STRIPING

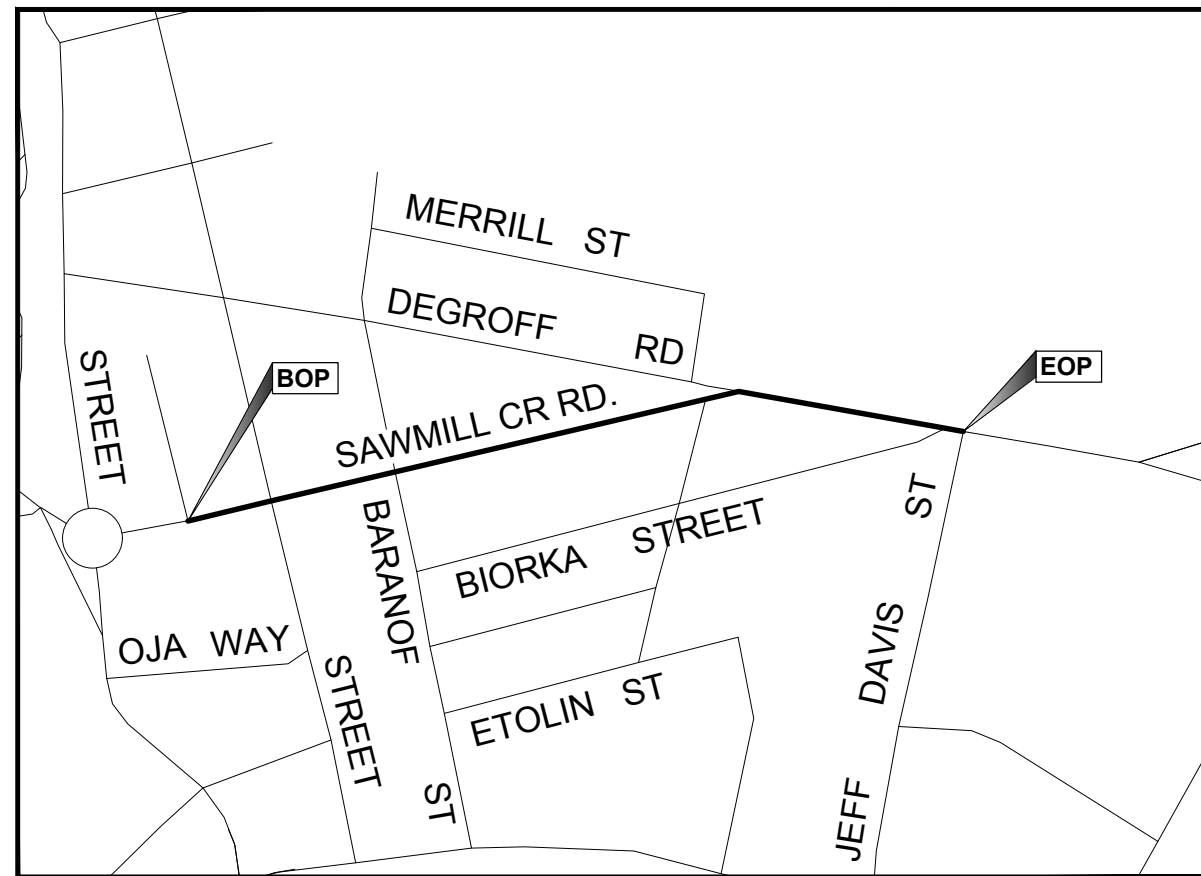

VICINITY MAP

OPTION 2  
PRELIMINARY PLANS

USE THESE PLANS IN CONJUNCTION WITH THE STATE OF ALASKA STANDARD SPECIFICATIONS FOR HIGHWAY CONSTRUCTION, 2017 EDITION AND THE PROJECT SPECIAL PROVISIONS.

STATE OF ALASKA  
DEPARTMENT OF TRANSPORTATION & PUBLIC FACILITIES  
6860 GLACIER HIGHWAY, JUNEAU, AK 99801  
(907) 465-1763

APPROVED:

REGIONAL PRECONSTRUCTION ENGINEER L. PAT CARROLL, P.E. DATE

CONCUR:

REGIONAL DIRECTOR MICHAEL J. COFFEY DATE

DRAFT

FIRM STATE OF ALASKA DEPARTMENT OF TRANSPORTATION & PUBLIC FACILITIES  
 FILE G:\sit\68100\planset\2017 Options\Opt. 2\68100\_F1-F7 Plan\_2017opt. 2.dwg

ADDRESS 6860 GLACIER HWY, JUNEAU, AK 99811  
 DATE 5/4/2017 14:50 LAYOUT F1

PHONE (907) 465-1763  
 DESIGNED CI

CERTIFICATE OF AUTH #:  
 CHECKED

DRAFTED JT

OPTION 2 PLANS

STATE	PROJECT DESIGNATION	YEAR	SHEET NO.	TOTAL SHEETS
ALASKA	Z681000000/0933042	2017	F1	11

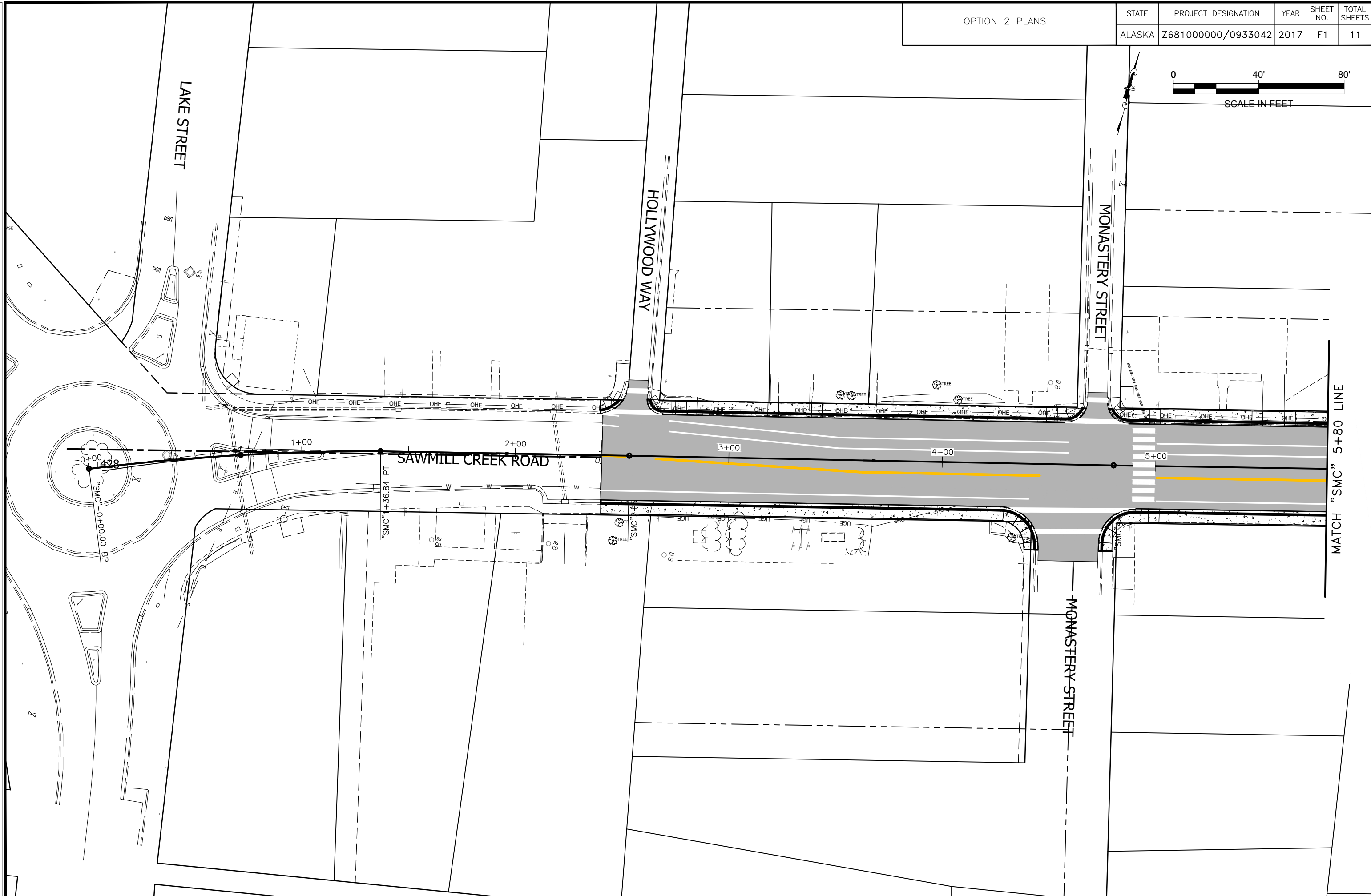
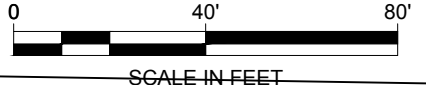

MATCH "SMC" 5+80 LINE

FIRM STATE OF ALASKA DEPARTMENT OF TRANSPORTATION & PUBLIC FACILITIES  
 FILE C:\sit\68100\planset\2017 Options\Opt. 2\68100\_F1-F7 Plan\_2017opt. 2.dwg

ADDRESS 6860 GLACIER HWY, JUNEAU, AK 99811  
 DATE 5/4/2017 14:50 LAYOUT F2

PHONE (907) 465-1763  
 DESIGNED CI

CERTIFICATE OF AUTH #:  
 DRAFTED JT

CHECKED  
 ---

OPTION 2 PLANS

STATE ALASKA

PROJECT DESIGNATION Z681000000/0933042

YEAR 2017

SHEET NO. F2

TOTAL SHEETS 11

MATCH "SMC" 5+80 LINE

MATCH "SMC" 11+90 LINE

BARANOF STREET

BARANOF STREET

6+00

7+00

8+00

9+00

10+00

11+00

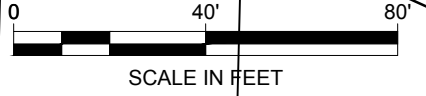

SCALE IN FEET

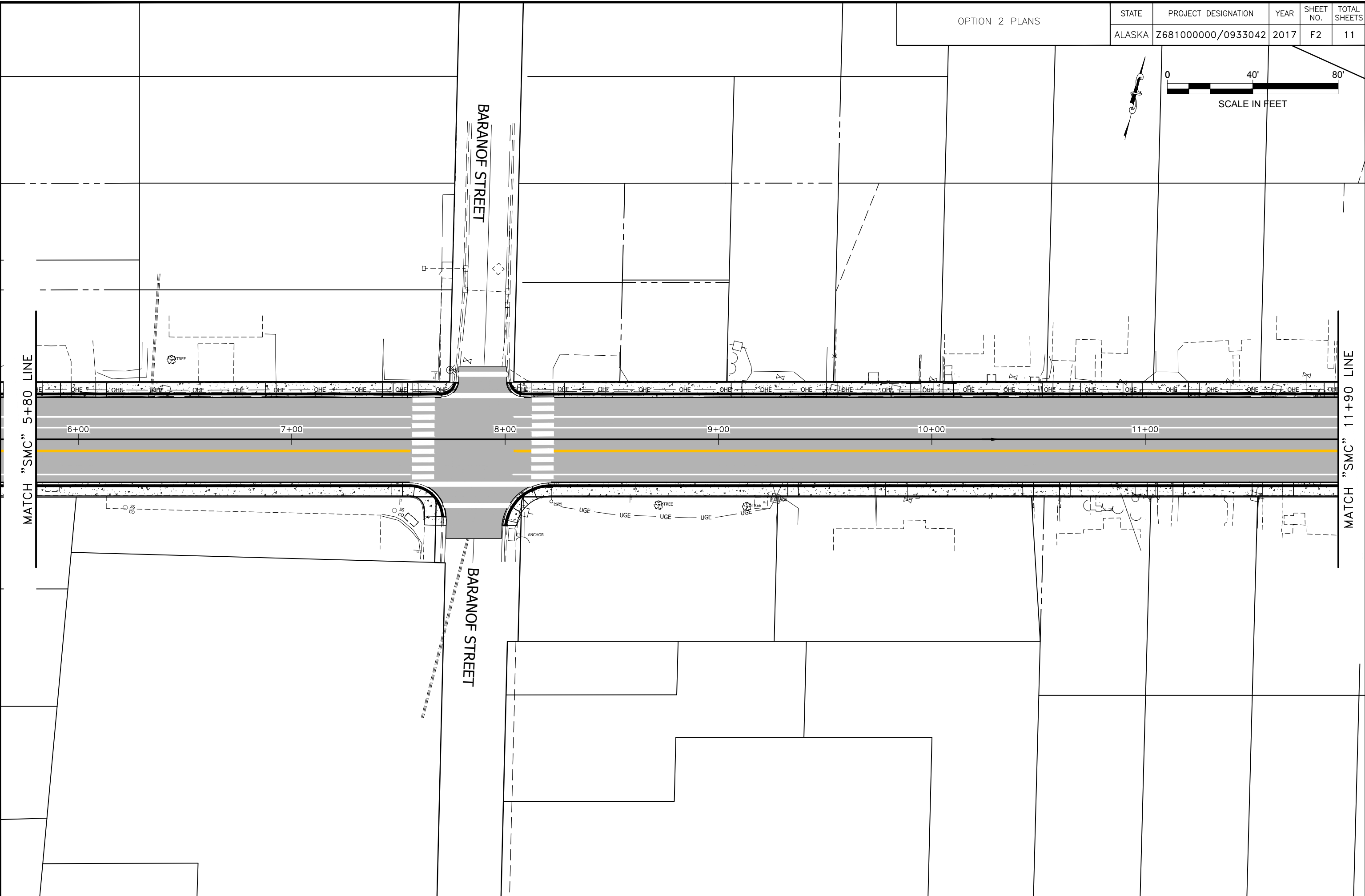

FIRM STATE OF ALASKA DEPARTMENT OF TRANSPORTATION & PUBLIC FACILITIES  
FILE C:\sit\68100\planset\2017 Options\Opt. 2\68100\_F1-F7 Plan\_2017opt. 2.dwg

DATE 5/4/2017 14:50 LAYOUT F3  
ADDRESS 6860 GLACIER HWY, JUNEAU, AK 99811  
PHONE (907) 465-1763 DESIGNED CI  
CERTIFICATE OF AUTH #: DRAFTED JT

OPTION 2 PLANS

STATE	PROJECT DESIGNATION	YEAR	SHEET NO.	TOTAL SHEETS
ALASKA	Z681000000/0933042	2017	F3	11

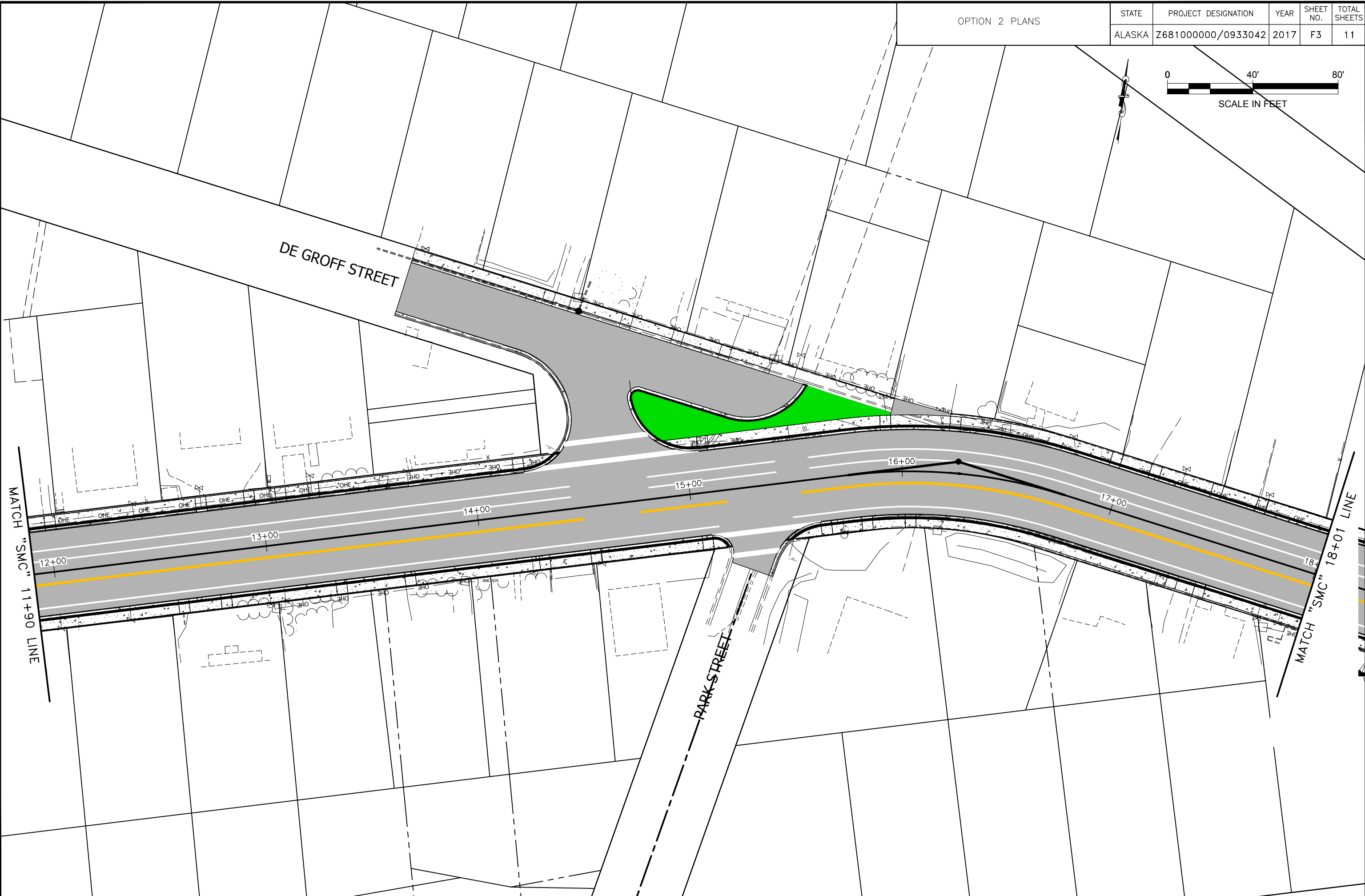
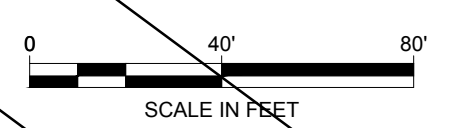

FIRM STATE OF ALASKA DEPARTMENT OF TRANSPORTATION & PUBLIC FACILITIES  
 FILE G:\sit\68100\plans\2017 Options\Opt. 2\68100\_F1-F7 Plan\_2017opt. 2.dwg

ADDRESS 6860 GLACIER HWY, JUNEAU, AK 99811  
 DATE 5/4/2017 14:50 LAYOUT F4

PHONE (907) 465-1763  
 DESIGNED CI

CERTIFICATE OF AUTH #:  
 DRAFTED JT

CHECKED

OPTION 2 PLANS

STATE	PROJECT DESIGNATION	YEAR	SHEET NO.	TOTAL SHEETS
ALASKA	Z681000000/0933042	2017	F4	11

